

SAMSUNG

FINO120 SUPER
MAXIMA ZOOM 120 GLM

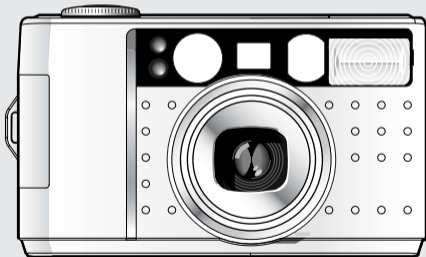

ENGLISH

NOTE

- This camera will not function without a battery.
- Use one 3V lithium battery (CR 2).
- The lens cap automatically opens when the Power button is turned on.
- Do not open the lens cap with your fingers.

The shutter does not operate in the following circumstances:

- When the camera has no battery or when the battery is almost drained.
- When the Power is turned off.(When the lens cap is closed.)
- When the zoom button is operating or when the film is winding or rewinding.
(Rewinding will stop when the power button is pressed during rewinding.)
- When the film remains in the camera after rewinding.
- When the flash is being charged.

※ This camera is controlled electronically by a built-in microcomputer. Although unlikely, it may fail to operate under certain circumstances in which there is a strong electromagnetic field (near a TV, microwave etc.). If this occurs, please remove the lithium battery and replace after 2~3 minutes.

CONTENTS

Thank you for purchasing the SAMSUNG camera. Please read this manual before using your camera.

TABLE OF CONTENTS

PREPARATION

. Part Names	4
. LCD panel	7
. Viewfinder and Indicators	8
. Loading the battery	9
. Checking the battery	10
. Loading the film	11
. Adjusting the diopter	12
. Attaching the strap	12
. Using the camera	13
. Holding the camera	14
. Taking pictures	15
. Buzzer operation	16

TAKING PHOTOS

. Using the focus lock	17
. Rewinding the film	18

. Date imprinting (Q.D. model only)	19
. Using the Flash mode	21
. Auto Red-eye Reduction	22
. Fill-in flash	23
. Flash off	23
. Auto Flash	24
. Using the Shooting mode	25
. Portrait zoom	26
. Self Shooting	27
. Bulb shooting(B Shutter)	28
. Landscape shooting	29
. Continuous shooting	30

IMPORTANT NOTES

. Care and storage	31
. Trouble shooting	32

SPECIFICATIONS

. Checking the camera	35
-----------------------------	----

PART NAMES

· Front / Top

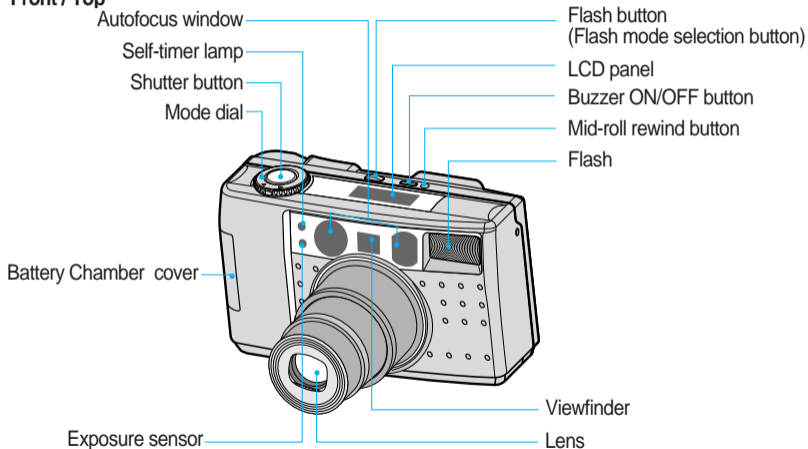

· Rear / Bottom

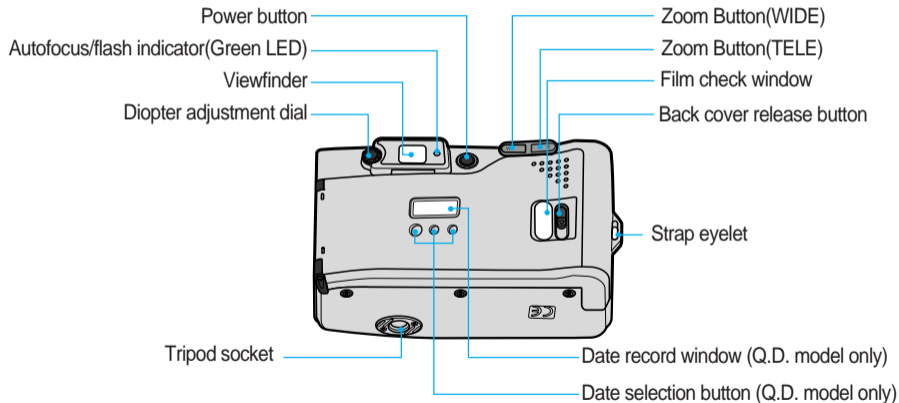

· Interior

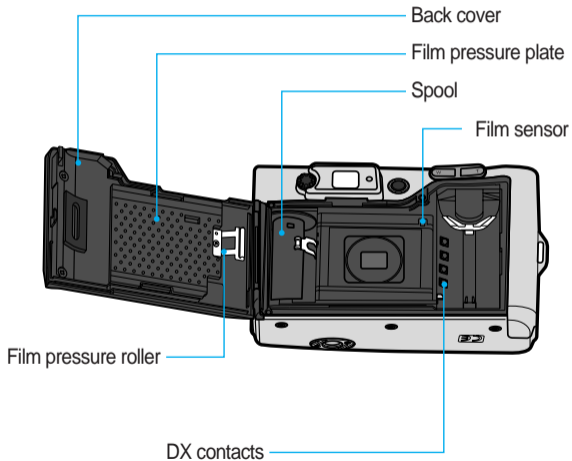

LCD PANEL

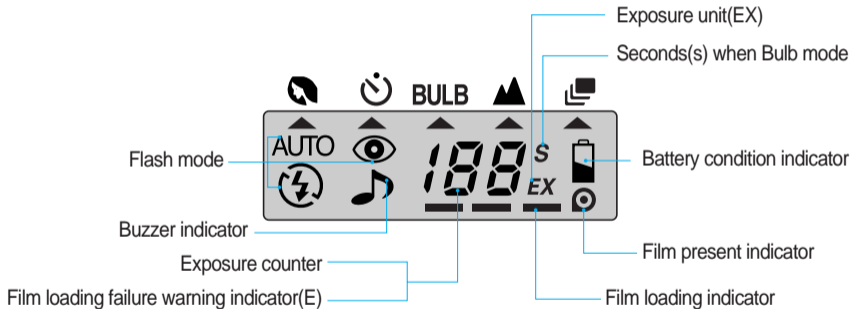

VIEWFINDER AND INDICATORS

Viewfinder

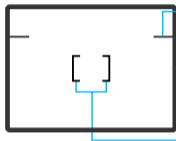

Close range picture area mark

- WIDE : Optimum picture area when shoot within 0.8m~1.5 m
- TELE : Optimum picture area when shoot within 0.86m ~ 3m

Picture area frame

- WIDE : Optimum picture area when shoot over 1.5 m
- TELE : Optimum picture area when shoot over 3m

Autofocus frame (Focus on the subject with this frame)

Indicators

Autofocus Indicator (Green LED)

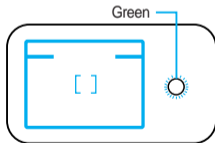

Green

- When illuminated this confirms that conditions are suitable for picture taking.
- When the subject is too close, (within 0.8m (2.62ft)), the LED will blink rapidly and the shutter will lock. (Refer to page 16 for information of buzzer operation)
- Illuminates when the flash is fully charged. (In low light conditions)
- Blinks rapidly when the flash is being charged. (Shutter will be locked)
- Blinks slowly to indicate that the camera requires steady support (preferably a tripod) to avoid camera shake. (Refer to page 16 for information of buzzer operation)

LOADING THE BATTERY

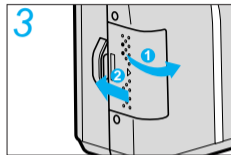
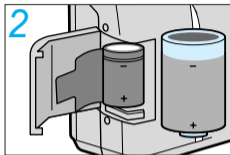
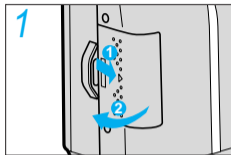



1. Open the chamber cover by sliding the battery chamber cover.
2. Insert a new battery and ensure it is placed in the correct position.
3. Close the chamber cover.

NOTE

- Use one CR 2 battery.
- The camera will automatically turn the power off when not used after 3 minutes. Remove the battery from the camera when the camera is not used for an extended period.
- Be sure to check the date and shooting mode when you load a new battery.
- If the date or time is incorrect, please refer to page 19 and adjust accordingly.

CHECKING THE BATTERY

- You can check the battery life on the LCD panel

	<ol style="list-style-type: none">1. Normal operation<ul style="list-style-type: none">- The battery condition indicator does not appear.
	<ol style="list-style-type: none">2. The indicator appears half way.<ul style="list-style-type: none">- The battery life is low and you should ensure that a replacement battery is available.
	<ol style="list-style-type: none">3. The indicator blinks.<ul style="list-style-type: none">- The battery is exhausted. Load a new battery.

NOTE

- Do not remove the battery while the camera is operating, because it may cause the camera to malfunction.
- Battery performance is reduced in low temperatures (under -10°C (14°F)); Try to keep the camera warm between shots. (The battery will operate normally again when the temperature returns to normal).
- Please dispose of the exhausted battery with care.
- Some local authorities may require batteries to be disposed of separately from other refuse.



LOADING THE FILM

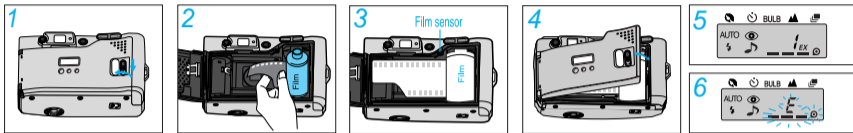

1. Open the back cover by sliding the release knob as shown above.
2. Insert a roll of film in the chamber. Do not force the film into position.
3. The film should lie flat.
4. Close the back cover. It will close with a “click”.
5. The film will automatically advance until the film counter reads “1”.
6. If a film is loaded incorrectly, the LCD panel will display an “E” warning signal. (Refer to page 16 for information of buzzer operation) Reload the film following the steps shown above.

NOTE

- The camera automatically adjusts for ISO 50-3200 DX film.
- When you use non-DX film, the camera will set the film speed at ISO 100.
- Load the film in subdued lighting.

ADJUSTING THE DIOPTER

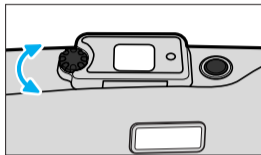

- Select the maximum zoom setting and turn the diopter adjustment dial until the viewfinder display becomes clear.

ATTACHING THE STRAP

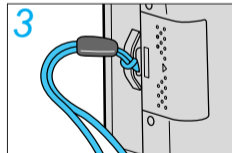
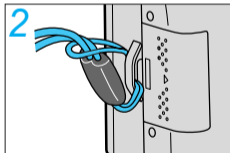
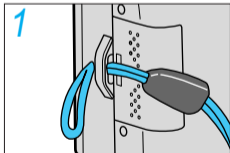

- Refer to the illustrations above.

USING THE CAMERA

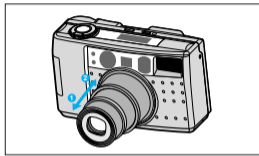
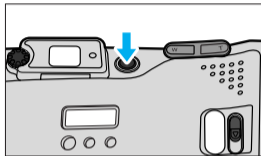

- Press the Power button to turn the power on. The indicators will appear on the LCD panel.
- If the camera is not used for 3 minutes, the power will be turned off automatically.
- While looking through the viewfinder, aim the camera at the subject and operate the zoom buttons.
- Press the “**T**”(Tele) button to move the lens out ① and press the “**W**”(Wide) button to move the lens in ②.

HOLDING THE CAMERA



※ In order to avoid camera shake, hold the camera steady, especially when using longer focal lengths (Tele).

- Place the camera strap over your wrist.
- Both elbows (horizontal picture) or one elbow (vertical picture) should be held close to your body.
- Keep your eye close to the viewfinder when using the camera. This ensures correct framing. Ensure you can see all four sides of the viewing frame when composing your shot.

NOTE

- Avoid obstructing the lens when you take a picture. Pictures can be spoiled when a finger, hair or camera strap falls in front of the Lens, Exposure Sensor or Auto-focus Windows.
- When you take vertical pictures with flash, the flash should be above the lens.

TAKING PICTURES

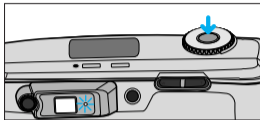

Aim the Autofocus frame at a subject.(Refer to page 8)

- Press the Shutter button half way down. The lens is focused when the green lamp turns on.
- Press the Shutter button all the way down to take a picture.
- The film will automatically advance after shooting and the frame counter will advance.
- Exposure range (WIDE) : 0.8m ~ ∞
(TELE) : 0.86m ~ ∞

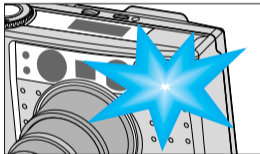

NOTE

- When the flash is being charged, the indicator(Green LED) will be blink rapidly.
- In order to avoid camera shake, hold the camera steadily and press the Shutter button gently, particularly when using longer focal lengths (Tele).
- After taking pictures, turn off the camera. This will protect the lens and prevent unintended shots. (If not used for 3 minutes, the camera will turn off automatically).
- Pressing the shutter button after initiating the wide mode will activate the zoom lens for accurate focusing.

※ In such a case, the power will be turn off with zoom lens move into the camera automatically while the Shutter button is operate. If this occur, please turn the power on and take a picture again.

BUZZER OPERATION

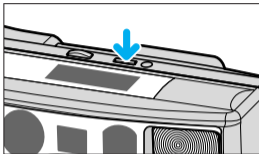

- The buzzer function can be selected by Buzzer ON/OFF button and it will operate only if the buzzer mark appears on the LCD panel.

- According to the function, the buzzer sound is as follows.

Buzzer sound	Function	Application
Peek	Selection	When you press Flash, Buzzer button When Mode Dial is changed
long beeps(4Hz)	Warning	When hand shake is detected
long beeps(8Hz)	Warning	When AF Lock (shorter than minimum shooting range) occurs
long beeps(2Hz)	Warning	When a film is loaded incorrectly When the rewinding is completely finished
short beeps	Warning	In case of shooting beyond the scope of flash range (The function of Auto Flash zoom compensation, Refer to page 21)

USING THE FOCUS LOCK



· If you want to focus on a subject that is not in the centre of your picture, use the Focus Lock function described below.

1. Aim the camera with the autofocus frame superimposed over the subject.
2. Press the shutter button half way down. (Green LED light)
Be careful not to press the shutter button all the way down to avoid taking an unwanted picture.
3. Keeping the shutter button depressed, recompose your picture as desired.
Hold the camera steadily and gently press the shutter button completely down.
The Focus Lock can be released at any time by lifting your finger from the shutter button.

ATTENTION

The Autofocus system of this camera may not function in circumstances below :

- The subject blends into the background.
- The subject is fast moving.
- The subject does not reflect enough light back into the autofocus receiver(e.g.very dark objects).
- The subject is very narrow, either horizontally or vertically(e.g.a lampost).
- There is more than one subject, one near the camera and one some distance away.
- Strong light is directed at the camera. (the subject is back lit).
- Fireworks and smoke.
- Shining or glossy surfaces such as a car body or the surface of water.

In these circumstances, using the Focus Lock feature may help to solve the problem.

REWINDING THE FILM

1. Automatic rewinding

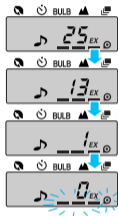

- After taking all the pictures on a roll of film, the camera will automatically rewind the film. The motor stops when the rewinding is completed.
- When the rewinding is completed, the icon () will blink. After 5 seconds the icon will no longer be displayed. You may remove the film at this point. (Refer to page 16 for information of buzzer operation)

2. Mid-roll rewinding

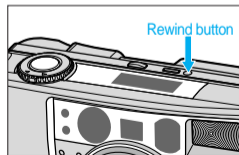

- To rewind the film in the middle of a roll, press the Mid-roll rewind button. The film will be completely rewound, ready for processing. You will not be able to reload the film.

NOTE

- If you press the Power button during film rewinding, the rewinding is interrupted until the Power button is released.
- If the motor stops before the LCD shows "0", replace the battery. Do not open the back cover until the battery is replaced.

DATE IMPRINTING (Q.D. MODEL ONLY)

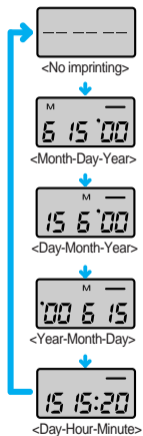

1. Changing Date format

- Press the MODE button in the back cover to select the desired format.

2. Date Zone

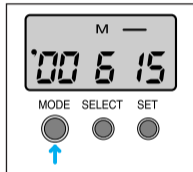

3. Setting the Date

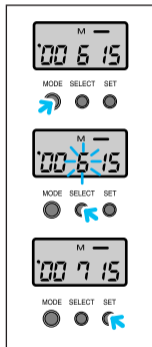

- Select the date mode by pressing the MODE button.
- Press the SELECT button to access a day, month or year.
- Adjust the date or time by pressing the SET button.
(The date will run through quickly if you press the SET button continuously.)

NOTE

- To avoid damage the buttons, do not use a sharp implement.
 - Remember, when changing the battery, you will need to adjust the date.
 - This camera will set the date automatically until 2049.
 - A year mark will be indicated by the last 2 digits on the Date Record Window, which will be printed on the picture.
 - Under these circumstances the camera will operate as normal.
- ※ The 2049 date is subject to change without prior notice.

EXAMPLE

1999 → "99"
2000 → "00"
2001 → "01"

USING THE FLASH MODE

- You can select the flash mode by pressing the FLASH button.
- The Flash Mode Order is subject to change without prior notice.

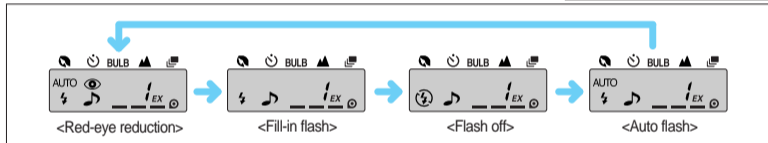
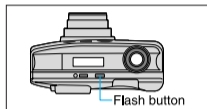

NOTE

- In case of the "Auto Flash" function, the camera will retain the mode even though the camera is turned off. When you turn on the camera, check the LCD panel. (but)When you change the battery, the mode will be set to red-eye reduction.

※ THE FUNCTION OF AUTO FLASH ZOOM COMPENSATION

In some cases, the zoom would change from Tele to Wide when you press the shutter button. The zoom operates automatically to prevent the pictures from getting too dark. (Applicable in Red-Eye Reduction, Fill-in Flash, and Auto Flash).

AUTO AUTO RED-EYE REDUCTION

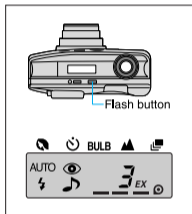

- In low light conditions, the flash will automatically fire to obtain a suitable exposure.
- You can decrease the red-eye phenomenon automatically when taking a portrait picture in low light.



<Auto flash>



<With red-eye reduction>

NOTE

- When you press the shutter button down, the Red-eye reduction lamp will operate and the flash will fire.
- Do not allow the subject to move until the main flash has fired.
- Shooting beyond the scope of the flash range will induce the activation of the buzzer and the zoom lens.

FILL-IN FLASH

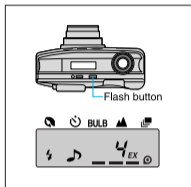

- Select this mode by pressing the FLASH button 1 times.
- When the main subject is in shadow and the surrounding light conditions are too strong for the auto-flash to engage, the fill-in flash allows you to expose the subject correctly.

NOTE

- When using this mode, the flash fires regardless of the brightness of the subject and background.
- Shooting beyond the scope of the flash range will induce the activation of the buzzer and the zoom lens.



FLASH OFF

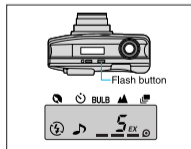

- Select this mode by pressing the FLASH button twice.
- Use this mode when you want to take pictures without flash.

NOTE

- When using the Flash Off function, you may need to use a tripod to avoid camera shake.

AUTO AUTO FLASH

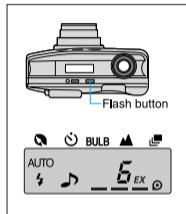

- Select the Auto Mode by pressing the FLASH button 3 times.
- Auto flash mode activates the flash by measuring the brightness of the object.
- Flash will not engage when the shooting object is too bright.

NOTE

- Shooting under poor light might cause the eyes to appear red in the pictures. The red-eye reduction mode will be engaged automatically under poor lighted area.
- Once the Auto Flash Mode is selected, it will remain active even when it is turned off. (but)When you change the battery, the mode will be set to red-eye reduction.
- Shooting beyond the scope of the flash range will induce the activation of the buzzer and the zoom lens.

USING THE SHOOTING MODE

- Select the shooting mode as below by the Mode Dial.

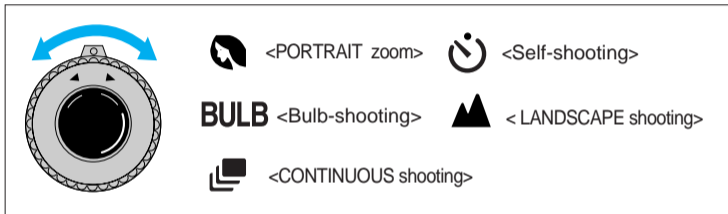

NOTE

- Self-shooting, Landscape-shooting, and Bulb-shooting will return to the default mode after one shutter.

PORTRAIT ZOOM

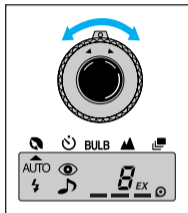

- You can select the Portrait zoom by the Mode Dial.
- Use this mode to maintain a constant subject size within the frame, even though the distance to a subject may vary.
- Position your subject in the centre of the viewfinder and press the shutter button half-way. The zoom will operate automatically to attain the optimum shot.
- Press the shutter button fully to take a picture.



<Normal mode>



<Portrait zoom>

SELF-SHOOTING

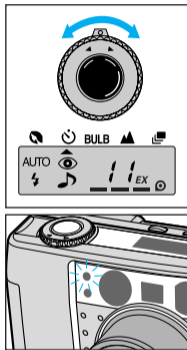

- You can select the Self- shooting by the Mode Dial.
- You can take a picture of yourself by using this mode.
- When pressing the shutter button, the self-timer lamp illuminate for 7 seconds. Then the lamp blinks rapidly for 3 seconds and the picture is taken.



BULB BULB SHOOTING (B SHUTTER)

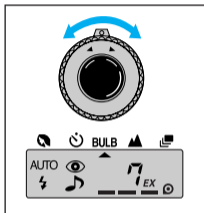

- You can select the Bulb shooting by the Mode Dial.
- Use this mode to shoot subjects that require an extended shutter speed such as fireworks and night scenes.
- The shutter remains open as long as the shutter button is depressed. The time selected is shown on the LCD panel and the maximum time is 60 seconds.

NOTE

- Use this mode only in low light.
- To avoid camera shake, use a tripod.



▲ LANDSCAPE SHOOTING

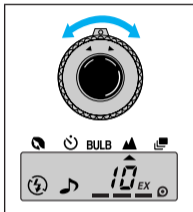

- You can select the Landscape shooting by the Mode Dial.
- Use this mode to photograph distant subjects through a window.

NOTE

- With this mode, the flash does not fire.
- Use a tripod to avoid camera shake in low light conditions.



<Without Landscape mode>



<With Landscape mode>

CONTINUOUS SHOOTING

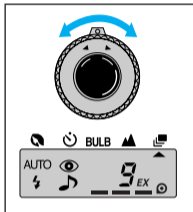

- You can select the Continuous shooting by the Mode Dial.
- Use this mode to take a sequence of pictures.
- As long as you press the shutter button, the camera will continue to take pictures.

NOTE

- If flash is required, the time between shots will be increased due to the flash recycling.
- The flash does not fire if no film is loaded (except for "Fill-in Flash" mode).



CARE AND STORAGE

- If your camera needs cleaning, wipe it with a soft, lintless cloth.
 - The lens should be cleaned only with special lens cleaning tissue and fluid.(Consult your camera retailer.)
 - Do not allow your camera to come into contact with sand or water.
 - Keep your camera in a dry, cool place that is free from high humidity and dust.
 - Never leave your camera in hot places such as a parked car, or direct sunlight.
- Avoid sudden shocks or vibration. If you drop your camera, it is a good idea to have it checked before using it.

Warning

- Do not try to disassemble the camera yourself.
Your camera contains high voltage circuitry and may cause injury if interfered with.
 - The temperature range in which the camera operates is between 50 °C and -10 °C (122°F~14°F).
 - The camera performance may be impaired when used in very cold weather. If you plan to take pictures when the temperature is below 7 °C(45 °F), take care to keep your camera and battery warm between shots. If your camera becomes very cold, allow it to return to room temperature slowly by keeping it in its case. Condensation can spoil pictures and in extreme conditions can damage the electronic components inside the camera.
- ※ If you have trouble with your camera, please return it to your retailer for advice.

TROUBLE SHOOTING

· If the shutter does not operate after pressing the shutter button.

Check point	Remedy	Page
Is the lens cover completely open?	Press the Power button again.	13
Is the battery loaded correctly?	Reinsert correctly.	9
Has it been a long time since you used the camera?	Change the battery.	10

· If a picture is partially dark or out of focus.

Check point	Remedy	Page
Was the lens or other sensors obstructed by your fingers or hair ?	Be careful not to block the lens or the exposure sensor.	14
Did you compose a subject correctly referring to the picture area frame?	Read the "Viewfinder and Indicators"	8

SPECIFICATIONS

TYPE	35mm fully automatic lens shutter camera.	
FILM	Format	35mm DX-coded film, 24x36mm
	Speed	Automatic setting with DX-coded film, ISO 50~3200
	Loading	Automatic advance to the first frame when the back cover is closed.
	Winding	Automatic advance, Single or Continuous shooting
	Rewinding	Automatic rewinding, Mid-roll rewinding
LENS	Samsung SHD lens, F4.5 ~ 13.1 / 38 ~ 120mm 7 elements 6 groups	
SHUTTER	Programmed AE electronic focusing Shutter speed : 1/3 ~ 1/400 sec. Bulb mode(B shutter) : 60 ~ 1 sec.	
EXPOSURE	Programmed auto exposure AE coupling range (ISO 100 film) · WIDE(38mm) : EV 6.9 ~ 17 · TELE(120mm) : EV 9.8 ~ 17	
VIEWFINDER	Real image type with autofocus frame Field of view : over 80% Magnification : 0.46 ~ 1.24 Picture area frame mark	

FLASH	Type	Built-in electronic flash			
	Range	ISO	100	200	400
		38mm(WIDE)	0.8~4.6m/2.6~15.1ft	0.8~6.5m/2.6~21.3ft	0.8~9.3m/2.6~30.5ft
		120mm(TELE)	0.86~1.7m/2.8~5.6ft	0.86~2.5m/2.8~8.2ft	0.86~3.5m/2.8~11.5ft
Recycling time	Approx. 7 sec.				
SPECIAL FEATURES	Shooting mode	· PORTRAIT zoom · SELF shooting · Bulb shooting(B Shutter) · LANDSCAPE shooting ; WIDE(38mm):5.0m~ ∞(16.4ft~ ∞), TELE(120mm):9.6m~ ∞(31.5ft~ ∞) · CONTINUOUS shooting			
	Flash mode	· Red-eye reduction · Fill-in flash · Flash off · Auto Flash			
DATE IMPRINTING (Q.D.model only)		Date or Time setting - 5 different formats (The camera will set the date automatically until 2049.)			
POWER SOURCE		One 3V lithium battery (CR 2)			
DIMENSIONS(WxHxD)		109 x 64 x 43mm / 4.29 x 2.52 x 1.69in			
WEIGHT		205g / 7.23oz (without battery)			

- Specifications are subject to change without prior notice.
- All data are based on SAMSUNG'S standard test methods.

CHECKING THE CAMERA

●Checking the shutter condition

- You can check the condition of the shutter by pressing it.
The short “click” sound will result.

●Checking the irises

- After removing the back cover of a camera, it is normal to see the closed lens opening up when you press the shutter.
- The irises will adjust depending on the light condition.
Dark light will cause them to open wide; bright light will cause the narrowing of the irises.

- If the irises were opened before pressing the shutter or cannot be opened, the irises are not operating properly.

●Film transferring device

- It is normal to hear the motor running after you open and close the camera cover.
- It is normal to hear the motor running after you press the Mid-roll rewinding button.
- After examining the Mid-roll rewinding condition, set the camera to the default state and check other functions.

●Flash Activation

- Check the Auto Flash Mode indoors.

- ※ It is important to check your camera prior to up-coming event to prevent possible psychological and monetary damage once the camera is not working properly at the day of the event.

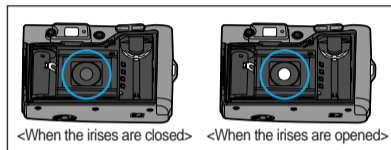



SAMSUNG

SAMSUNG TECHWIN CO., LTD.
OPTICS & DIGITAL IMAGING DIVISION
145-3, SANGDAEWON 1-DONG,
JUNGWON-GU, SUNGNAM-CITY,
KYUNGKI-DO, KOREA 462-121
TEL : (82) 31-740-8086,8088, 8090,
8092, 8099
FAX : (82) 31-740-8398, 8399

SAMSUNG OPTO-ELECTRONICS AMERICA, INC.
HEADQUARTERS
40 SEAVIEW DRIVES, SECAUCUS, NJ07094
TEL : (1) 201-902-0347
FAX : (1) 201-902-9342
WESTERN REGIONAL OFFICE
18600 BROADWICK ST.,
RANCHO DOMINGUEZ, CA 90220
TEL : (1) 310-537-7000
FAX : (1) 310-537-1566

SAMSUNG U.K. LTD.
PHOTO PRODUCTS DIV.
SAMSUNG HOUSE, 3 RIVERBANK WAY,
GREAT WEST ROAD, BRENTFORD,
MIDDLESEX, TW8 9RE, U.K.
TEL : (44) 181-232-3278
FAX : (44) 181-569-8385

SAMSUNG DEUTSCHLAND GmbH
SAMSUNG HAUS
AM KRONBERGER HANG 6, 65824 SCHWALBACH,
GERMANY
TEL : (49) 61-96-66 53 01
FAX : (49) 61-96-66 53 33

SAMSUNG FRANCE S.A.R.L.
BP. 51 TOUR MAINE-MONTPARNASSE 33,
AV DU MAINE 75755,
PARIS CEDEX 15, FRANCE
TEL : (33) 1-4279-2283
FAX : (33) 1-4320-4510

S.MARKET COM.IMP.EXP.LTDA
RUA ALFERES MAGALHÃES, 92 CONJUNTO 71 SANTANA
SÃO PAULO-SP BRAZIL 02034-000
TEL/FAX : (55) 11-6221-6833

SAMSUNG TECHWIN MOSCOW OFFICE
KOSMODAMIANSKAYA NABEREZNAYA 40/42,
MOSCOW, 113035, RUSSIA
TEL/FAX : (7) 095-937-79-50

SAMSUNG AUSTRALIA PTY. LTD.
LEVEL 33, NORTHPOINT BLDG, 100 MILLER
STREET, NORTH SYDNEY,
NSW 2060, AUSTRALIA
TEL : (61) 2-9955-3888
FAX : (61) 2-9955-4233

TIANJIN SAMSUNG OPTO-ELECTRONICS CO.,LTD.
7 PINGCHANG ROAD NANKAI DIST. TIANJIN
P.R CHINA
POST CODE:300190
TEL : (86)22-2761-4599
FAX : (86)22-2761-3314

* Internet address - <http://www.samsungcamera.com/>



The CE Mark is a Directive conformity
mark of the European Community (EC)

6806 - 1022