

aiwa

CD Stereo System

XR-EM20

U C

COMPACT
disc
DIGITAL AUDIO

Owner's record

For your convenience, record the model number and serial number (you will find them on the rear of your set) in the space provided below. Please refer to them when you contact your Aiwa dealer in case of difficulty.

Model No.	Serial No. (Lot No.)

For assistance and information

call toll free 1-800-BUY-AIWA

(United States and Puerto Rico)

8C-CL7-903-01
011228ACK-H-BF

OPERATING INSTRUCTIONS

En (English)

MANUAL DE INSTRUCCIONES

E (Español)

MODE D'EMPLOI

F (Français)

WARNING

To reduce the risk of fire or electric shock, do not expose this appliance to rain or moisture.

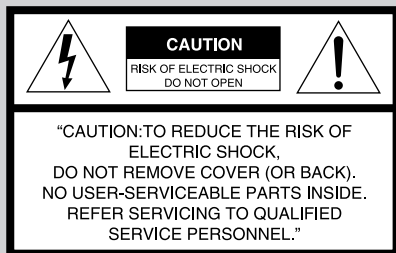
**Explanation of Graphical Symbols:**

The lightning flash with arrowhead symbol, within an equilateral triangle, is intended to alert the user to the presence of uninsulated "dangerous voltage" within the product's enclosure that may be of sufficient magnitude to constitute a risk of electric shock to persons.



The exclamation point within an equilateral triangle is intended to alert the user to the presence of important operating and maintenance (servicing) instructions in the literature accompanying the appliance.

IMPORTANT SAFETY INSTRUCTIONS

Read the Operating Instructions carefully and completely before operating the unit. Be sure to keep the Operating Instructions for future reference. All warnings and cautions in the Operating Instructions and on the unit should be strictly followed, as well as the safety suggestions below.

Warning

To prevent electric shock or injury, these safety instructions should be followed in the installation, use and servicing the unit.

Installation

Attachments - Do not use attachments not recommended by the unit manufacturer as they may result in the risk of fire, electric shock or injury to persons.

Water and Moisture - Do not use this unit near water - for example, near a bathtub, washbowl, kitchen sink, or laundry tub, in a wet basement, or near a swimming pool, and the like.

Heat - Do not use this unit near sources of heat, including heating vents, stoves, or other appliances that generate heat. It also should not be placed in temperatures less than 5°C (41°F) or greater than 35°C (95°F).

Mounting surface - Place the unit on a flat, even surface.

Accessories - Do not place this unit on an unstable cart, stand, tripod, bracket, or table. The unit may fall, causing serious injury to a child or an adult, and serious damage to the appliance. Use only with a cart, stand, tripod, bracket, or table recommended by the manufacturer, or sold with the unit. Any mounting of the appliance should follow the manufacturer's instructions, and should use a mounting accessory recommended by the manufacturer.

Portable cart - An appliance and cart combination should be moved with care. Quick stops, excessive force, and uneven surfaces may cause the appliance and cart combination to overturn.



Ventilation - The unit should be situated with adequate space around it so that proper heat ventilation is assured. Allow 10 cm clearance from the rear and the top of the unit, and 5 cm from the each side.

Slots and openings in the cabinet and the back or bottom are provided for ventilation, and to ensure reliable operation of the unit and to protect it from overheating, these openings must not be blocked or covered. The openings should never be blocked by placing the unit on a bed, sofa, rug or other similar surface. This unit should not be placed in a built-in installation such as a bookcase unless proper ventilation is provided.

Object and Liquid Entry - Never push objects of any kind into this unit through the cabinet slots as they may touch dangerous voltage points or short-circuit parts that could result in a fire or electric shock. Never spill liquid of any kind on the unit.

Electric Power

Power Sources - This unit should be operated only from the type of power source indicated on the marking label. If you are not sure of the type of power supply to your home, consult your appliance dealer or local power company. To operate unit on battery power, or other sources, refer to the operating instructions.

Grounding or Polarization - This unit is provided with a polarized alternating-current line plug (a plug having one blade wider than the other). This plug will fit into the power outlet only one way. This is a safety feature. If you are unable to insert the plug fully into the outlet, try reversing the plug. If the plug should still fail to fit, contact your electrician to replace your obsolete outlet. Do not defeat the safety purpose of the polarized plug.

Power-Cord Protection - Power-supply cords should be routed so that they are not likely to be walked on or pinched by items placed upon or against them, paying particular attention to cords at plugs, convenience receptacles, and the point where they exit from the product.

Overloading - Do not overload wall outlets, extension cords, integral convenience receptacles as this can result in a risk of fire or electric shock.

Outdoor Antenna

Power lines - An outside antenna system should not be located in the vicinity of overhead power lines or other electric light or power circuits, or where it can fall into such power lines or circuits. When installing an outside antenna system, extreme care should be taken to keep from touching such power lines or circuits as contact with them might be fatal.

Outdoor Antenna Grounding - If an outside antenna or cable system is connected to the unit, be sure the antenna or cable system is grounded so as to provide some protection against voltage surges and built-up static charges. Section 810 of the National Electrical Code, ANSI/NFPA No.70, provides information with regard to proper grounding of the mast and supporting structure, grounding of the lead-in wire to an antenna discharge unit, size of grounding conductors, location of antenna-discharge unit, connection to grounding electrodes, and requirements for the grounding electrode. See the figure.

Antenna Grounding According to the National Electrical Code

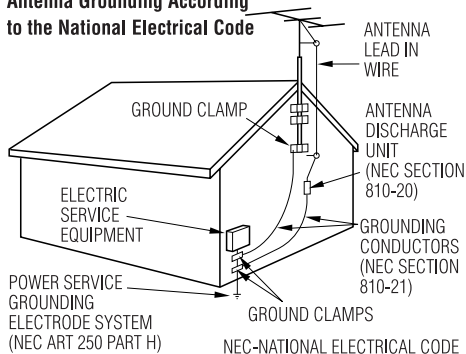

Lightning

For added protection for this unit receiver during a lightning storm, or when it is left unattended and unused for long periods of time, unplug it from the wall outlet and disconnect the antenna or cable system. This will prevent damage to the unit due to lightning and powerline surges.

Maintenance

Cleaning - Unplug this unit from the wall outlet before cleaning. Do not use liquid cleaners or aerosol cleaners. Use a damp cloth for cleaning.

Damage Requiring Service

Unplug this unit from the wall outlet and refer servicing to qualified service personnel under the following conditions:

- 1) When the power cord or plug is damaged.
- 2) If liquid has been spilled, or objects have fallen into the unit.
- 3) If the unit has been exposed to rain or water.
- 4) If the unit does not operate normally by following the operating instructions. Adjust only those controls that are covered by the operating instructions as improper adjustment of other controls may result in damage and will often require extensive work by a qualified technician to restore the unit to normal operation.
- 5) If the unit has been dropped or the cabinet has been damaged.
- 6) When the unit exhibits a distinct change in performance - this indicates a need for service.

Do not attempt to service this unit yourself as opening or removing covers may expose you to dangerous voltage or other hazards. Refer all servicing to qualified service personnel.

Replacement Parts - When replacement parts are required, be sure the service technician has used replacement parts specified by the manufacturer or having the same characteristics as the original part. Unauthorized substitutions may result in fire, electric shock or other hazards.

Safety Check - Upon the completion of any service or repairs to this unit, ask the service technician to perform safety checks to determine that the unit is in proper operating condition.

TABLE OF CONTENTS

IMPORTANT SAFETY INSTRUCTIONS	2
PREPARATIONS	4
PARTS AND CONTROLS	5
ADJUSTMENTS BEFORE OPERATION	7
CD OPERATIONS	8
RADIO OPERATIONS	10
SOUND ADJUSTMENTS	11
TAPE PLAYBACK	12
TAPE RECORDING	13
TIMER OPERATIONS	16
REFERENCE	18

System and accessories

Main unit CX-LEM20
Speakers SX-LEM20

Remote control
FM antenna
AM antenna

PREPARATIONS

Connection

Plug in the AC power cord to the AC outlet after all other connections are made.

- 1 Connect the speakers to the main unit.
Connect the right speaker to the SPEAKERS R terminals and the left to the SPEAKERS L terminals. The speaker cords with the stripes go to the \oplus terminals.

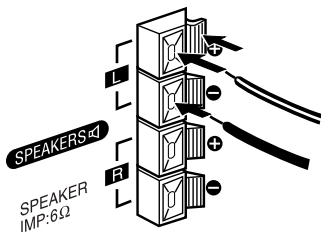

- 2 Connect the supplied antennas.
Connect the FM antenna to the FM 75 Ω terminals and the AM antenna to the AM LOOP jack. Connect the FM antenna to the FM 75 Ω terminals without the ∇ mark, as illustrated.

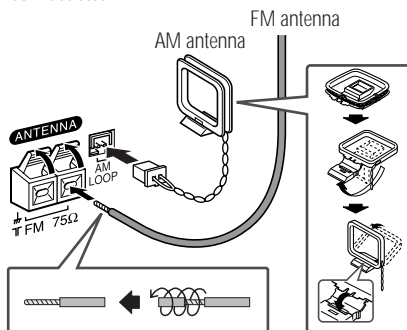

- 3 Connect the AC power cord to an AC outlet.
The clock will flash on the display.
For setting the clock, see page 7.

Speakers

- Do not short-circuit the \oplus and \ominus speaker cord leads.
- Do not leave objects generating magnetism or objects affected by magnetism near the speakers.

Antennas

Keep antennas away from metallic objects, electrical equipment and cords.

- **FM antenna:** Extend fully and position for the best reception. If reception is poor, connect an optional outdoor antenna to the FM 75 Ω terminals. When connecting an optional outdoor antenna, be sure to connect the shield braid of the antenna to the ∇ terminal.
- **AM antenna:** Rotate to find best reception.

Remote control

Detach the battery compartment lid at the rear of the remote control and insert two R6 (size AA) batteries with correct polarity.

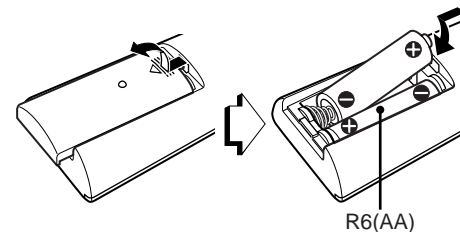

- Replace the batteries with new ones when the operational distance between the remote control and main unit becomes shorter.
- Remove the batteries if the unit is not going to be used for an extended period of time.
- The remote control may not operate if it is used under intense sunlight or if its line of sight is obstructed.

PARTS AND CONTROLS

Main unit

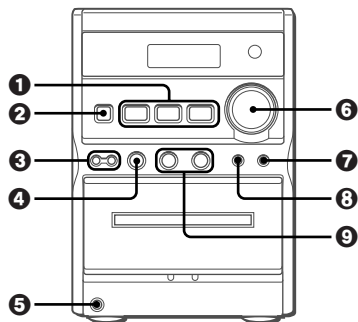

1 ▶ TAPE (REC MUTE)

Starts playback.
Also used to enter 4-second blank spaces during recording.

TUNER/AUX/BAND

Selects Radio function and the radio band.
Also selects the function of external equipment connected to AUX IN jacks.

▶||CD

Starts and pauses CD play.

2 POWER ⏻/STANDBY/ON

Switches the unit on and off (standby).

3 REC/REC PAUSE

Starts and pauses recording.

SYNCHRO REC

Starts recording and CD play simultaneously.

4 ■ CLEAR

CD and Tape: stops playback.
Radio: clears a preset station.

5 PHONES jack

Plug in optional headphones set with a stereo mini plug (ø3.5 mm). Speaker output is canceled.

6 VOLUME

Adjusts the volume etc..

7 TONE

Selects the sound adjusting mode, "BAS" (bass) or "TRE" (treble).

8 DISPLAY

Changes the display in CD playback mode.

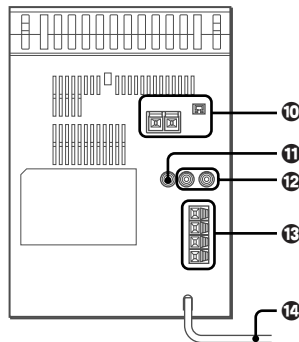

9 ◀◀/|◀, ▶▶/▶▶ (TUNING DOWN, UP)

CD: skips to a previous or a succeeding track when pressed, searches a track in fast forward or reverse playback when held down.
Tape: rewinds or fast forwards the tape.

Radio: manually tunes up or down within the band.

10 AM LOOP jack and FM 75 Ω terminals

Connect the supplied AM and FM antennas.

11 SUB WOOFER jack

Connect optional powered sub woofer with a built-in amplifier to the jack.

12 AUX IN jacks

Accept analog sound signals from external equipment.
Connect external equipment using an optional connecting cable with RCA phono plugs (red plug to R jack, white plug to L jack). Refer also to the operating instructions for your equipment.
To switch function to external input, press TUNER/AUX/BAND repeatedly.

13 SPEAKERS terminals

Connect the speaker cords of the supplied speakers.

14 AC power cord

En

Remote control

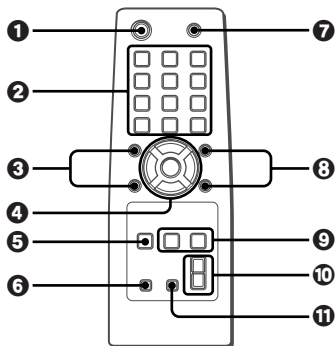

Buttons with the same or similar names on the main unit basically have the same function.

❶ POWER

❷ 0-10, +10

CD: selects a track of the specified number.

Radio: tunes in the station with the specified preset number.

The numbered buttons take on these functions when pressed with SHIFT held down:

CLOCK

Selects clock mode.

TUNER MODE

Switches between stereo or monaural FM reception.

DISPLAY

PROGRAM

Selects programmed CD playback mode.

TIMER

Selects timer mode.

SLEEP

Selects sleep-timer mode.

RANDOM/REP

Selects random or repeat CD playback mode.

CD EDIT/CHECK

Selects edited CD recording.

❸ REC/REC PAUSE

Starts and pauses recording when pressed with SHIFT held down.

REC MUTE

Enters 4-second blank spaces during recording.

❹ ►|| CD

AUX

Select the function of external equipment connected to AUX IN jacks.

►TAPE

TUNER/BAND

Selects Radio function and the radio band.

■ CLEAR

❺ SET

Determines the mode.

Stores the received station to preset.

❻ SHIFT

Hold down when pressing a numbered button to change its function to that printed above the number.

❼ FUNCTION

Switches the active function among TAPE, TUNER, AUX and CD.

❽ PRESET +, -

Tunes in a preset station.

❾ ◀◀/|◀◀, ▶▶/|▶▶

❿ VOLUME +, -

⓫ TONE

ADJUSTMENTS BEFORE OPERATION

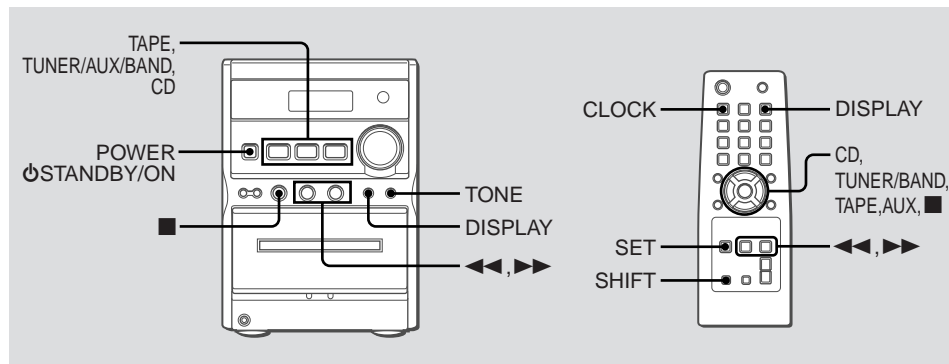

Power

Turning the unit on

Press POWER ⏻ STANDBY/ON (POWER on the remote control).

Alternatively, press TAPE, TUNER/AUX/BAND (TUNER/BAND or AUX on the remote control) or CD. Playback will start automatically if a disc or tape is loaded.

Turning the unit off

Press POWER ⏻ STANDBY/ON again.
The unit goes into standby.

To change the display window brightness (Dimmer)

Hold down DISPLAY (hold down SHIFT and press DISPLAY on the remote control) for about 4 seconds while the power is on.

Repeat the above to restore the brightness.

Setting the clock

- 1 Hold down SHIFT and press CLOCK on the remote control.
When the unit is turned off, you can also press SET.
- 2 Within 6 seconds, press ◀◀ or ▶▶ to set the time.
Each press changes the time in 1-minute steps.
Holding these buttons down will vary the time in 10-minute units.
- 3 Press SET.
The time display stops flashing and the clock starts from 00 seconds.

When setting the clock on the unit in stop mode, hold down ■ and press ▶▶ in step 1. After setting the time in step 2, press TONE in step 3.

To display the time while the power is on

Hold down SHIFT and press CLOCK on the remote control. The time will be displayed for 6 seconds.

To switch to the 24-hour standard

Display the time and press ■ within 6 seconds.
With each press, the clock alternates between 12- and 24-hour standard time.

Tip:

In the 12-hour standard, "AM12:00" indicates midnight and "PM12:00" noon.

If the clock display flashes when the unit is turned off

There has been a power interruption. Reset the clock.

CD OPERATIONS

En

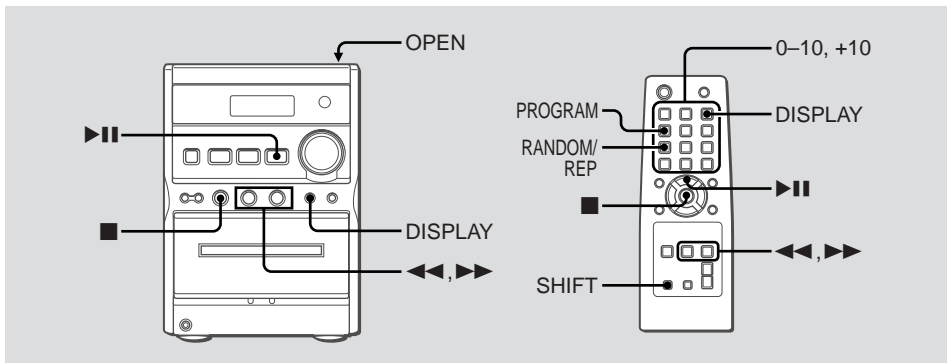

This unit plays back finalized CD-R/RW discs as well as audio CDs.

Playing a CD

- 1 Press OPEN to open the disc compartment. Place a disc with the label side up. Then close the disc compartment by pressing OPEN.
- 2 Press ►► to start play.

To stop play

Press ■.

To pause play

Press ►►. Press again to resume play.

To skip to the beginning of the current/preceding/succeeding track

Press ◀◀ or ▶▶ repeatedly.

To search (playback in fast forward or reverse)

Hold down ◀◀ or ▶▶. Release at the desired point.

To select a track with the remote control (Direct play)

- Press the numbered buttons to select a track.
- To select the 25th track, press +10, +10 and 5.
 - To select the 11th track, press +10 and 1.

To change the display in playback mode

Press DISPLAY (hold down SHIFT and press DISPLAY on the remote control) during play.

The display changes in the following order:

- ▶ Track number being played and elapsed playing time
- └ Remaining time of play
- Remaining time of play cannot be displayed during ◀ 1, random or programmed play.

Random/Repeat play

In random play mode the unit plays all the tracks in random order. In repeat play mode it plays repeatedly all the tracks or the track being played. You can select random and repeat all play at the same time.

- 1 Hold down SHIFT and press RANDOM/REP repeatedly on the remote control. The mode changes as follows:
 - "◀ 1": Plays one track repeatedly. Select the track with ◀◀ or ▶▶.
 - "▶": Plays all the tracks repeatedly.
 - "RANDOM": Plays all the tracks randomly.
 - "RANDOM ▶": Plays all the tracks repeatedly in random order.
- 2 Press ►► to start play.

To cancel random/repeat play

Hold down SHIFT and press RANDOM/REP on the remote control repeatedly until "RANDOM" or "◀ 1" disappears. Direct selection of the tracks with the numbered buttons cancels random play mode.

To repeat a selected set of tracks

First select the tracks with programmed play (see "Programmed play" on page 9). Then select repeat playback.

Programmed play

Plays back up to 30 selected tracks in programmed order.

- 1 Hold down SHIFT and press PROGRAM on the remote control in stop mode.
"PRGM" flashes on the display.
 - 2 Press the numbered buttons on the remote control to program a track.
 - To select the 25th track, press +10, +10 and 5.
 - To select the 11th track, press +10 and 1.The selected track number lights up on the display.
 - 3 Repeat step 2 to program other tracks.
The total number of selected tracks and total playing time will be displayed.
 - 4 Press ►|| to start play.
The track number for the current track flashes on the display.
- During programmed play, you cannot select a track with the numbered buttons. "CAN'T USE" is displayed when you try to select a track .
 - If the total playing time of the program exceeds 99 minutes and 59 seconds, or if a track with a track number exceeding 30 is programmed, the playing time is displayed as "- :- -".
 - You cannot program more than 30 tracks. "FULL" is displayed.

To check the program

Press ◀◀ or ▶▶ repeatedly in stop mode. The track number and program number are displayed in succession.

To clear the program

Press ■ in stop mode. "PRGM" disappears from the display.

To add tracks to the program

Repeat step 2 before starting playback. The tracks are added to the end of the program.

To change the programmed tracks

Clear the program and repeat all the steps again.

Notes on CDs

- Do not place more than one disc.
- Do not tilt the unit with a disc loaded.
- The unit may not play CD-R/RW discs recorded on personal computers or certain kinds of CD-R/RW recorders.
- Do not attach adhesive label to either side of CD-R/RW discs, as doing so may cause malfunction.
- Do not load an unrecorded CD-R/RW disc. The disc may be damaged.
- Do not use irregular-shaped CDs.

RADIO OPERATIONS

En

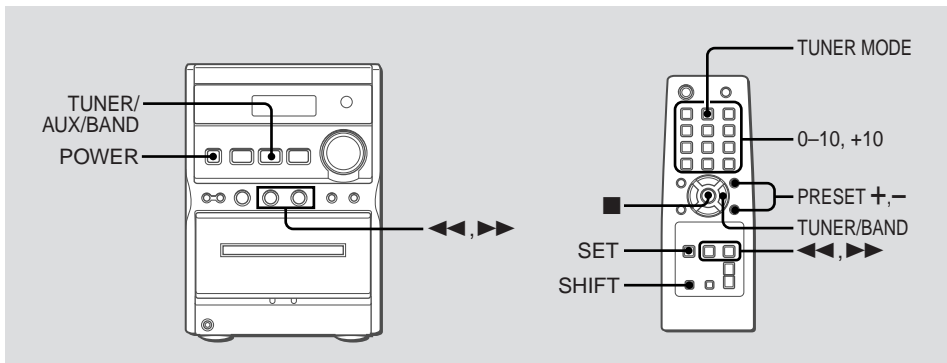

Manual tuning

- 1 Press TUNER/AUX/BAND (TUNER/BAND on the remote control) repeatedly to select a band.
- 2 Press ◀◀ or ▶▶ repeatedly to tune in a station. "TUNE" is displayed when a station is tuned in. "(((FM)))" is displayed for FM stereo reception.

To search for a station automatically (Auto search)

Hold down ◀◀ or ▶▶.

The unit searches for a station and stops at reception.

To stop the search manually, press ◀◀ or ▶▶.

- Auto search may not stop at stations with weak signals.

Preset tuning

Preset up to 32 of your favourite stations and tune them in directly.

Presetting stations

- 1 Tune in the desired station.
 - 2 Press SET on the remote control to store the station. The preset number, beginning from "1" flashes on the display.
 - 3 Repeat steps 1 and 2 to preset other stations. The next station will not be stored if a total of 32 preset stations have already been stored. ("FULL" is displayed.)
- If power is interrupted for more than approximately 12 hours, all settings stored in memory after purchase need to be reset.

Tuning in preset stations

- 1 Select the band.
- 2 Press PRESET +, - on the remote control repeatedly. With each press, the station with the succeeding or preceding preset number is tuned in. You can tune in the desired preset station directly by pressing the numbered buttons on the remote control.
 - To select preset number 11, press +10 and 1.
 - To select preset number 15, press +10 and 5.

To clear a preset station

- 1 Tune in the station by preset tuning.
- 2 Press ■, then press SET on the remote control within 6 seconds. Preset station numbers in the band which are higher than the cleared number decrease by one.

SOUND ADJUSTMENTS

Adjustments

To switch to monaural FM reception

Hold down SHIFT and press TUNER MODE on the remote control so that "MONO" is displayed.

To cancel, repeat the above so that "STEREO" is displayed.

Tip:

When FM stereo reception is poor, switching to monaural reduces noise.

To switch the AM tuning interval

The default setting of the AM tuning interval is 10 kHz/step. If you use this unit in an area where the frequency allocation system is 9 kHz/step, change the tuning interval.

Hold down TUNER/AUX/BAND and press POWER on the main unit.

Tip:

When the AM tuning interval is changed, all preset stations are cleared.

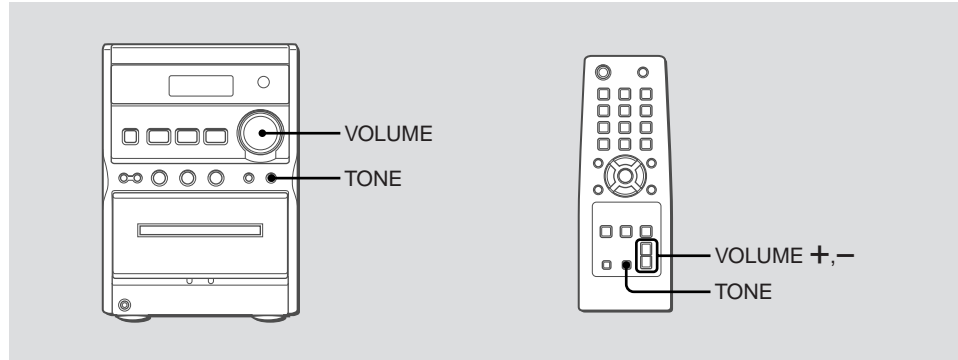

Volume

Turn VOLUME (press VOLUME +,- on the remote control).

Adjust from 0 (minimum) to 30 and MAX (maximum).

Tip:

Volume level setting is retained during power-off standby. If the unit is turned off with the volume set to 17 or higher, it is automatically turned down to 16 the next time the unit is turned on.

Bass and treble

- 1 Press TONE repeatedly to display "BAS" or "TRE".
"BAS" : Adjusts the bass level
"TRE" : Adjusts the treble level
- 2 Within 6 seconds, turn VOLUME (press VOLUME +,- on the remote control).
Each level can be adjusted from "-2" to "+5".
 - If the sound becomes distorted, lower the level.

TAPE PLAYBACK

En

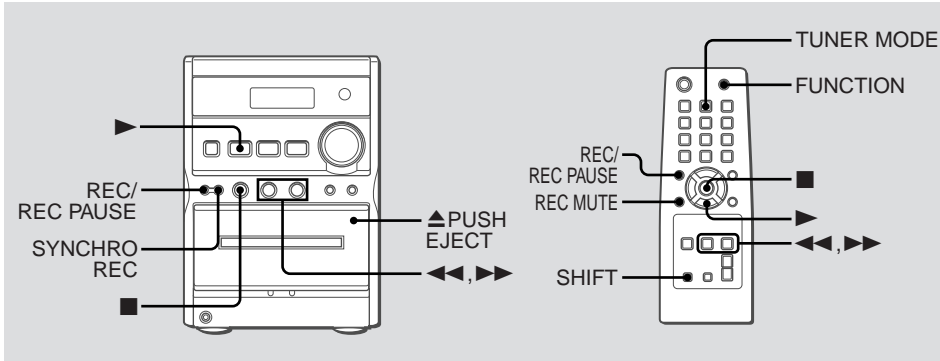

Notes on cassettes

- Use of 120-minute or longer tapes is not recommended since they are extremely thin and easily deformed or damaged.
- Wind up any slack in the tape with a pencil or similar tool before use. Slack tape may jam in the mechanism.

Playback

Use only type I (normal) tapes.

1 Press ▲PUSH EJECT to open the cassette holder.

2 Insert the tape.

Insert with the exposed side down and the side to be played facing out from the unit, and press ▲PUSH EJECT to close the cassette holder.

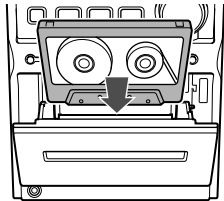

3 Press ▶ to start play.

To stop playback

Press ■.

To rewind or fast forward

Press ◀◀ or ▶▶.

To reset the tape counter

Press ■ in stop mode, and the tape counter on the display is reset to "0000".

Opening and closing the cassette holder will also reset the tape counter.

To eject the tape

Press ▲PUSH EJECT after the deck stops completely.

TAPE RECORDING

Basic recording

Use only type I (normal) tapes.

- 1 Press ▲PUSH EJECT to open the cassette holder.
 - 2 Insert the recording tape.
Insert with the exposed side down, and the side to be recorded on facing out from the unit. Press ▲PUSH EJECT to close the cassette holder.
 - 3 Press FUNCTION on the remote control to select the source to be recorded.
 - 4 Prepare the source.
To record CD, load a disc.
To record a radio broadcast, tune in the desired station.
To record from connected external equipment, prepare the equipment.
 - 5 Press REC/REC PAUSE twice to start recording.
When recording a CD, CD playback starts automatically. When recording input from connected equipment, manually start playback of the source.
On the remote control, hold down SHIFT and press REC/REC PAUSE twice to start recording.
- Volume or tone adjustment(s) does not affect recording.

To start CD recording more easily

Insert the tape to be recorded, load the disc, and press SYNCHRO REC. Regardless of the function currently selected, CD play and tape recording start simultaneously.

- In CD stop mode, tape recording starts from the beginning of the disc (all tracks recording).
When CD playback stops, tape recording stops simultaneously.
- In CD playback mode, the unit returns to the beginning of the current track and it records only that track (one track recording).
The unit continues playback till the end of the disc. To stop playback, press ■.

To stop recording

Press ■.

To pause recording (only for TUNER or AUX source)

Press REC/REC PAUSE. Press again to resume.

To record a selected set of tracks from a CD

Program the desired tracks (see "Programmed play" on page 9) and then press SYNCHRO REC.

To record a 4-second blank space (only for TUNER or AUX source)

Inserting 4-second blank spaces may help you locate the beginning of the track on other equipment with the "Music Sensor" function.

- 1 Press ► during recording or in recording pause mode. "REC MUTE" flashes on the display for 4 seconds (a blank space is added) and then the unit enters recording pause mode.
 - 2 Press REC/REC PAUSE to resume recording.
- REC MUTE on the remote control is also available to add a blank space in step 1.

To record a blank space shorter than 4 seconds, press again while "REC MUTE" flashes.

To record a blank space longer than 4 seconds, press again after the unit enters recording pause mode. Each time the button is pressed, a 4-second blank space is added.

To erase a tape

- 1 Insert the tape. Set the tape to the desired point if needed.
- 2 Select the AUX function.
If optional equipment is connected to the AUX IN jacks, turn it off.
- 3 Press REC/REC PAUSE twice.

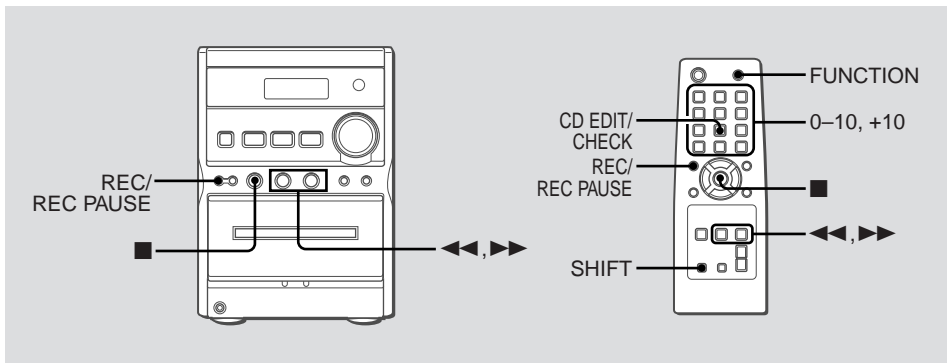

Edited CD recording

AI Edit Recording

Preparation

Prepare a tape that is longer than the CD length.

When recording a whole CD, AI Edit Recording takes the length of your tape into account and rearranges the recording order of the tracks if necessary, so that no track is cut short at the end of the side.

(AI: Artificial Intelligence)

- Recording cannot start from a point halfway in the tape.
- AI Edit Recording cannot be used with discs containing more than 30 tracks.

- 1 Insert the recording tape.
- 2 Press FUNCTION on the remote control to select the CD function, and load the disc.
- 3 Hold down SHIFT and press CD EDIT/CHECK on the remote control in stop mode.
"AI C--00" is displayed.

- 4 Press the numbered buttons on the remote control to enter the length of the recording tape. 10 to 99 minutes can be specified.
 - For a 60-minute tape press 6 and 0.
 In a few seconds, the unit determines the tracks to be recorded for each side.
 The recording time left for side A appears on the display.
 - ◀◀ or ▶▶ can also be used to specify tape length.
- 5 Press REC/REC PAUSE once.
The tape is rewound to the beginning of side A. "REC MUTE" flashes on the display and the lead segment is played through for 10 seconds, and recording starts. Go to the next step when recording on side A finishes.
On the remote control, hold down SHIFT and press REC/REC PAUSE to start recording.
- 6 Hold down SHIFT and press CD EDIT/CHECK once.
The recording time left for side B appears on the display.
- 7 Turn over the tape and press REC/REC PAUSE once.
Recording on side B starts in the same way as side A.

Programmed Edit Recording

As you program the CD tracks to record, Programmed Edit Recording displays the remaining recording time for each side of the tape, so you can easily select a set of desired tracks within the length of your tape.

- Recording cannot start from a point halfway in the tape.
- You cannot program more than 30 tracks.
- You cannot program a track with a track number larger than 30.

- 1 Insert the recording tape.
- 2 Press FUNCTION on the remote control to select the CD function, and load the disc.
- 3 Hold down SHIFT and press CD EDIT/CHECK twice on the remote control in stop mode.
"PRGC--00" is displayed.
- 4 Press the numbered buttons on the remote control to enter the length of the recording tape. 10 to 99 minutes can be specified.
 - For a 60-minute tape press 6 and 0.
 - ◀◀ or ▶▶ can also be used to specify tape length.
- 5 Press the numbered buttons on the remote control to select the first track to be recorded on side A.
 - To select the 25th track, press +10, +10 and 5.
 - To select the 11th track, press +10 and 1.
- 6 Repeat step 5 to select the rest of the tracks for side A.
The remaining recording time of side A is displayed. You cannot select a track with a longer playing time.
- 7 Hold down SHIFT and press CD EDIT/CHECK once to switch to side B and select the tracks for the side.

8 Hold down SHIFT and press CD EDIT/CHECK once to switch back to side A.

9 Press REC/REC PAUSE once.

The tape is rewound to the beginning of side A. "REC MUTE" flashes on the display and the lead segment is played through for 10 seconds, and recording starts.

Go to the next step when recording on side A finishes.

On the remote control, hold down SHIFT and press REC/REC PAUSE to start recording.

10 Hold down SHIFT and press CD EDIT/CHECK once to switch to side B.

11 Turn over the tape and press REC/REC PAUSE once.

Recording on side B starts in the same way as side A.

To stop recording

Press ■. Recording and CD playback stop simultaneously.

To check the program

1 Before recording, hold down SHIFT and press CD EDIT/CHECK on the remote control to select side A or B.

2 Press ◀◀ or ▶▶ repeatedly. The track number and program number are displayed in succession.

To change the program of each side

Hold down SHIFT and press CD EDIT/CHECK on the remote control to select side A or B, and press ■ to clear the program for the selected side. Then, select tracks again.

To clear the edit program

Press ■ twice.

To prevent accidental erasure

Break off the plastic tab of the cassette tape with a screwdriver or other pointed tool. To record on the tape again, cover the detection slot with adhesive tape.

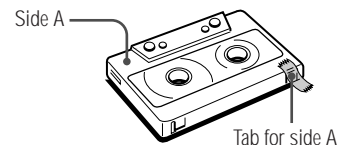

TIMER OPERATIONS

En

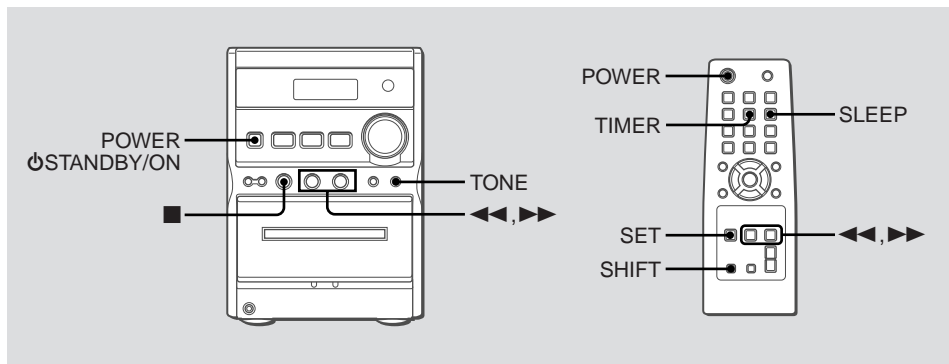

Sleep timer

Turns off the unit automatically after a specified time.

- 1 Hold down SHIFT and press SLEEP on the remote control.
"⏻" and "SLP" is displayed.
- 2 Within 6 seconds, press ◀ or ▶ repeatedly to set the sleep timer duration.
With each press, the timer duration changes in 5-minute steps between 5 to 240 minutes. If there is no button input for 6 seconds, the current setting is entered automatically. The unit turns off after the selected time.

To check the remaining time until the unit turns off

Hold down SHIFT and press SLEEP on the remote control. The remaining time is displayed for 6 seconds.

To cancel the sleep timer

Hold down SHIFT and press SLEEP on the remote control repeatedly so that "SLP OFF" is displayed.

Timer playback

Turns on the unit at a specified time for the specified duration. Make sure the clock is set correctly.

- 1 Hold down SHIFT and press TIMER on the remote control repeatedly so that "⏻" and "⏻ PLAY" is displayed.
- 2 Within 6 seconds, press SET.
- 3 Press ◀ or ▶ to set the timer-on time, and press SET.
Each press changes the time in 1-minute steps. Holding these buttons down will vary the time in 10-minute units.
- 4 Press ◀ or ▶ to select the source, and press SET.
 - For timer play of a CD, select "CD".
 - For timer play of a tape, select "TP".
 - For timer play of a radio broadcast, select "TU". You will select the band later in step 7.
 - For timer play of the equipment connected to the AUX IN jacks, select "AUX".

- 5 Press ◀ or ▶ to set the timer-activated duration, then press SET.
With each press, the timer-activated duration changes in 5-minute steps between 5 to 240 minutes.
- 6 Press ◀ or ▶ to adjust the volume for timer playback, and press SET.
The volume level can be adjusted from 0 to 16.
- 7 Prepare the source.
To play CD, load a disc.
To play a tape, insert the tape.
To play the radio, select the band and tune in the desired station.
To play external equipment connected to the AUX IN jacks, set an external timer for the equipment so that its playback begins at the same time.
- 8 Press POWER STANDBY/ON (POWER) to turn the unit off.
"⏻" remains on the display to indicate the timer standby mode.
At timer-on time, the unit turns on and plays the selected source. After the specified timer-activated duration, the unit turns off again.
 - To stop timer setting in steps 3 to 6, press ■. Timer standby mode is also canceled.
 - Timer playback will not begin unless the unit is turned off first.
 - Connected equipment cannot be turned on or off by the built-in timer of this unit. Use an external timer.

Timer recording

Timer recording is available only for TUNER and AUX (with an external timer) sources.

- 1 Hold down SHIFT and press TIMER on the remote control repeatedly so that "⏻ REC" is displayed.
- 2 Within 6 seconds, press SET.
- 3 Press ◀◀ or ▶▶ to set the timer-on time, and press SET.
Each press changes the time in 1-minute steps.
Holding these buttons down will vary the time in 10-minute units.
- 4 Press ◀◀ or ▶▶ to select the source, and press SET.
 - For timer recording of a radio broadcast, select "TU".
You will select the band later in step 7.
 - For timer recording of the equipment connected to the AUX IN jacks, select "AUX".
- 5 Press ◀◀ or ▶▶ to set the timer-activated duration, then press SET.
With each press, the timer-activated duration changes in 5-minute steps between 5 to 240 minutes.
- 6 Press ◀◀ or ▶▶ to adjust the volume for timer recording, and press SET.
The volume level can be adjusted from 0 to 16.
- 7 Prepare the source.
To record the radio, select the band and tune in the desired station.
To record external equipment connected to the AUX IN jacks, set an external timer for the equipment so that its playback begins at the same time.

- 8 Insert the recording tape and then turn the unit off.
"⏻ REC" remains on the display to indicate the timer standby mode.
At timer-on time, the unit turns on and records the selected source. After the specified timer-activated duration, the unit turns off again.

- To stop timer setting in steps 3 to 6, press ■.
Timer standby mode is also canceled.
- Connected equipment cannot be turned on or off by the built-in timer of this unit. Use an external timer.

When setting the timer on the unit

Hold down ■ and press ◀◀ in stop mode.

Repeat the above to select timer playback, timer recording or timer off mode, and use TONE instead of SET on the remote control in the following steps.

To check the timer setting

Hold down SHIFT and press TIMER on the remote control repeatedly so that "⏻ PLAY" or "⏻ REC" appears on the display.

The timer-on time, the source and the timer-activated duration are displayed for 6 seconds.

To change the timer setting

Reset the timer again.

To cancel the timer

Hold down SHIFT and press TIMER on the remote control repeatedly until "⏻ OFF" is displayed. "⏻" or "⏻ REC" disappears from the display.

Tip:

Your timer setting is retained even if the timer is canceled. Next time the timer is activated, you can change your previous setting, or simply use the same setting again.

REFERENCE

Care and maintenance

Occasional care and maintenance of the unit and the software are needed to optimize the performance of your unit.

To clean the cabinet

Use a soft and dry cloth. If the unit surfaces are extremely dirty, use a soft cloth lightly moistened with mild detergent solution. Do not use strong solvents such as alcohol, benzine or thinner.

To clean the tape heads

Dirty tape heads cause sound deterioration. After every 10 hours of use, clean the tape heads with a head cleaning cassette. Refer to the instructions of the cleaning cassette.

To demagnetize the tape heads

Use a demagnetizing cassette after every 20 to 30 hours of use. Refer to the instructions of the demagnetizing cassette.

Care of CDs

When a CD becomes dirty, wipe it from the centre out with a cleaning cloth. After playing a CD, store it in its case. Do not keep it in hot or humid places.

Care of tapes

Store tapes in their cases after use. Do not leave tapes near magnets, motors, television sets, or any source of magnetism. Do not expose tapes to direct sunlight, or leave them in a car parked in direct sunlight.

Troubleshooting

If your unit fails to perform properly, check the following guide and the relevant sections of the Operating Instructions.

There is no sound

- Are the speakers and AC power cord connected properly?

The unit shut off suddenly

- Possibly a short circuit in the speaker terminals. Disconnect the AC power cord from the AC outlet and reconnect the speaker cords correctly.

Erroneous display

- Reset the unit. (See "Resetting the unit" on this page.)

Poor radio reception

- Check antenna connection. Adjust the antenna to find the best reception.
- Move the unit and antenna away from other electric appliances and cords.

Poor tape sound

- Check for dirty heads. Clean them if needed.

Cannot record

- Is the erasure prevention tab of the tape broken off? If so, cover the detection slot with adhesive tape.

The CD player works poorly

- Is the disc correctly loaded?
- Is the disc dirty?
- Is the lens affected by condensation? If so, wait approximately one hour and try again.

Condensation

Moisture may form on the CD pickup lens when:

- The unit is moved from a cold spot to a warm spot
- The heating system has just been turned on
- The unit is used in a very humid room
- The unit is cooled by an air conditioner

When this unit has condensation inside, it may not function normally. Should this occur, leave the unit for a few hours, then try to operate again.

Resetting the unit

If an unusual condition occurs in the display window or the cassette deck, reset the unit as follows:

- 1 Press POWER to turn off the power.
If the power cannot be turned off, disconnect the AC power cord, then plug it in again.
- 2 Hold down  and press POWER on the main unit.
Everything stored in memory after purchase is cleared.

Specifications

MAIN UNIT CX-LEM20

TUNER

FM tuning range	87.5 MHz to 108 MHz
FM usable sensitivity (IHF)	13.2 dBf
FM antenna terminal	75 ohms (unbalanced)
AM tuning range	530 kHz to 1710 kHz (10 kHz step) 531 kHz to 1602 kHz (9 kHz step)
AM usable sensitivity	350 µV/m
AM antenna	Loop antenna

AMPLIFIER

Power output	6 W + 6 W (40 Hz - 20 kHz, THD less than 1 %, 6 ohms) 7.5 W + 7.5 W (1 kHz, THD 10 %, 6 ohms)
Total harmonic distortion	0.1 % (3 W, 1 kHz, 6 ohms, DIN AUDIO)
Input	AUX IN: 500 mV
Outputs	SPEAKERS: 6 ohms or more PHONES: 32 ohms or more

CASSETTE DECK

Track format	4 tracks, 2 channels stereo
Frequency response	50 Hz - 10000 Hz
Recording system	AC bias
Heads	Recording/playback × 1, erase × 1

CD PLAYER

Laser	Semiconductor laser ($\lambda = 780$ nm)
D/A converter	1 bit dual
Signal-to-noise ratio	80 dB (1 kHz, 0 dB)
Wow and flutter	Unmeasurable

GENERAL

Power requirements	120 V AC, 60 Hz
Power consumption	26 W
Dimensions (W × H × D)	163 × 230 × 215.7 mm (6 1/2 × 9 1/8 × 8 1/2 in.)
Weight	2.7 kg (5 lbs 15 oz)

SPEAKER SYSTEM SX-LEM20

Speakers system	1 way, bass reflex (magnetic shielded)
Speaker units	Full range: 100 mm cone
Impedance	6 ohms
Dimensions (W × H × D)	140 × 230 × 195 mm (5 5/8 × 9 1/8 × 7 3/4 in.)
Weight	1.8 kg (3 lbs 15 oz)

Specifications and external appearance are subject to change without notice.

COPYRIGHT

Check copyright laws relevant to recordings from discs, radio or tape for the country where the unit is to be used.

NOTE

This equipment has been tested and found to comply with the limits for a Class B digital device, pursuant to Part 15 of the FCC Rules. These limits are designed to provide reasonable protection against harmful interference in a residential installation.

This equipment generates, uses, and can radiate radio frequency energy and, if not installed and used in accordance with the instructions, may cause harmful interference to radio communications. However, there is no guarantee that interference will not occur in a particular installation. If this equipment does cause harmful interference to radio or television reception, which can be determined by turning the equipment off and on, the user is encouraged to try to correct the interference by one or more of the following measures:

- Reorient or relocate the receiving antenna.
- Increase the separation between the equipment and receiver.
- Connect the equipment into an outlet on circuit different from that to which the receiver is connected.
- Consult the dealer or an experienced radio/TV technician for help.

CAUTION

Modifications or adjustments to this product, which are not expressly approved by the manufacturer, may void the user's right or authority to operate this product.

Printed in China

REMARQUE

Cet appareil a été testé et jugé conforme aux limites des appareils numériques de Classe B, conformément à la Partie 15 des Règles FCC. Ces limites sont conçues pour fournir une protection raisonnable contre les interférences néfastes dans une installation résidentielle.

Cet appareil produit, utilise et peut rayonner une énergie de fréquence radio et, s'il n'est pas installé et utilisé conformément aux instructions, peut provoquer des interférences gênantes pour les communications radio. Mais rien ne garantit qu'une telle interférence ne se produira pas dans une installation particulière. Si cet appareil produit des interférences gênantes pour la réception radio ou de télévision, ce qui peut se déterminer en allumant et éteignant l'appareil, il est recommandé à l'utilisateur d'essayer de corriger cette interférence en appliquant une ou plusieurs des mesures suivantes:

- Réorientation ou déplacement de l'antenne réceptrice.
- Éloignement de l'appareil du récepteur.
- Raccordement de l'appareil à une prise d'un circuit différent de celui du récepteur.
- Consultez le revendeur ou un technicien radio/télévision expérimenté.

PRÉCAUTION

Les modifications ou ajustements de ce produit, non expressément approuvés par le fabricant, peuvent invalider le droit ou l'autorité de l'utilisateur à utiliser ce produit.

CAUTION

TO PREVENT ELECTRIC SHOCK DO NOT USE THIS (POLARIZED) PLUG WITH AN EXTENSION CORD, RECEPTACLE OR OTHER OUTLET UNLESS THE BLADES CAN BE FULLY INSERTED TO PREVENT BLADE EXPOSURE.

This Class B digital apparatus complies with Canadian ICES-003.

Only for C models.

ATTENTION

POUR PREVENIR LES CHOCS ELECTRIQUES NE PAS UTILISER CETTE FICHE POLARISEE AVEC UN PROLONGATEUR, UNE PRISE DE COURANT OU UNE AUTRE SORTIE DE COURANT, SAUF SI LES LAMES PEUVENT ETRE INSEREES A FOND SANS EN LAISSER AUCUNE PARTIE A DECOUVERT.

Cet appareil numérique de la classe B est conforme à la norme NMB-003 du Canada.

Pour les modèles C uniquement.