

**FUJIFILM**

**digital**  
Tools for the imagination.

DIGITAL CAMERA

# *FinePix 2400 Zoom*

**2.1**  
MEGA  
PIXELS

**3x**  
OPTICAL  
ZOOM



Getting Ready

**1**

Basic Photography

**2**

Advanced Features

**3**

Advanced Features  
Playback

**4**

Settings

**5**

**OWNER'S MANUAL**

This manual will show you how to use your FUJIFILM DIGITAL CAMERA FinePix2400 ZOOM correctly. Please follow the instructions carefully.

BB11660-200 (1)



# Warning

## For customers in the U.S.A.

### FCC Statement

This device complies with part 15 of the FCC Rules. Operation is subject to the following two conditions:(1) This device may not cause harmful interference, and (2) this device must accept any interference received, including interference that may cause undesired operation.

### CAUTION

This equipment has been tested and found to comply with the limits for a Class B digital device, pursuant to Part 15 of the FCC Rules. These limits are designed to provide reasonable protection against harmful interference in a residential installation. This equipment generates, uses, and can radiate radio frequency energy and, if not installed and used in accordance with the instructions, may cause harmful interference to radio communications. However, there is no guarantee that interference will not occur in a particular installation. If this equipment does cause harmful interference to radio or television reception, which can be determined by turning the equipment

off and on, the user is encouraged to try to correct the interference by one or more of the following measures:

- Reorient or relocate the receiving antenna.
- Increase the separation between the equipment and receiver.
- Connect the equipment into an outlet on a circuit different from that to which the receiver is connected.
- Consult the dealer or an experienced radio/TV technician for help.

You are cautioned that any changes or modifications not expressly approved in this manual could void your warranty.

## For customers in Canada

### CAUTION

This Class B digital apparatus complies with Canadian ICES-003.

**Please read the Safety Notes (⇒P.80) and make sure you understand them before using the camera.**

## EC Declaration of Conformity

We

Name : Fuji Photo Film (Europe) G.m.b.H.  
Address : Heesenstrasse 31  
40549 Dusseldorf, Germany

declare that the product

Product Name : FUJIFILM DIGITAL CAMERA FinePix2400 ZOOM  
Manufacture's Name : Fuji Photo Film Co., Ltd.  
Manufacture's Address : 26-30, Nishiazabu 2-chome, Minato-ku,  
Tokyo 106-8620, Japan

is in conformity with the following Standards

Safety : EN60950  
EMC : EN55022 : 1998 Class B  
EN55024 : 1998  
EN61000-3-2 : 1995 + A1:1998 + A2:1998

following the provision of the EMC Directive (89/336/EEC, 92/31/EEC and 93/68/EEC) and Low Voltage Directive (73/23/EEC).



Dusseldorf, Germany

August 1, 2000

Place

Date

Signature/Managing Director



Bij dit produkt zijn batterijen geleverd. Wanneer deze leeg zijn, moet u ze niet weggooien maar inleveren als KCA

# Contents

Warning .....	2
Preface .....	6
Camera Features and Accessories .....	7
Nomenclature .....	8

## 1 Getting Ready

PREFACE .....	11
● Selecting the Language .....	11
● Attaching the Strap .....	11
SELECTING THE POWER SUPPLY .....	12
● Using Batteries .....	12
● Using the AC Power Adapter .....	13
LOADING AND REMOVING THE SmartMedia™ .....	14
● SmartMedia™ .....	14
● Loading the SmartMedia™ .....	14
● Removing the SmartMedia™ .....	15
SWITCHING ON AND OFF .....	16
4 SETTING THE DATE AND TIME .....	18

## 2 Basic Photography

📷 TAKING PICTURES .....	20
● Number of available frames .....	25
📷 USING AF/AE LOCK .....	26
▶ VIEWING YOUR IMAGES (PLAYBACK) .....	28
▶ PLAYBACK ZOOM .....	29
▶ MULTI-FRAME PLAYBACK .....	30
▶ → 🗑 ERASING SINGLE FRAME .....	31

## 3 Advanced Features

📷 IN PHOTOGRAPHY MODE .....	33
<b>PHOTOGRAPHY MENU</b>	
USING THE PHOTOGRAPHY MENU .....	34
SELECTING THE MODE .....	35
SETTING THE FILE SIZE AND QUALITY .....	36
🌸 MACRO (CLOSE-UP) PHOTOGRAPHY .....	37
📷 CONTINUOUS SHOOTING .....	38
🕒 SELF-TIMER PHOTOGRAPHY .....	39
☑ SETTING THE BRIGHTNESS (EXPOSURE COMPENSATION) .....	41
🗑 SETTING THE WHITE BALANCE .....	42

⚡ USING THE FLASH .....	43
Auto Flash .....	43
👁 Red-Eye Reduction .....	44
⚡ Forced Flash .....	44
🔇 Suppressed Flash .....	45
🌃 Night Scenes (Slow Synchro) .....	45
📷 USING THE DIGITAL TELEPHOTO .....	46

## 4 Advanced Features Playback

▶ ADVANCED PLAYBACK .....	47
<b>PLAYBACK MENU</b>	
🗑 ERASING SINGLE • ALL FRAMES/FORMATTING .....	48
🔍 SETTING AND REMOVING SINGLE FRAME PROTECTION .....	50
🔍 SETTING AND REMOVING PROTECTION FOR ALL FRAMES .....	52
🔍 HOW TO SPECIFY PRINT OPTIONS .....	54
🖨 DPOF DATE SETTING .....	55
🖨 DPOF SET/RESET FRAME .....	56
🖨 DPOF SET ALL/RESET ALL .....	58

## 5 Settings

📷 SET-UP MODE .....	59
● Frame No. Memory .....	61
ADJUSTING THE LCD MONITOR BRIGHTNESS .....	62

System Expansion Options .....	63
Using the USB Interface Set .....	64
● Replacing SmartMedia™ .....	65
Accessories Guide .....	66
Explanation of Terms .....	68
Notes on Using Your Camera Correctly .....	69
Notes on the Power Supply .....	70
● Applicable Batteries .....	70
● Notes on the Batteries .....	70
● Notes on Using the AC Power Adapter .....	71
Notes on the SmartMedia™ .....	72
Warning Displays .....	74
Troubleshooting .....	76
Specifications .....	78
Safety Notes .....	80

# Preface

## ■ Test Shots Prior to Photography

For particularly important photographs (such as weddings and overseas trips), always take a test photograph to check that the camera is functioning normally.

- Fuji Photo Film Co., Ltd cannot accept liability for any incidental losses (such as the costs of photography or the loss of income from photography) incurred as a result of faults with this product.

## ■ Notes on Copyright

Images recorded using your digital camera system cannot be used in ways that infringe copyright laws without the consent of the owner, unless intended only for personal use. Note that some restrictions apply to the photographing of stage performances, entertainments and exhibits, even when intended purely for personal use. Users are also asked to note that the transfer of memory cards containing images or data protected under copyright laws is only permissible within the restrictions imposed by those copyright laws.

## ■ Liquid Crystal

If the LCD monitor or LCD panel is damaged, take particular care with the liquid crystal in the monitor or panel. If any of the following situations arise, take the urgent action indicated.

- If liquid crystal comes in contact with your skin  
Wipe the area with a cloth and then wash thoroughly with running water and soap.
- If liquid crystal gets into your eye  
Flush the affected eye with clean water for at least

15 minutes and then seek medical assistance.

- If liquid crystal is swallowed  
Flush your mouth thoroughly with water. Drink large quantities of water and induce vomiting. Then seek medical assistance.

## ■ Notes on Electrical Interference

If the camera is needed be used in hospitals or aircrafts, please note that this camera may cause interference to other equipment in the hospital or aircraft.

For details, please check with the applicable regulations in that place.

## ■ Handling Your Digital Camera

This camera contains precision electronic components. To ensure that images are recorded correctly, do not subject the camera to impacts or shocks while an image is being recorded.

## ■ Trademark Information

- IBM PC/AT is a registered trademark of International Business Machines Corp. of the USA.
- iMac and Macintosh is a trademark of Apple Computer, Inc.
- MS-DOS and Windows are registered trademarks of the Microsoft Corporation of the U.S. registered in the USA and other countries.  
Windows is an abbreviated term referring to the Microsoft Windows Operating System.
- SmartMedia is a trademark of Toshiba Corporation.
- Other company or product names are trademarks or registered trademarks of the respective companies.

# Camera Features and Accessories

## Features

- High-quality images from the 2.11-million-pixel CCD and high-resolution Fujinon lens
- Records images at resolutions of up to 1600×1200 pixels
- Compact, lightweight body
- 1.6-inch color LCD monitor
- Wide-angle field of view with Macro
- Built-in automatic flash with precise wide-range flash control
- Manual photography mode that allows for further flexibility
- Digital 2.5× zoom photography function/1.2× to 4× zoom playback function
- Simple operation using the mode switch and easy-to-use direction buttons (“◀▶” “▲▼”)
- Date and time recording/playback function
- Compatible with 3.3V, 2MB to 64MB SmartMedia
- USB connection for quick and easy image data transmission
- Conforms to the new standard for digital camera file system\*  
\* Design rule for Camera File system
- Support for DPOF\* simplifies print ordering  
\* DPOF stands for “Digital Print Order Format”

## Accessories

- LR6 AA-size alkaline batteries (4)
- Hand Strap (1)

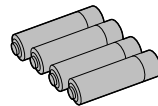

- SmartMedia (8MB, 3.3V) (1)  
Supplied with:
  - Anti-static case (1)
  - Index label (1)

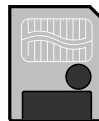

- Interface Set (1)
  - CD-ROM (1)
  - Special USB cable with Noise Suppression core (1)
  - Quick Start Guide
- Owner's Manual (this manual) (1)

# Nomenclature

\* Refer to the pages in parentheses for information on using the camera features.

**Mode Switch**

Power OFF ———

Playback mode (P.28) ———

Photography mode (P.20, 59) ———

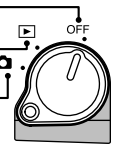

**📷 (Photography) Mode**  
Select this setting for photography and camera setup.

**▶ (Playback) Mode**  
This mode allows playback zoom and multi-frame playback as well as normal single-frame playback. This mode can also be used to erase frames, format SmartMedia, protect images and specify DPOF settings.

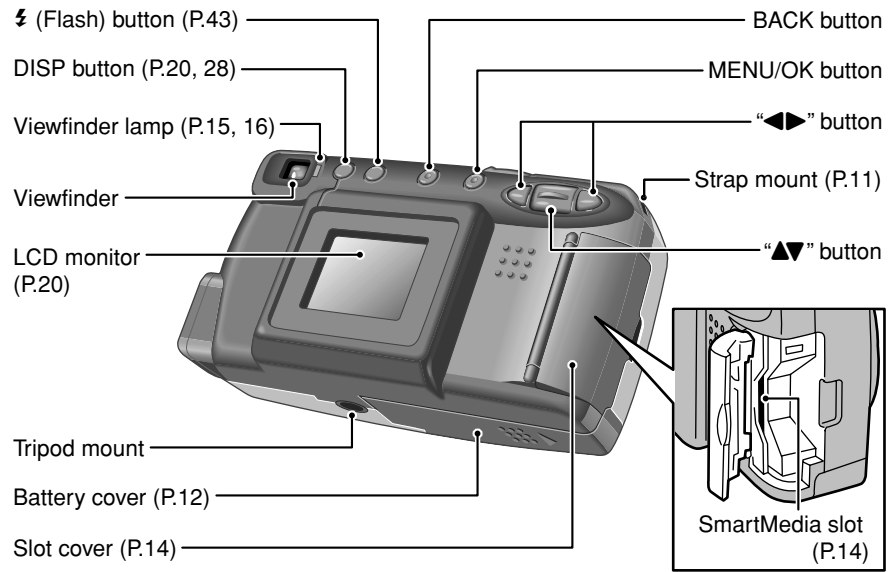
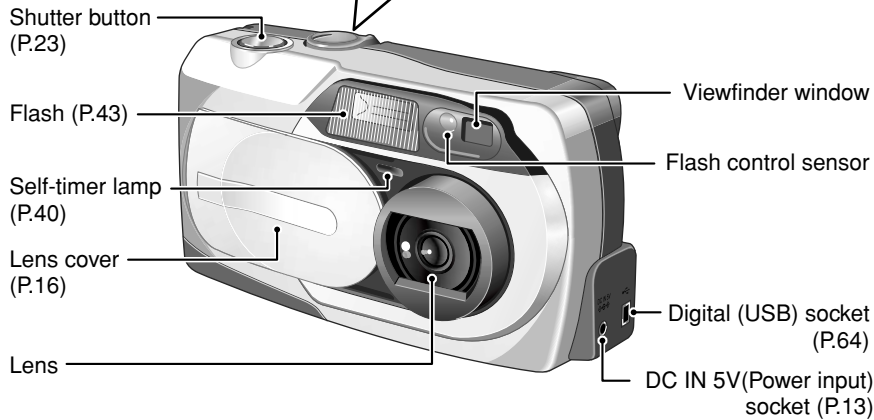

## Nomenclature

### Example of LCD Monitor Text Display : Shooting

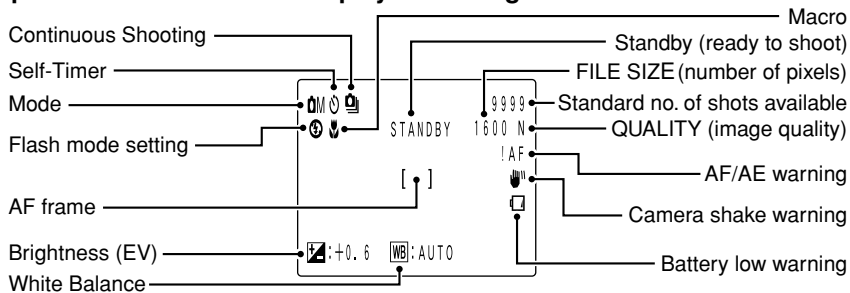

### Example of LCD Monitor Text Display : Playback

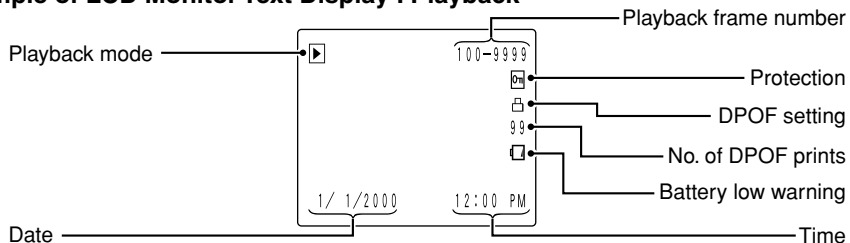

### Selecting the Language

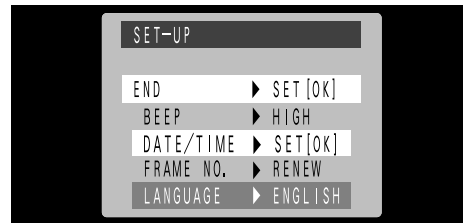

You can use the Setup screen on this camera to select English or French as the language used for screen display (➔P.59). The screens in this manual are shown in English.

### Attaching The Strap

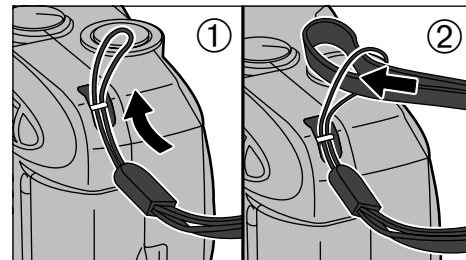

- Pass the loop of thin cord on the end of the strap through the strap mount.
- Then pass the other end of the strap through the loop of thin cord and pull the strap tight.

# SELECTING THE POWER SUPPLY

## Using Batteries

Use 4 AA-size alkaline, Ni-MH or Ni-Cd batteries. Do not use different types of batteries together.

### ■ Number of available shots (with fully charged batteries)

The table below provides a guide to the number of shots that can be taken at normal temperature with 50% flash use. Note that these figures may vary depending on the camera's ambient temperature and the level of battery charge.

Battery type	With LCD monitor ON	With LCD monitor OFF
Alkaline batteries	Approx.200 frames	Approx.400 frames
Ni-MH battery HR-3UF	Approx.200 frames*	Approx.400 frames*
Ni-Cd battery KR-3UF	Approx.130 frames*	Approx.270 frames*

\* With fully charged battery

### ◆ Important Battery Information ◆

- Because different brands of alkaline batteries have different capacities, the life of some batteries (the length of time for which they can be used) may be considerably shorter than that of the alkaline batteries supplied with this camera.
- It is a characteristic of alkaline batteries in particular that the life of the battery is shorter at low temperatures (+10°C or below).
- Do not use lithium or manganese batteries in your FinePix2400 ZOOM because the heat generated by the batteries could damage the camera.

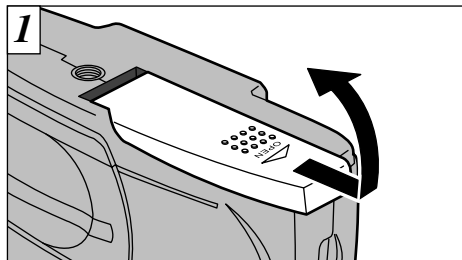

Slide the battery cover in the direction of the arrow and open the cover.

- ⚠ Soiling such as fingerprints on the battery terminals can significantly reduce the number of available shots (⇒P.70).
- ⚠ Do not use new and used batteries together.
- ⚠ Always switch the camera off when replacing the batteries. If the camera is left on, the camera settings may revert to the factory default settings.
- ⚠ Install replacement batteries within 5 minutes, since the camera settings are only retained for 5 minutes once the batteries are removed.
- ⚠ The Quick Battery Charger (sold separately) is needed to recharge AA-size Ni-MH or Ni-Cd batteries (⇒P.66).

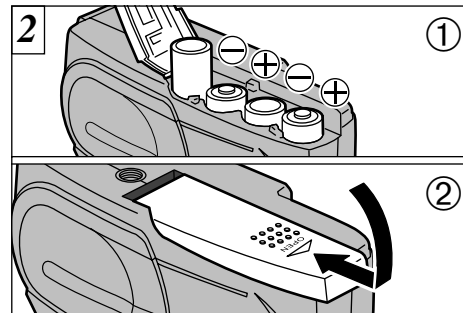

- ① Install the batteries with the correct polarity as shown.
- ② Close the battery cover as indicated by the arrow.

- ⚠ Do not use excessive force on the battery cover.
- ⚠ Take care not to drop the batteries when you open or close the battery cover.

## Using the AC Power Adapter

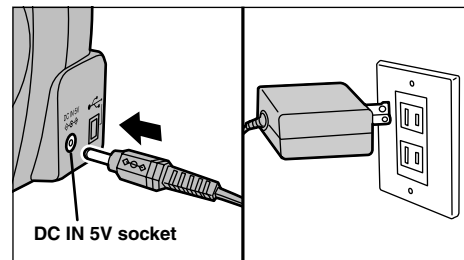

To shoot or play back images without depleting the battery charge, use the special AC Power Adapter AC-5V/AC-5VH (sold separately). Check that the camera is switched off and then plug the AC power adapter connector into the "DC IN 5V socket" on the camera. Then plug the AC power adapter into the power outlet.

- ⚠ You cannot charge the batteries by connecting the AC power adapter.
- ⚠ The shapes of the plug and socket-outlet depends on the country of use.
- ⚠ Using AC power adapters other than the AC-5V/AC-5VH could damage the camera.
- ⚠ See P.71 for more information on the AC power adapter.

## LOADING AND REMOVING THE SmartMedia™

### SmartMedia™

#### ■ Only use 3.3V SmartMedia.

MG-4S (4MB), MG-8S (8MB), MG-16S/SW (16MB), MG-32S/SW (32MB), MG-64S/SW (64MB)

- ⚠ Images cannot be recorded or erased if a write-protect sticker is affixed to the SmartMedia.
- ⚠ Operation of this camera is only guaranteed when it is used with Fujifilm SmartMedia.
- ⚠ Some 3.3V SmartMedia are labelled as "3V" cards.

To record data on a SmartMedia, you must first format the SmartMedia using the FinePix2400 ZOOM (➔P.48).

### Loading the SmartMedia™

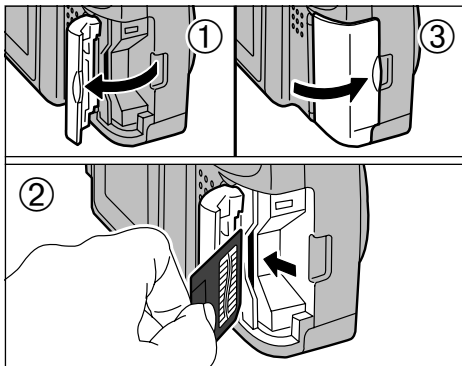

- ① Check that the camera is switched off and then open the slot cover in the direction of the arrow.
  - ② Push the SmartMedia firmly into the SmartMedia slot as far as it will go.
  - ③ Close the slot cover.
- ⚠ If you open the slot cover while the camera is switched on, the camera is automatically switched off to protect the SmartMedia.
  - ⚠ The SmartMedia will not slide fully into the slot if it is inserted facing the wrong way. Be careful not to apply undue force to the SmartMedia.

### Removing the SmartMedia™

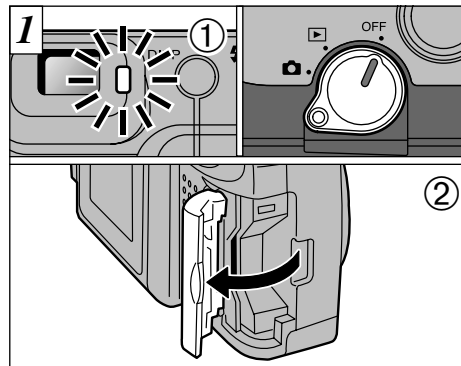

- ① Check that the viewfinder lamp is lit green before you switch the camera off. (Set the Mode switch to "OFF".)
- ② Open the slot cover in the direction of the arrow.

Always switch the camera off before opening the slot cover. Opening the slot cover while the camera is on can corrupt the image data on the SmartMedia card or damage the card itself.

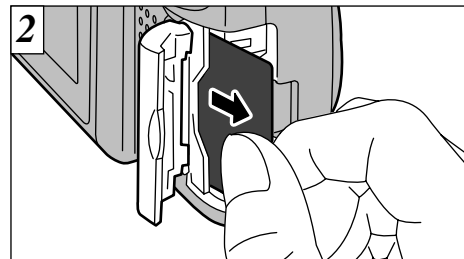

Grip the SmartMedia and pull it out.

- ⚠ To protect the SmartMedia, always store it in the special anti-static case.
- ⚠ See P.72 for more information on SmartMedia.

#### ◆ Printing Images and Downloading Images to a Personal Computer ◆

- See P.54, 63 for information on printing your images.
- See P.63 to 65 for information on downloading your images to a personal computer.



## SWITCHING ON AND OFF

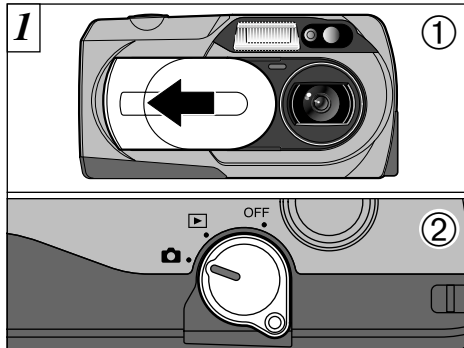

**To switch the camera on in “📷” photography mode:**

- ① Slide the lens cover open until it stops.
- ② Move the Mode switch from the “OFF” position to “📷” photography.

**To switch the camera on in “📺” playback mode:**  
Move the Mode switch from the “OFF” position to “📺” playback.

- ⚠ If the “LENS COVER” warning appears on the LCD monitor, the lens cover is not fully open. Slide the cover all the way open until it stops.

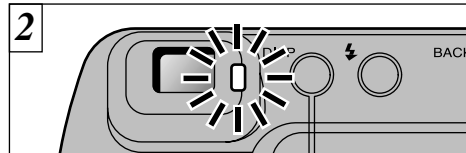

When you switch the camera on, the viewfinder lamp turns green. To switch the camera off, set the Mode switch to “OFF”.

### ◆ Lens Cover Warnings ◆

In “📷” photography mode, the “LENS COVER” warning is displayed if the lens cover is not open.  
To switch from “📺” playback mode to “📷” photography mode, open the lens cover.

### ◆ Auto Power Off Function ◆

If the camera is left switched on for two minutes or more, the Auto Power Off function automatically switches the camera off. To switch the camera back on, set the Mode switch to OFF and then set it back to “📷” to take pictures or “📺” to view images. Holding down the “MENU/OK” button as you switch the camera on disables the Auto Power Off function.

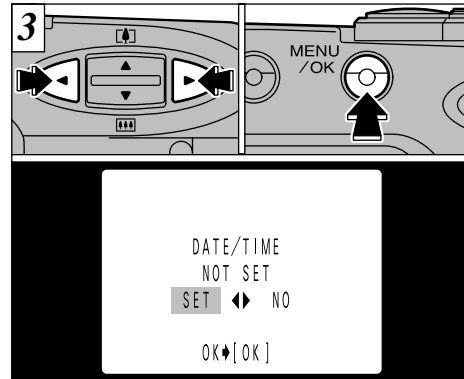

If the date is not set, a confirmation screen appears. Use the “◀” or “▶” button to select one of the options below and then press the “MENU/OK” button.

“SET” : Switches to the date setting screen.  
“NO” : Switches to Photography/Playback mode.

- ⚠ If you do not set the date, the confirmation screen will appear each time you switch the camera on. Set the date immediately to avoid this.
- ⚠ See P.18 for information on setting the date.

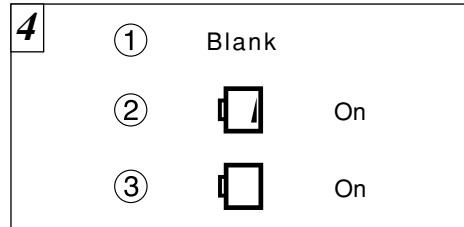

With the LCD monitor on, you can check the remaining charge in the battery.

- ① Battery has ample charge. (No indicator displayed.)
- ② Battery charge low. Replace or recharge the battery as it will run out shortly.
- ③ The battery is exhausted. The display will shortly go blank and the camera will stop working. Replace or recharge the battery.

- ⚠ If the battery charge is depleted, you may not be able to switch the LCD monitor on.

## SETTING THE DATE AND TIME

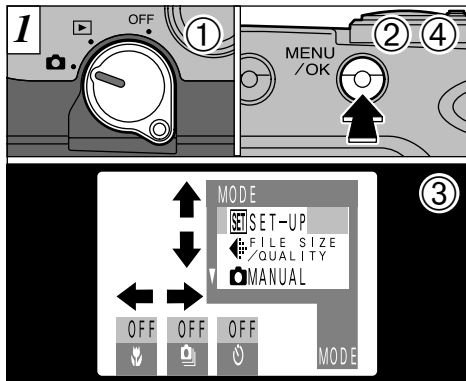

- 1 Check that the lens cover is open and then set the Mode switch to "CAM".
- 2 Press the "MENU/OK" button to switch to the menu screen.
- 3 Use the "◀" and "▶" buttons to select MODE and then use the "▲▼" button to select "SET-UP".
- 4 Press the "MENU/OK" button.

If the date is cleared when you switch the camera on, a confirmation screen appears. If you selected "SET", proceed from step [3].

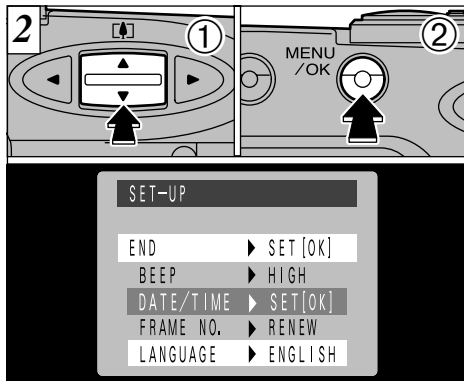

- 1 Use the "▲▼" button to select "DATE/TIME", and
- 2 press the "MENU/OK" button.

- ! If you take the batteries out of the camera for 5 minutes or more, or remove the batteries during setup, the camera settings may all revert to the factory default values.
- ! See P.59 for more information on the SET-UP menu.

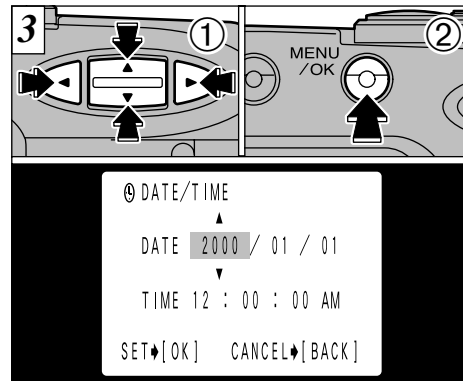

- 1 Use the "◀" or "▶" button to select the item you want to set (year, month, day, hour or minute), and then use the "▲▼" button to correct the setting.
- 2 When you have completed the settings, press the "MENU/OK" button.

- ! You cannot set seconds.
- ! When the time displayed passes "12:00:00", the AM/PM setting automatically switches.

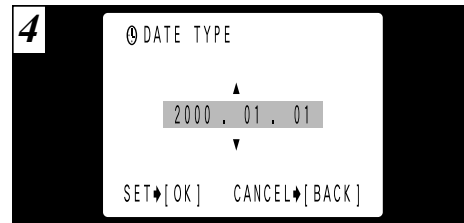

- 1 You can use the "▲▼" button to select the order in which the date is displayed on the LCD monitor.  
 [Month/Day/Year ↔ Day.Month.Year ↔ Year.Month.Day]
- 2 Select the desired order and then press the "MENU/OK" button.
- 3 When the SET-UP screen appears, use the "▲▼" button to select "END".
- 4 Press the "MENU/OK" button to exit the SET-UP screen.

- ! After the camera has exited the "SET-UP" screen, the LCD monitor switches off.
- ! To set the time precisely, press the "MENU/OK" button when the time is at zero seconds.

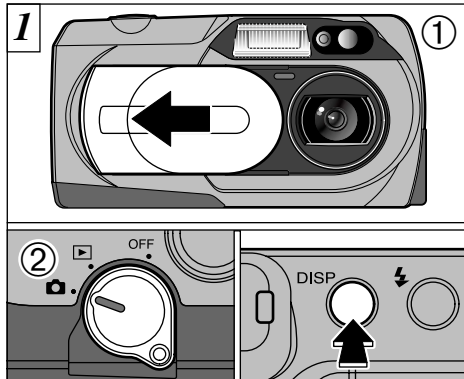

- ① Slide the lens cover open until it stops.
- ② When you set the Mode switch to “”, the lens extends.

To take pictures using the LCD monitor, press the “DISP” button to switch the LCD monitor on. In the “A” photography mode, pressing the “DISP” button changes the display status one step in a 3-step cycle from “LCD monitor OFF” to “LCD monitor ON” to “No text displaye” and so on.

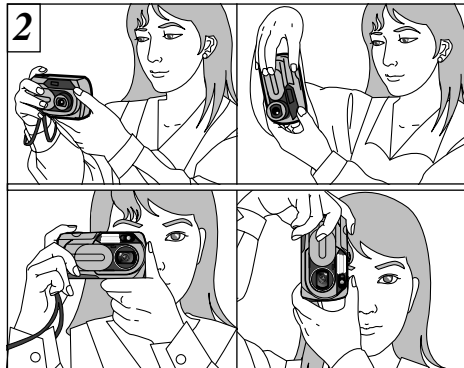

Loop the strap over your wrist, brace your elbows against your body and grip the camera firmly in both hands. When you are holding the camera on its side, hold it so that the shutter button is at the top.

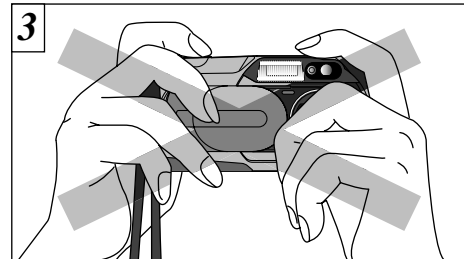

- ⚠ If the “” warning appears on the LCD monitor, the lens cover is not fully open. Slide the cover all the way open until it stops.
- ⚠ Take care not to place your fingers over the lens when it extends or during shooting as this can cause a camera fault.

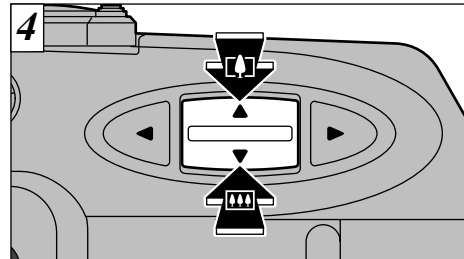

Ensure that your fingers or the camera strap do not obscure the lens, flash, or flash control sensor.

- ⚠ Check that the lens clean. If it is dirty, clean the lens as described on P.69.
- ⚠ The image will be blurred if the camera moves when you take the picture (camera shake).



To zoom in on the subject (TELE ), press the “▲” side of the “▲▼” button. To zoom out (WIDE ), press the “▼” side of the “▲▼” button.

● **Flash range**

- Wide-angle : 0.2m to 3.0m (7.9in.-9.8ft.)
- Telephoto : 0.8m to 3.0m (2.6ft.-9.8ft.)

- ⚠ The lens on the FinePix2400 ZOOM is a 3× zoom lens with a focal range equivalent to 38-114mm on a 35mm camera.

## 📷 TAKING PICTURES

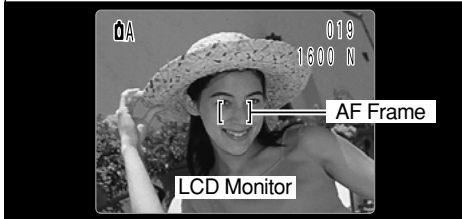
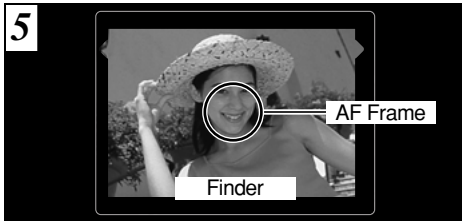

Using the viewfinder or LCD monitor, frame your shot so that the subject fills the entire AF (Auto Focus) frame.

- ⚠ If the subject is not in the AF frame, use AF/AE lock to take the picture (→P.26).
- ⚠ In dimly lit scenes where the subject is difficult to see using the LCD monitor, use the viewfinder to take the picture.

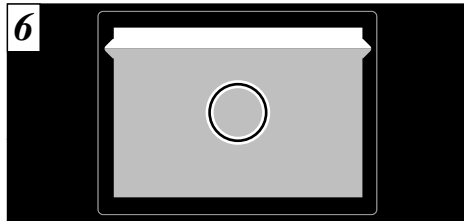

When you are using the viewfinder to take a picture at a distance of 0.8 to 1.5 m (2.6 to 4.9ft.), only the shaded area in the figure is photographed.

- ⚠ Shooting using LCD monitor is recommended when you want to do accurate adjustment of the range to be shot.
- ⚠ When the shot is taken, the date displayed on the LCD monitor disappears for roughly 3 seconds. The date cannot be displayed continuously.

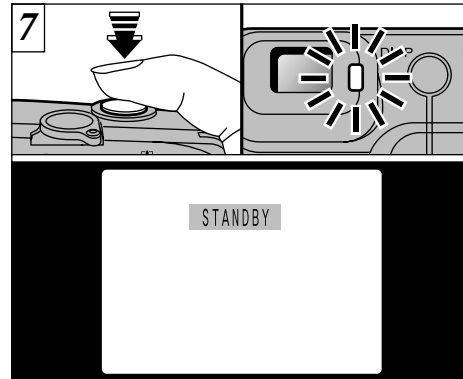

Press the shutter button down halfway. Image focusing is complete when "STANDBY" appears on the LCD monitor or the viewfinder lamp glows green.

- ⚠ The camera will not focus at distances of 80 cm (2.6ft.) or less even when "STANDBY" is displayed. In this situation, take the picture in "🌸" Macro Photography (→P.37).
- ⚠ If it is too dark for the camera to focus, move at least 1.5 m (4.9ft.) away from your subject before taking the picture.

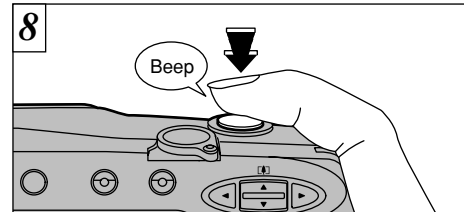

To take the picture, press the shutter button down fully without lifting your finger off it. The camera beeps and takes the picture, and the data is then recorded.

- ⚠ The viewfinder lamp flashes orange while the flash is charging.
- ⚠ Because the amount of image data recorded is not fixed and varies depending on the subject (level of image detail, etc.), the number of available shots may not decrease after the image is recorded, or may decrease by 2.
- ⚠ See P.74 for information on the warning displays.
- ⚠ The viewfinder lamp glows orange while the image is being recorded and no pictures can be taken. Do not switch the camera off or open the SmartMedia slot cover during data recording as this can cause the image data to be corrupted or lost.

## ◆ Viewfinder Lamp Display

Color	Status	Meaning
Green	Lit	Ready to shoot
	Flashing	AF/AE operating or camera shake/AF warning.
Orange	Lit	Image being recorded onto the SmartMedia.
	Flashing	Flash charging
Red	Flashing	<ul style="list-style-type: none"> <li>● The lens cover is not fully open.</li> <li>● SmartMedia warning No SmartMedia loaded, SmartMedia not formatted, incorrect format, write-protect sticker used, SmartMedia full, SmartMedia error.</li> <li>● Lens Operation error</li> </ul> <p>*When the LCD monitor is switched on, details of the warning are displayed on the monitor (➡P.74).</p>

## ◆ Subjects Not Suitable for Autofocus ◆

Though the FinePix2400 ZOOM uses an accurate autofocus mechanism, it may have difficulty focusing or not be able to focus at all for the types of subject and situation listed below. In such cases, the image may be out of focus.

- Very shiny subjects such as a mirror or car bodies.
- Subjects photographed through glass.
- Subjects that do not reflect well, such as hair or fur.
- Subjects with no substance, such as smoke or flames.
- When the subject is distant and dark.
- When there is very little contrast between the subject and the background (such as white walls or subjects dressed in the same color as the background).
- When there are objects in front of or behind the subject (such as an animal in a cage or a person in front of a tree).
- Subjects moving at high speed.

## Number of available frames

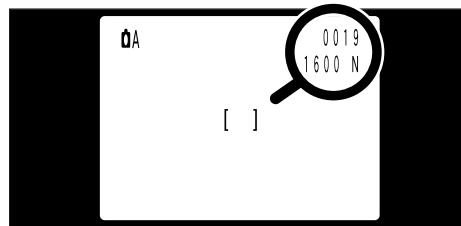

The number of remaining shots is shown on the LCD monitor (in the position shown in the figure at left).

- ! See P.36 for information on changing the File Size (number of pixels) and Quality (compression ratio) settings.
- ! At shipment, the default settings are NORMAL (for Quality) and 1600×1200 (for File Size).

■ **Standard number of shots per SmartMedia** : The number of shots that can be recorded onto a SmartMedia card varies slightly depending on the type of subject. Also, the difference between the standard number of shots and the actual number of available shots increases for SmartMedia with a higher capacity.

Pixel	1600 × 1200			1280 × 960		640 × 480
	FINE	NORMAL	BASIC	FINE	NORMAL	NORMAL
Quality Mode						
Compression Ratio	Approx.1/5	Approx.1/10	Approx.1/20	Approx.1/4	Approx.1/8	Approx.1/8
Image Data Size	Approx.760KB	Approx.390KB	Approx.200KB	Approx.610KB	Approx.310KB	Approx.90KB
4MB (MG-4S)	4	9	19	6	12	44
8MB (MG-8S)	10	19	39	12	24	89
16MB (MG-16S/SW)	20	39	75	25	49	164
32MB (MG-32S/SW)	41	79	152	50	99	330
64MB (MG-64S/SW)	82	159	306	101	198	663

## 📷 USING AF/AE LOCK



In a picture of this type, the subjects (people in this case) are outside the AF frame. If you take the picture at this point, the subjects will not be in focus.



Move the camera slightly so that only one of the subjects are shown in the AF frame.

### ◆ AF/AE Lock ◆

On the FinePix2400 ZOOM, when you press the shutter button down half way, the focus and exposure settings are fixed (AF/AE lock). If you want to focus on a subject that is off to one side of the image or if you want to set the exposure before you compose the final shot, lock the AF and AE settings and then compose and shoot your picture to get the best results.

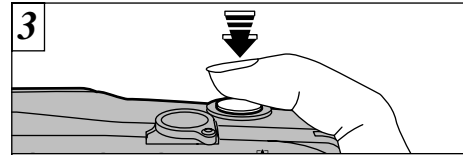

Press the shutter button down half way (AF/AE lock) and check that "STANDBY" is displayed on the LCD monitor (or that the green viewfinder lamp stops flashing and remains lit).

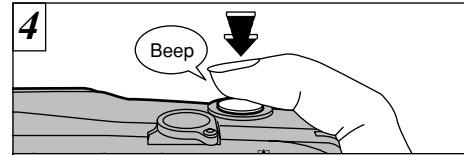

With the shutter button still held down halfway (AF/AE lock), move the camera back to the original image and press the shutter button down fully.

- ! You can use AF/AE lock as many times as you like before you release the shutter.
- ! AF/AE lock is available in all photography modes so you can get perfect results for every shot.

## ▶ VIEWING YOUR IMAGES (PLAYBACK)

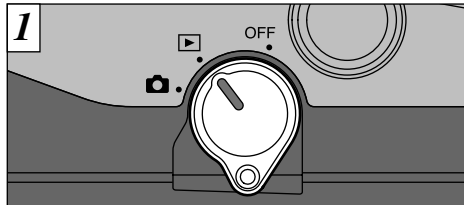

Set the Mode switch to "▶".

- When the Mode switch is set to "▶", the photographed image is displayed after you take the shot.
- When you close the lens cover, the lens automatically retracts.

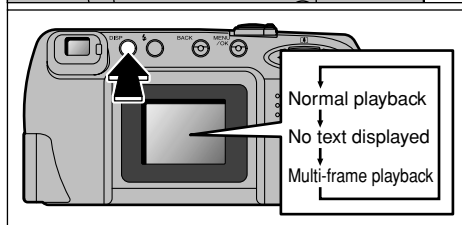
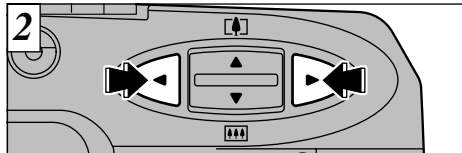

Use the "▶" button to view the next frame, and the "◀" button to view the previous frame. The LCD monitor display changes each time you press the "DISP" button.

- If image on the LCD monitor is difficult to see, adjust the LCD monitor brightness (➡P.62).

## ▶ PLAYBACK ZOOM

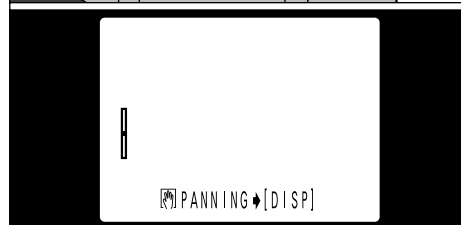
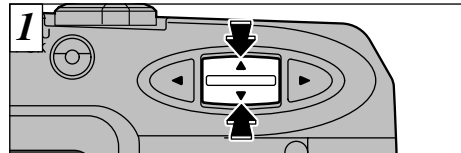

Pressing "▲" or "▼" during playback zooms (enlarges) the image.

- The maximum zoom magnification is 4.0X.
- Pressing the "◀" (or "▶") button during zooming cancels the zoom and displays the next (or previous) image.

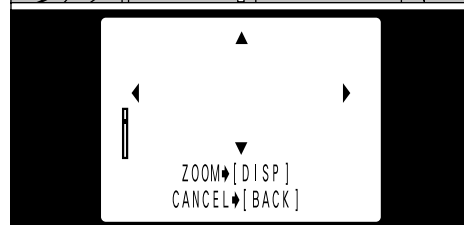
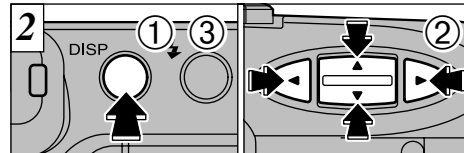

After you have zoomed in on your image,

- press the "DISP" button.
- You can use the "◀▶" and "▲▼" buttons to zoom in on different parts of the image.
- Press the "DISP" button again to revert to zoomed display.

- If you press the "BACK" or "MENU/OK" button, the image reverts to normal scale.

### ◆ Image That Can Be Viewed on the FinePix2400 ZOOM ◆

You can use this camera to View still image data recorded on a FinePix2400 ZOOM or still image data (excluding some uncompressed image data) recorded onto a 3.3V SmartMedia using a Fujifilm FinePix series, MX series or DX series digital camera.

## ▶ MULTI-FRAME PLAYBACK

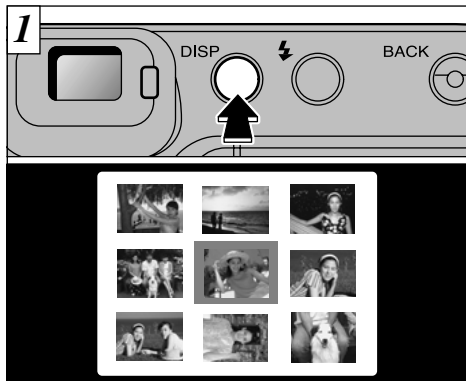

Pressing the “DISP” button twice switches to the multi-frame (9-frame) display.

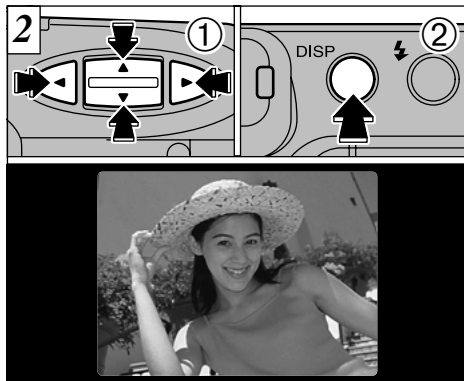

- ① Use the “◀” and “▶” buttons to move the cursor (the orange outline) to the desired frame. Pressing “▲” or “▼” repeatedly switches to the previous or next display.
- ② You can enlarge the selected image by pressing the “DISP” button again.

! Multi-frame playback cannot be used in the menu screens.

! The message shown on the LCD monitor multi-frame display disappears after about 3 seconds.

## ▶ → 🗑️ ERASING SINGLE FRAME

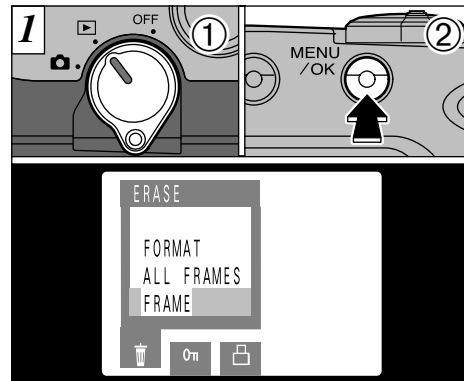

- ① Set the Mode switch to “▶”.
- ② Press the “MENU/OK” button to display the menu screen on the LCD monitor.

! See P.48-49 for more information on erasing all the frames on a SmartMedia and formatting SmartMedia.

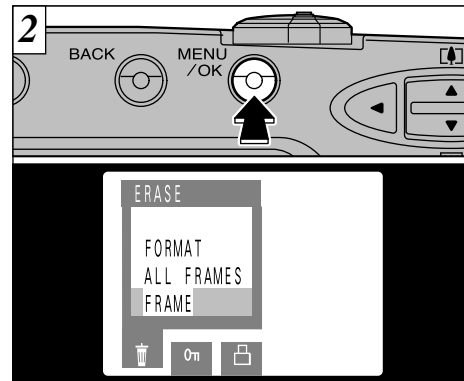

With “FRAME” selected, press the “MENU/OK” button.



## ▶ → 🗑️ ERASING SINGLE FRAME

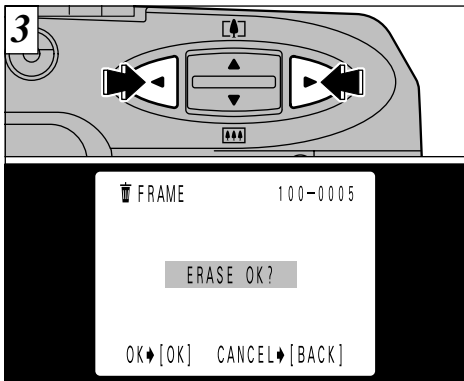

Use the “◀” and “▶” buttons to display the image to be erased.

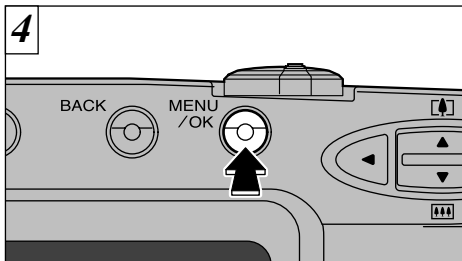

Press the “MENU/OK” button to erase the displayed image. When erasing is complete, the next image appears and the “ERASE OK?” message is displayed.

⚠️ If “PROTECTED FRAME” or “DPOF” is displayed, reset the respective settings.

To continue erasing image, repeat the procedure from step 3.

## 3 Advanced Features

## 📷 IN PHOTOGRAPHY MODE

The Advanced Photography section introduces a range of camera functions that you can access by setting the Mode switch to “📷”.

### ■ Photography mode specifications

Photography mode	Settings	Factory default
📷 A Auto	📷 Macro (→P.37) [ON/OFF] 📷 Continuous Shooting (→P.38) [ON/OFF] ⌚ Self Timer (→P.39) [ON/OFF]	OFF OFF OFF
📷 M Manual	📷 Macro (→P.37) [ON/OFF] 📷 Brightness (→P.41) [-0.9~+1.5] WB White Balance (→P.42) [AUTO / * / 🌞 / 🌙 / 1 / 2 / 3 / 🌠]	OFF 0 AUTO
⚡ Flash	[AUTO (no, icon) / 📷 / ⚡ / 📷 / ⚡]	AUTO
📷 Quality/File Size	1600 F, 1600 N, 1600 B 1280 F, 1280 N 640 N (F : FINE N : NORMAL B : BASIC)	1600 N



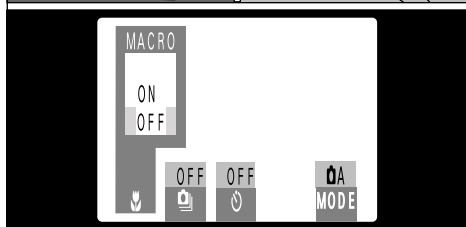
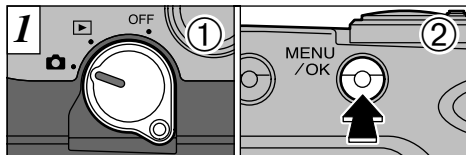

\* “⚡” Flash photography and “📷” continuous shooting cannot be used together.

⚠️ To cancel single-frame erase, press the “BACK” button to return to the menu. To exit the menu screen, press the “BACK” button again.

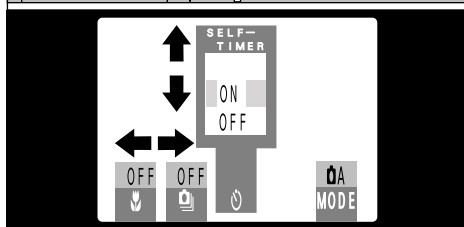
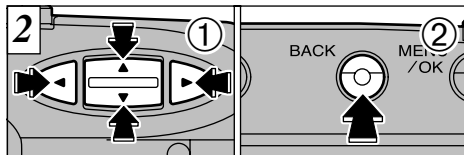



- ① Set the Mode switch to “”.
- ② Press the “MENU/OK” button to display the menu on the LCD monitor.



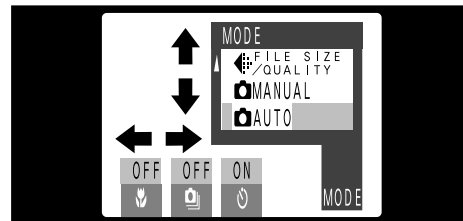

- ① Use the “” or “” button to select the menu item and then use the “”/“” button to change the setting.
- ② Press the “BACK” button to return to the photography screen.

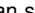

In this menu, you can select the “A”, “M” or “SET” mode, or the “” file size/quality setting.



### A AUTO

This is the simplest mode to use and has a wide range of applications. (⇒ P.20)

\*You can specify the  (⇒ P.37),  (⇒ P.38), and  (⇒ P.39) settings.

### M MANUAL

This mode allows you to take pictures using combinations of different menu settings.

\*In MANUAL mode, you can select the  (⇒ P.37),  (⇒ P.41), and  (⇒ P.42) settings.

\*Each time you press the “DISP” button in  M mode, the display mode moves one step in the cycle from “Text + Video” ⇒ “Video only” ⇒ “Text only”.

### FILE SIZE/QUALITY

This mode allows you to set the “FILE SIZE/QUALITY” setting (⇒ P.36).

### SET-UP

This mode allows you to change the photography settings (⇒ P.59).

You can select any combination of 3 file sizes (numbers of pixels) and 3 quality (compression ratio) settings. Select the combination that best suits your aims.

#### To get high-quality prints

Use the largest available file size (1600 × 1200) and a low compression ratio (FINE or NORMAL). However, because this increases the amount of data in each frame, the number of remaining shots decreases.

#### For images to be used on the Internet

These images are intended to be viewed on a personal computer screen, so you should use a small file size (640 × 480). Because this reduces the amount of data used for each frame, the number of remaining shots increases.

#### Quality (compression ratio)

Choose “FINE” for better image quality or “BASIC” to increase the number of available shots. In most cases, the “NORMAL” setting provides more than adequate image quality.

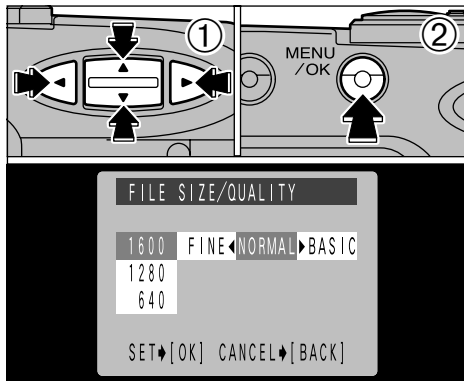

- ① Use the “▲▼” button to change the file size setting, and then use the “◀” or “▶” button to change the quality setting.
- ② Press “MENU/OK” to confirm the settings.

⚠ There are 6 combinations of file size and quality settings in total (→ P.25).

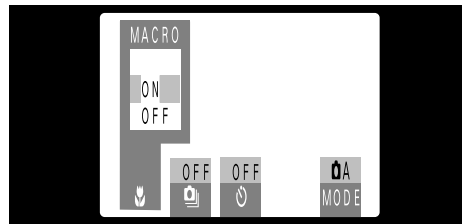

You can select “**A**” or “**M**” as the photography mode. When you select “ON”, the lens automatically zooms out fully (∞) for Macro mode photography.

In Macro (close-up) photography, you can take pictures of subjects at distances of between 10cm (3.9in.) and 80cm (31.5in.) from the camera.

Also, set the flash functions according to the given circumstances (→ P.43).

- ⚠ When shooting in dark conditions, use a tripod to prevent camera shake.
- ⚠ If you are using the flash, ensure that you are at least 20 cm (7.9 in.) from the subject.
- ⚠ You cannot use the optical zoom in Macro Photography, but using the digital telephoto is possible (→ P.46).
- ⚠ Macro Photography is cancelled when you switch the camera off.

If you use the viewfinder to take a picture in Macro Photography, the field visible through the viewfinder does not match the field actually photographed because the viewfinder and lens are in different positions. For this reason, you should use the LCD monitor to take pictures in Macro Photography. The LCD monitor does not switch off in Macro Photography.

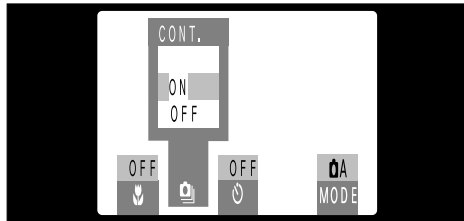

This setting can be specified when the photography mode is set to "A".

When you set this mode to "ON", the file size is automatically fixed at "640". The camera continues shooting for as long as you hold down the shutter button.

● **Continuous shooting specifications**

Frames shot per second: Up to 1.5

No. of continuous shots: 9

File size : Fixed at 640X480 pixels

- ⚠ You cannot use continuous shooting when the LCD monitor is switched off.
- ⚠ You cannot use the flash or digital telephoto during continuous shooting.
- ⚠ The focus and exposure are fixed at the values selected when the shutter button was pressed.
- ⚠ When the self-timer is used to take pictures, 9-frame photography is used.
- ⚠ Switching the camera off cancels continuous shooting.

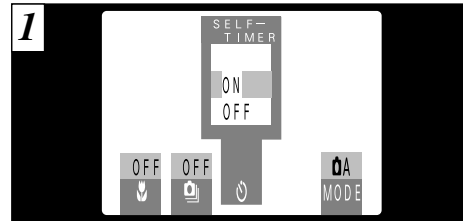

This setting can be specified when the photography mode is set to "A".

Use the "◀▶" buttons to select "SELF-TIMER" and then select "ON" with the "▲▼" button to switch the camera to self-timer photography.

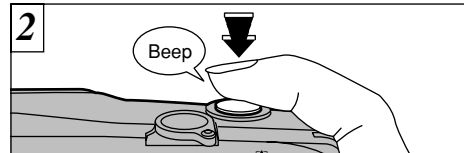

Position the AF frame over the subject and press the shutter button. The camera focuses on the subject in the frame and self-timer starts to run.

- ⚠ You can also use AF/AE lock in this mode (→P.26).
- ⚠ Be careful not to stand in front of the camera when you press the shutter button since this can cause focusing or light metering errors.

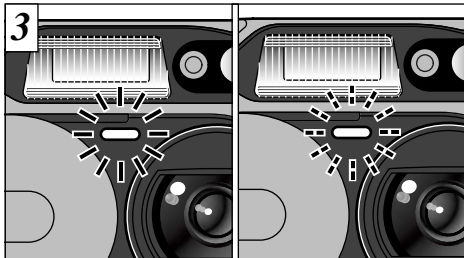

The self-timer lamp lights for 5 seconds, blinks for 5 seconds, then takes the picture.

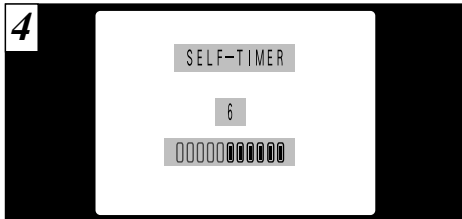

The time remaining until the picture is taken is counted down on the LCD monitor.

- ⚠ Self-timer mode is cancelled after you take the picture.
- ⚠ To stop the self-timer, once it has started running, press the "BACK" button.

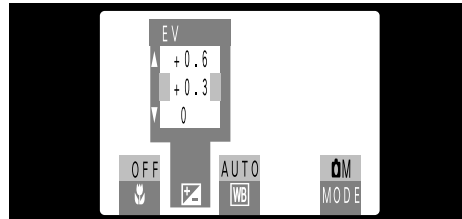

This setting can be specified when the photography mode is set to "CAM". Use the Brightness setting to obtain the optimum image brightness (exposure) when the subject is much brighter or darker than the background.

- There are 9 compensation levels (−0.9 to +1.5 EV in approx. +0.3 EV increments). See P.68 for a definition of EV.
- ⚠ The Brightness setting is disabled in the following situations:
  - When the flash is used in Auto or Red-Eye Reduction mode
  - When dark scenes are shot in Forced Flash mode

#### ◆ Subjects for Which Exposure Adjustment is Particularly Effective ◆

##### Positive (+) Compensation

- Copying of printed text (black characters on white paper) (+1.5 EV)
- Backlit portraits (+0.6 to +1.5 EV)
- Very bright scenes (such as snowfields and highly reflective subjects) (+0.9 EV)
- Shots made up predominantly of the sky. (+0.9 EV)

##### Negative (−) Compensation

- Spotlight subjects, particularly against dark backgrounds (−0.6 EV)
- Copying of printed text (white characters on black paper) (−0.6 EV)
- Scenes with low reflectivity, such as shots of pine trees or dark foliage (−0.6 EV)

\* Settings given in parentheses are a general guide.

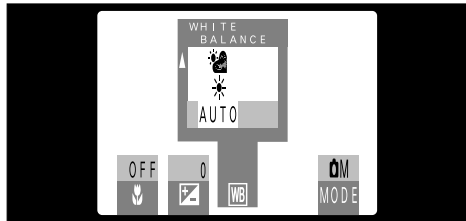

This setting can be specified when the photography mode is set to “M”.

Change the white balance setting when you want to take a picture with the white balance fixed for the surroundings and lighting when the picture is taken.

In Auto mode, the correct white balance may not be obtained for subjects such as close-ups of people's faces and shots taken under a special light source. In such situations, select the correct white balance for the light source. See P.68 for more information on the white balance.

**AUTO** : Automatic adjustment  
(Shooting to show the ambience of the light source)

- : Shooting outdoors in fine weather
- : Shooting in shade
- : Shooting under “Daylight” fluorescent lamps
- : Shooting under “Warm White” fluorescent lamps
- : Shooting under “Cool White” fluorescent lamps
- : Shooting in incandescent light

\* The White Balance setting is disabled when you use the flash. If you want to use the White Balance setting to achieve a particular effect, set the flash mode to Suppressed Flash.

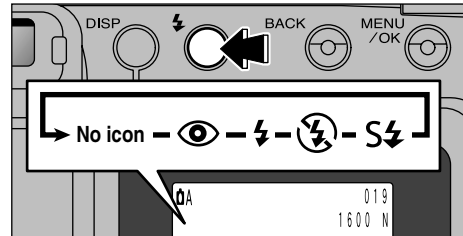

You can choose from 5 flash modes to suit your shot. Each time you press the “⚡” flash button, the flash mode shown on the LCD monitor changes from Auto flash (no icon displayed) to “👁️” to “⚡” to “⚡/” to “⚡/⚡”. The last mode displayed is the selected mode.

#### ● Flash range

Wide-angle : 0.2m to 3.0m (7.9in.-9.8ft.)

Telephoto : 0.8m to 3.0m (2.6ft.-9.8ft.)

⚠ When the flash mode is set to Suppressed Flash, the camera becomes ready to shoot more quickly after you switch it on.

⚠ If you switch from Suppressed Flash mode to another flash mode, you may find that the displayed image disappears and the screen goes dark because the flash is charging. When this happens, the viewfinder lamp flashes orange.



#### Auto Flash (no icon)

Use this mode for ordinary photography. The flash fires automatically as required by the conditions.

## ⚡ USING THE FLASH



### 👁️ Red-Eye Reduction

Use this mode to ensure that the subject's eyes appear natural when photographing people in low-light conditions.

The flash fires a pre-flash just before the picture is taken and then fires again to take the actual picture.



### ⚡ Forced Flash

Use this flash mode to photograph backlit scenes, such as a subject against a window or in the shade of a tree, or to obtain the correct colors when you are shooting under lighting such as fluorescent tubes. In this mode, the flash fires in bright as well as dark conditions.

### ◆ Red-Eye Effect ◆

When you use the flash to photograph people in low-light conditions, their eyes sometimes appear red in the picture. This is caused by the light of the flash reflecting off the inside of the eye. Use Red-Eye Reduction flash mode to effectively minimize the likelihood of the red-eye effect.

Take the following measures also to make Red-Eye Reduction mode more effective:

- Get the subjects to look at the camera.
- Get as close as possible to the subjects.



### 🚫 Suppressed Flash

In this mode, the flash never fires.

Use this mode when you are taking pictures in indoor lighting at distances too great for the flash to have any effect, such as theater performances or indoor sporting events. When you use Suppressed Flash, the Auto White Balance function (➡P.68) operates so that natural colors are captured along with the ambience of the available light.

- ! If you want to take a picture in low-light conditions with the flash mode set to Suppressed Flash, you should use a tripod to prevent camera shake.
- ! See P.24 and P.75 for information on the camera shake warning.



### ⚡ Night Scenes (Slow Synchro)

This mode allows you to use the flash with a slow shutter speed.

This mode allows you to take beautiful pictures that show your subject and still capture the background.

- ! Because slow shutter speeds are used, you should use a tripod to prevent camera shake.

## 📷 USING THE DIGITAL TELEPHOTO

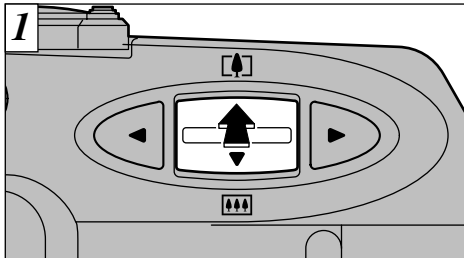

Digital telephoto photography allows you to enlarge the central portion of the image by 2.5X. Digital telephoto photography can only be used for images shot using the LCD monitor that have a file size setting of "1280" "640".

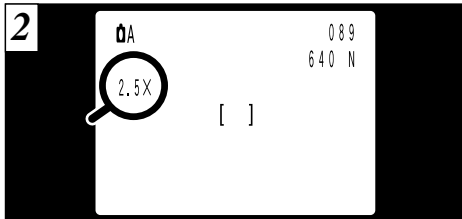

If you continue using the optical zoom and press the "▲▼" button again to select telephoto (📷), the Mode switches to digital zoom photography. Pressing "▲" zooms in and displays the enlargement scale on the LCD monitor. Press "▼" to return to the previous level.

"640" : No digital telephoto ⇔ 1.3X ⇔ 2.5X

"1280" : No digital telephoto ⇔ 1.3X

- 🔧 See P.21 for more information on using the optical zoom.
- 🔧 In Macro Photography, due to the optical zoom fixed to the wide-angle setting, pressing the telephoto side (📷 side) of the "▲▼" button switches the camera to digital telephoto.

## 4 Advanced Features Playback

## ▶ ADVANCED PLAYBACK

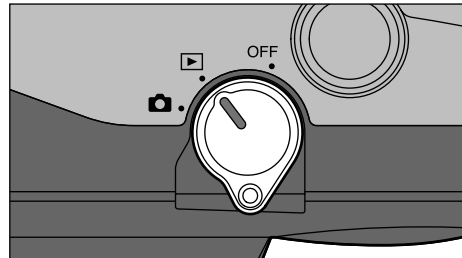

This section introduces a range of functions that you can access when the Mode switch is set to "▶". The explanations below all presuppose that the Mode switch is set to "▶".

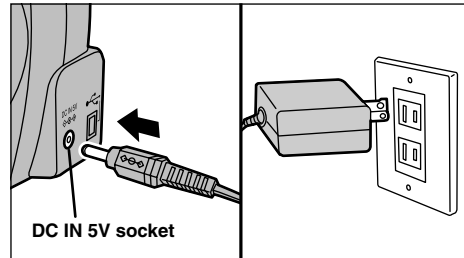

If there is a power socket handy, use the special AC Power Adapter AC-5V/AC-5VH (sold separately) so there is no need to worry about the batteries running out during playback (➡P.13, 66).

- 🔧 The shapes of the plug and socket-outlet depends on the country of use.



**ERASING SINGLE-FRAME**

Erases only the selected image.

- ! You cannot use this function to erase protected images (⇒P.50, 52) or images with DPOF settings (⇒P.56, 58).

**ERASE ALL**

Erases all the images.

- ! You cannot use this function to erase protected images or images with DPOF settings.

**FORMAT**

Erases all the data and reformats (initializes) the SmartMedia for use with this camera.

- ! Formatting also erases protected images and images with DPOF settings.

- ! If the “**CARD ERROR**” message appears, wipe the contact surfaces on the SmartMedia (the gold-colored area) with a soft, dry cloth and then re-insert it into the camera.

If this does not resolve the problem, format the card.

- ! If the “**CARD NOT INITIALIZED**” message is displayed, format the card.

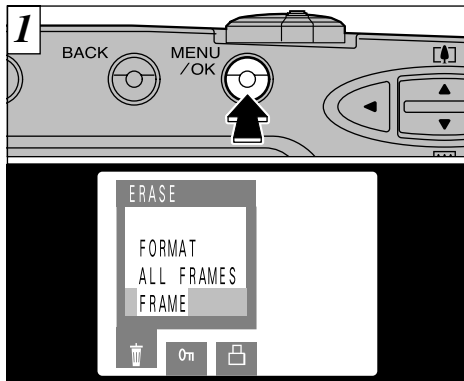

If you press the “MENU/OK” button, the menu screen will appear on the LCD monitor.

- ! Press the “BACK” button to exit the menu display.

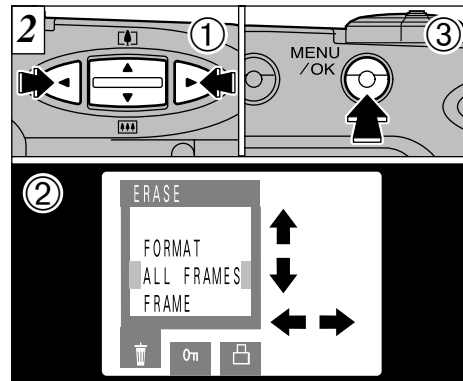

- ① Use the “◀” or “▶” button to select “ ERASE”.
- ② Use the “▲▼” button to select “FRAME”, “ALL FRAMES” or “FORMAT”.
- ③ Press the “MENU/OK” button.

Formatting erases all of the data on the SmartMedia.

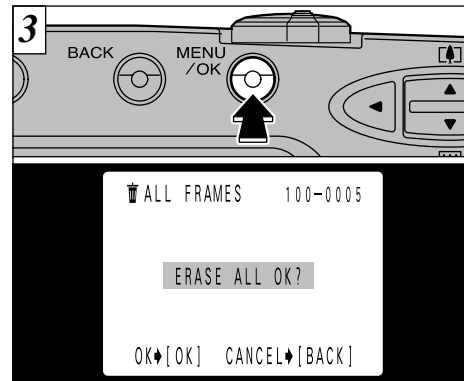

A confirmation screen appears.

If you are erasing all the frames or formatting the card, press the “MENU/OK” button to proceed. If you are erasing one frame, use the “◀” and “▶” buttons to select the frame and then press the “MENU/OK” button.

- ! To cancel single frame erase, all-frame erase or media formatting, press the “BACK” button.
- ! If “**PROTECTED FRAME**” or “**DPOF**” is displayed, reset the respective settings.

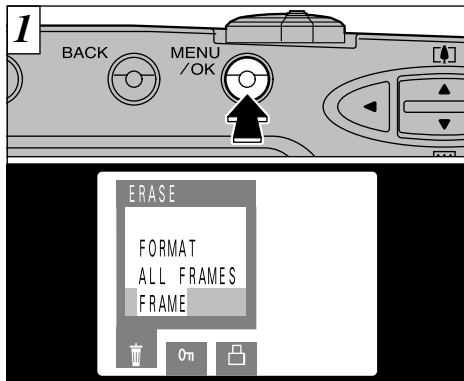

Press the “MENU/OK” button to display the menu on the LCD monitor.

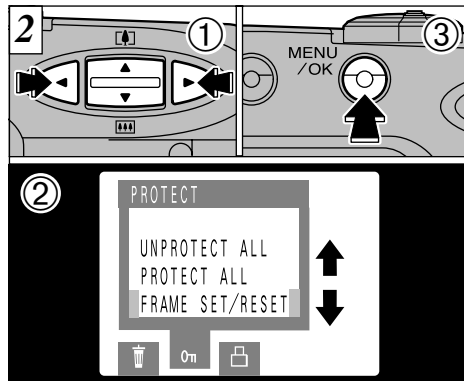

- ① Use the “◀” or “▶” button to select “ PROTECT”.
- ② Use the “▲▼” button to select “FRAME SET/RESET”.
- ③ Press the “MENU/OK” button.

“PROTECT” is a setting that prevents images from being accidentally erased. However, the FORMAT function erases all stored images, including protected images (⇒P.48).

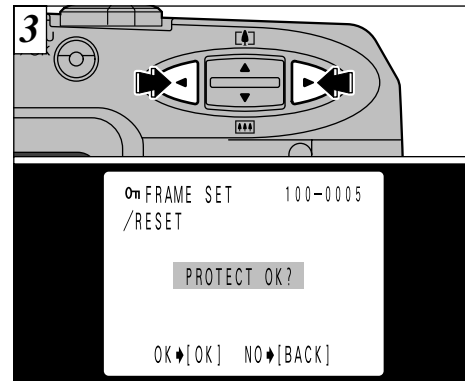

Use the “◀” or “▶” button to select the image to be protected.

⚠ Press the “BACK” button to cancel the protection process and return to the menu. To exit the menu, press the “BACK” button again.

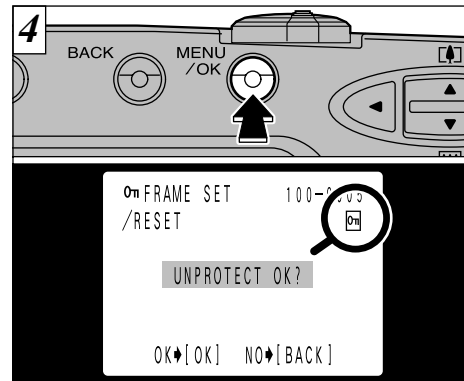

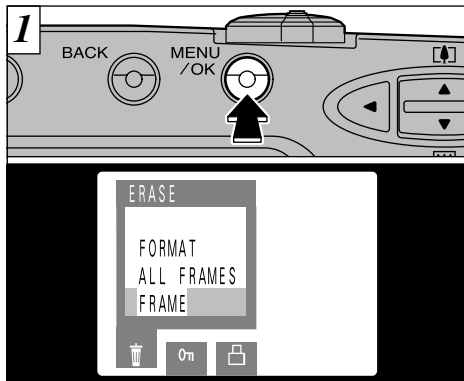

When the “MENU/OK” button is pressed, the image is protected and the “” icon appears on the right of the screen. To remove the protection, press the “MENU/OK” button again.

To protect another image, repeat the procedure from step 3.

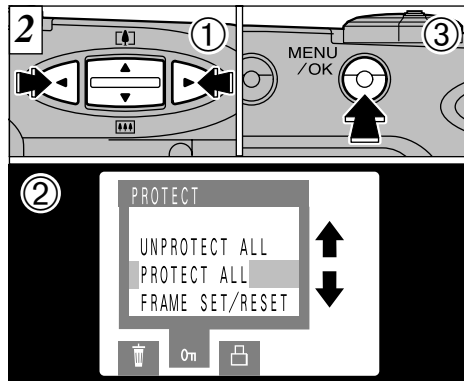

Press the “MENU/OK” button to display the menu on the LCD monitor.



- ① Use the “◀” or “▶” button to select “ PROTECT”.
- ② Use the “▲▼” button to select “PROTECT ALL” or “UNPROTECT ALL”.
- ③ Press “MENU/OK” button.

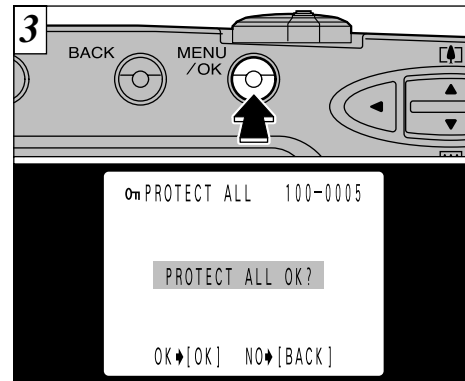

A confirmation screen will appear to proceed, press the “MENU/OK” button.

- ! Press the “BACK” button to cancel the protection process and return to the menu. To exit the menu, press the “BACK” button again.



With the FinePix2400 ZOOM, you can order prints using the Digital Print Order Format (DPOF).

You can use the DPOF to specify the following:

- The frames to be printed and the number of prints for each frame
- Imprinting of the date and time

This section gives a detailed description of how to order your prints with the FinePix2400 ZOOM.

- \* Note that some printers do not support date and time imprinting or specification of the number of prints.
- \* Note that the warnings shown below may be displayed while you are specifying the prints.

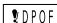
 (⇒P.74)

Reset the DPOF settings.

 (⇒P.75)

If you load a SmartMedia that contains frames specified for printing on another camera, those print specifications are all reset and replaced by the new print specifications.

 (⇒P.75)

No more than 999 prints can be specified on the same SmartMedia.

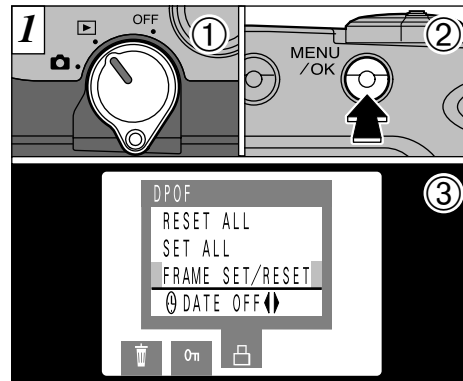

This function allows you to select whether or not the date of shooting is included on the print.

- ① Set the Mode Switch to “OFF”.
- ② Press the “MENU/OK” button to display the menu on the LCD monitor.
- ③ Press “◀▶” buttons to select “DPOF”.

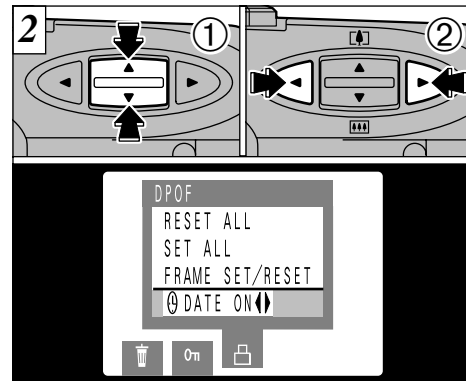

- ① Select “DATE”.
- ② Press “◀” or “▶” button to specify “DATE ON” or “DATE OFF”. This setting is then valid for all the prints until the setting is changed.

 Before specifying any other settings, first specify whether date is to be shown or not.

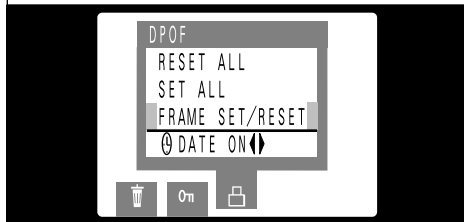
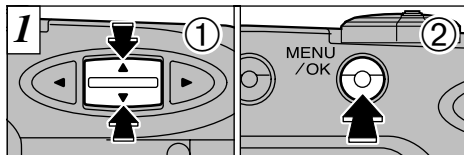

- ① Use the “▲▼” button to select “FRAME SET/RESET”.
- ② Press the “MENU/OK” button.

- ⚠ Always select whether or not to print the date or time before specifying the DPOF setting.
- ⚠ If you use “FRAME SET” and then use “SET ALL”, the number of prints specification in “FRAME SET” is cancelled.

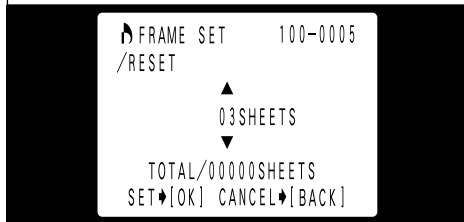
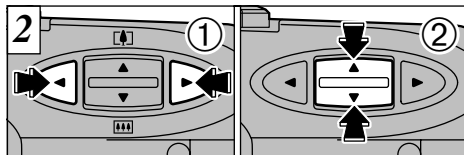

- ① Use the “◀” or “▶” button to display the frame for which you want to specify DPOF settings.
- ② Use the “▲▼” button to specify the number of prints.
  - ⚠ If you do not want a print of the frame, reset the number of prints to “00”
  - ⚠ The setting is not saved until you press the “◀” or “▶” button to move to another frame or press the “MENU/OK” button.
  - ⚠ You can specify up to 99 prints for each frame. Prints can be specified for up to 999 frames on the same SmartMedia.

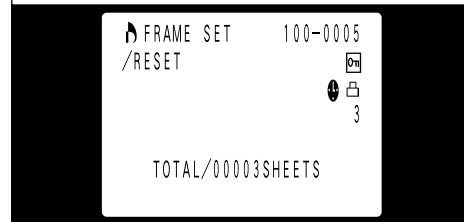
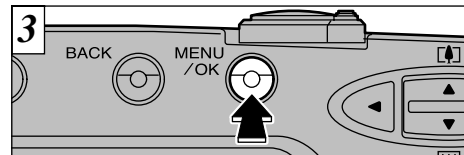
**<To Continue>**

When you have completed the settings, always press the “MENU/OK” button to confirm the settings. The total number of prints is displayed on the LCD monitor and then the menu screen reappears. The “☐” icon and the number of prints are displayed for frames with DPOF specifications and the “🕒” icon is also displayed if the date is set.

- ⚠ “TOTAL” shows the total number of prints specified.

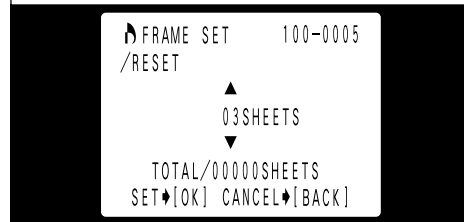
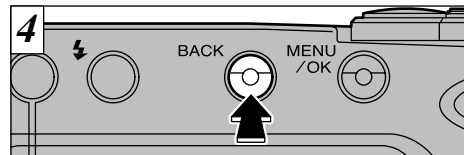
**<To Cancel>**

Pressing the “BACK” button cancels only the settings for the currently selected frame. The settings for other frames are not cancelled.

To use “FRAME SET/RESET” again, repeat the procedure from step 2.

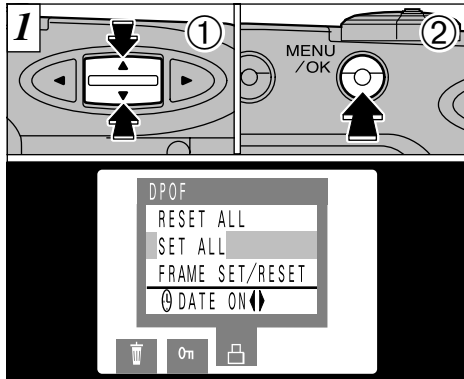

① Use the “▲▼” button to select “SET ALL” or “RESET ALL”.

② Press the “MENU/OK” button.

- ! “SET ALL” specifies 1 print for all the images.
- ! Selecting this setting deletes any settings specified using “FRAME SET”.
- ! Prints can be specified for up to 999 frames on the same SmartMedia. If you specify more than 1000 frames, the “DPOF FILE ERROR” warning appears.

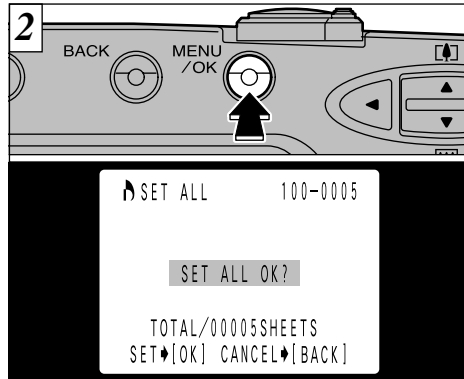

A confirmation screen appears. To continue, press the “MENU/OK” button.

The total number of prints is displayed on the LCD monitor and then the menu screen reappears.

- ! “TOTAL” shows the total number of prints specified.
- ! If you cancel all the frames, the “TOTAL” display reverts to “00000”.



▶ The table below explains the camera setting.

Settings	Display	Factory default	Explanation
END	OK	—	Exits set-up.
BEEP	HIGH/LOW/OFF	HIGH	Selects the buzzer volume for camera operation. When this is set to OFF, the camera buzzer emits no sound.
DATE/TIME	OK	—	Sets the date and time (⇒P.18).
FRAME NO.	RENEW/CONT.	RENEW	Specifies whether the FRAME NO. Memory function is used (⇒P.61).
LANGUAGE	ENGLISH/ FRANÇAIS	ENGLISH	Select English or French as the language used for screen display.

\*See the following page for information on using the settings.

## SET SET-UP MODE

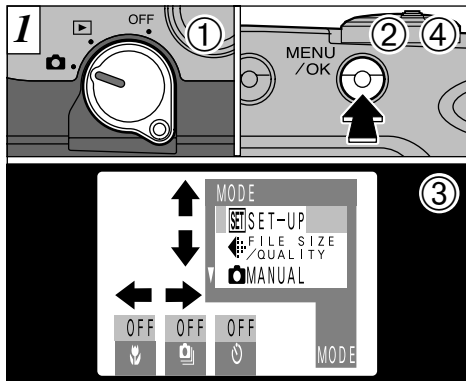

Use the following procedure to display the SET-UP screen.

- ① Check that the lens cover is open and then set the Mode switch to "CAMERA".
- ② When you press the "MENU/OK" button, the menu screen appears.
- ③ Use the "◀" and "▶" buttons to select MODE and then use the "▲▼" button to select "SET-UP".
- ④ Press the "MENU/OK" button to switch to the SET-UP screen.

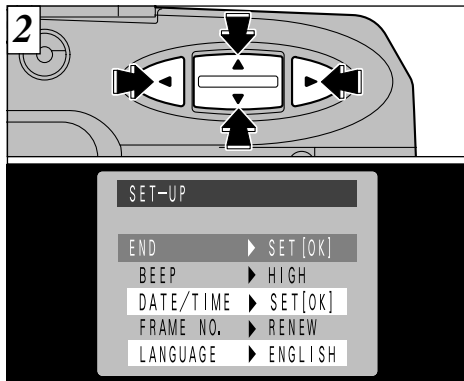

Use the "▲▼" button to select the desired item and then use the "◀" and "▶" buttons to change and confirm the setting (excluding the date and time settings).

To exit the SET-UP menu, select END and press the "MENU/OK" button. The photography screen reappears.

## FRAME NO. Memory

	<RENEW>	<CONT>
A	0001 ⋮ 0005	0001 ⋮ 0005
B	0001 ⋮ 0005	0006 ⋮ 0010

\* Formatted SmartMedia used for both A and B.

**RENEW** : Pictures are stored on each SmartMedia beginning with a file number "0001".

**CONT** : Pictures are stored beginning from the highest file number stored on the last SmartMedia used.

Setting this function to "CONT" makes file management easier as it ensures that file names are not duplicated when images are downloaded to a PC.

⚠ If the SmartMedia already contains image files with file numbers higher than the highest file number on the last SmartMedia, images are stored beginning from the highest file number on the current SmartMedia.

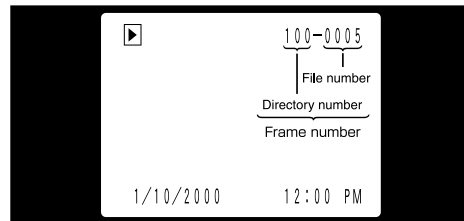

You can check the file number by viewing the image. The last 4 digits of the 7-digit number displayed in the top-right corner of the screen show the file number. The first 3 digits show the directory number.

⚠ When replacing the SmartMedia, always switch the camera off before you open the slot cover. If you open the slot cover while the camera is still switched on, the FRAME NO. (frame number memory) function will not operate.

⚠ File numbers run from 0001 to 9999. Once 9999 is exceeded, the directory number goes up by 1. The maximum number is 999-9999.

⚠ If you take a picture with FRAME NO. (frame number memory) set to RENEW, the stored "Last file No." setting is reset.

⚠ The frame number display for images shot on other cameras may differ.

## ADJUSTING THE LCD MONITOR BRIGHTNESS

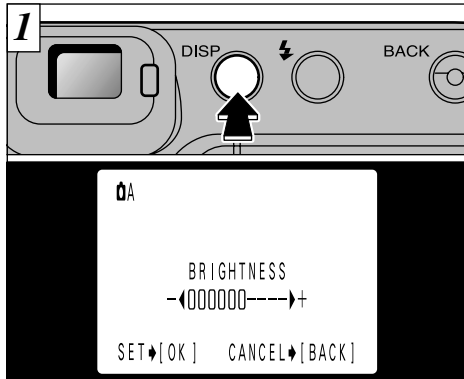

If you hold down the "DISP" button for about 2 seconds, the brightness adjustment screen appears.

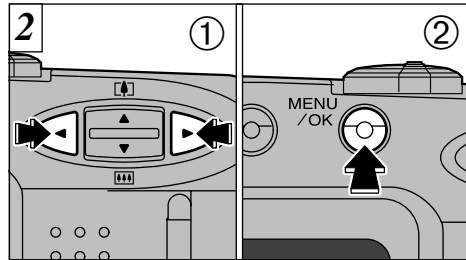

- ① Use the "◀" and "▶" buttons to adjust the brightness.
- ② Press the "MENU/OK" button.

! To exit this procedure without changing the settings, press the "BACK" button.

## System Expansion Options

► By using the FinePix2400 ZOOM together with other optional Fujifilm products, your system can be expanded to fill a wide range of uses.

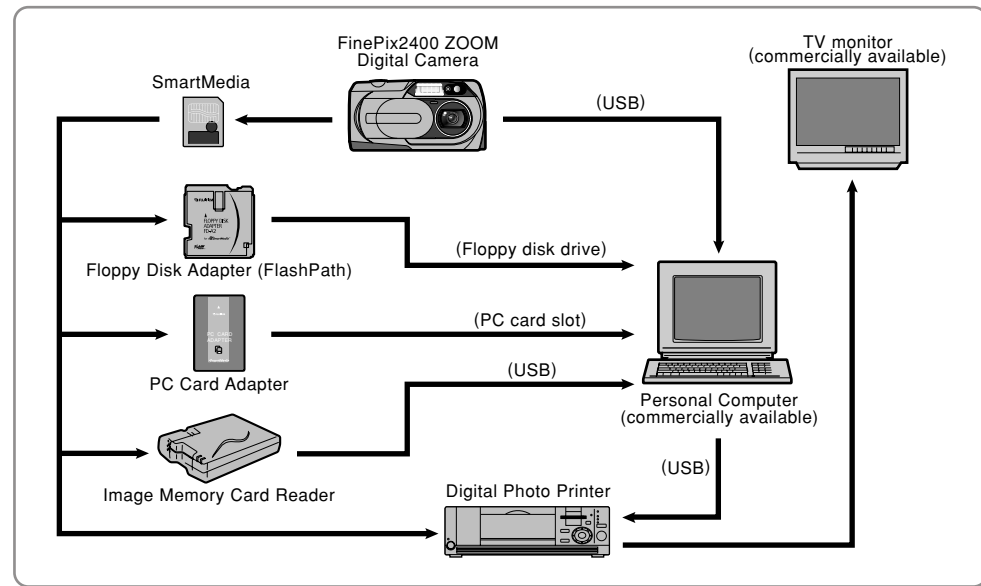

! When the LCD monitor is switched off and no text is displayed in Photography mode (→P.20, 28), the setting cannot be changed.



## Using the USB Interface Set

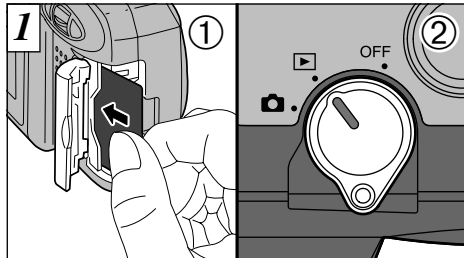

- ① Check that the camera is switched off and then load the SmartMedia (→P.14).
- ② Set the Mode switch to "OFF".

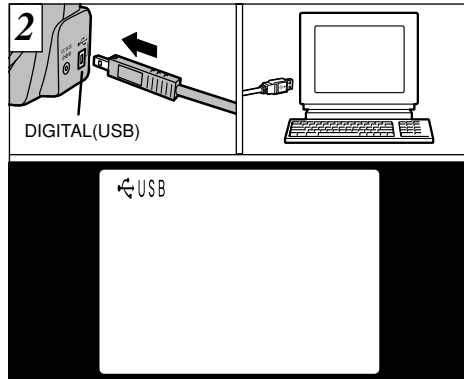

Insert the small plug on the end of the special USB cable into the digital (USB) socket on the camera and then plug the other end of the cable into the USB socket on your PC.

When you switch the PC on, "USB" appears in the upper left corner of the LCD monitor.

- ! Use only the special USB cable provided.
- ! Refer to the Quick Start Guide provided with the enclosed USB Interface Set for information on installing and using the software.

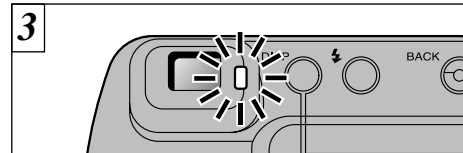

When the viewfinder lamp is lit or blinking orange, data access (downloading) is in progress. Never open the slot cover or disconnect the cable during data access as this could prevent data downloading and may cause camera malfunctions.

### Replacing SmartMedia™

- **On Windows 98**  
Check that the viewfinder lamp is green and replace the SmartMedia.
- **On Windows 2000 Professional**  
Check that the viewfinder lamp is green. Then click on the Eject button in the taskbar and replace the media.
- **On a Macintosh**  
Check that the viewfinder lamp is green. Then drag the removable disk icon on the desktop to the Trash and replace the media.

- ! Opening the slot cover switches the camera off. Switch the camera back on after you have replaced the SmartMedia.

## Accessories Guide

►The optional accessories (sold separately) can make taking pictures with the FinePix2400 ZOOM even easier. For information on how to attach and use the accessories, refer to the instructions provided with the accessory used.

### ● SmartMedia™

These are separately available SmartMedia cards.

Use the following SmartMedia:

● MG-4S : 4MB, 3.3V      ● MG-8S : 8MB, 3.3V      ● MG-16S/SW : 16MB, 3.3V

● MG-32S/SW : 32MB, 3.3V      ● MG-64S/SW : 64MB, 3.3V

\* Some 3.3V SmartMedia are labelled as "3V" or "ID" cards.

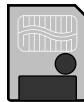

### ● AC Power Adapter AC-5V/AC-5VH

Use the AC-5V/AC-5VH when taking pictures for a long period of time or when the FinePix2400 ZOOM is connected to a personal computer.

\* The Shapes of the AC power adapter, the plug and socket outlet depend on the country.

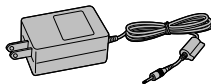

### ● Fujifilm Rechargeable Battery 2HR-3UF

The 2HR-3UF includes 2 pieces of high-capacity AA-size Nickel Metal Hydride batteries.

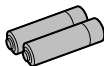

### ● Fujifilm Rechargeable Battery 4KR-3UF

The 4KR-3UF includes 4 pieces of high-capacity AA-size Ni-Cd batteries.

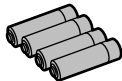

### ● Fujifilm Battery charger with Battery BK-NH (AC 220V only)

The BK-NH includes the quick battery charger BCH-NH and 2 Ni-MH batteries.

The BCH-NH can charge 2 Ni-MH batteries in approximately 110 minutes.

Up to 4 Ni-MH or Ni-Cd batteries can be charged simultaneously.

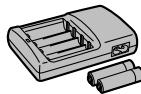

## Accessories Guide

### ● Floppy Disk Adapter (FlashPath)

This adapter is the same size and shape as a 3.5-inch floppy disk. You can copy the images on a SmartMedia to your PC simply by loading the SmartMedia into the floppy disk adapter and then inserting the adapter into your floppy disk drive.

	Compatible OS	Compatible SmartMedia
FD-A1/A1S/A1N	Windows95/98, NT 4.0	5V/3.3V, 2MB to 32MB
FD-A2	Macintosh	5V/3.3V, 2MB to 64MB



### ● PC Card Adapter

The PC Card Adapter allows the SmartMedia to be used as a PC Card Standard ATA-compliant (PCMCIA 2.1) PC card (Type II).

● PC-AD2 : Compatible with SmartMedia of 5V/3.3V, 2MB to 8MB.

● PC-AD3 : Compatible with SmartMedia of 5V/3.3V, 2MB to 64MB.



### ● SM-R1/R2 Image Memory Card Reader

The SM-R1/R2 allows images to very easily be read and written from an image memory card (SmartMedia) to a personal computer. Its USB interface provides high-speed data transmission.

● Windows98 or Power Macintosh with USB interface.

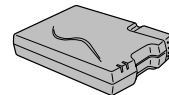

### ● SC-FX4 Soft Case

This case can be used when carrying the camera to protect it from dust, dirt and mild impacts.

## Explanation of Terms

---

- AF/AE Lock:** On this camera, pressing the shutter button down halfway locks the exposure settings (AF/AE lock). If you want to change the composition of your shot after you set the exposure, you can get excellent results by using AF/AE lock before you compose your shot and take the picture.
- Auto Power Off Function:** If the camera is not used in any way for two minutes or more, the Auto Power Off function switches the camera off. This is to prevent battery depletion and to avoid wasting power when the camera is connected to the AC power adapter. Auto Power Off does not operate when the Auto Power Off function is disabled or a USB connection is used.
- DPOF:** Digital Print Order Format  
DPOF is a format used for recording information on a storage media (image memory card, etc.) that allows you to specify which of the frames shot using a digital camera are printed and how many prints are made of each image.
- EV:** A number that denotes exposure. The EV is determined by the brightness of the subject and sensitivity (speed) of the film or CCD. The number is larger for bright subjects and smaller for dark subjects. As the brightness of the subject changes, a digital camera maintains the amount of light hitting the CCD at a constant level by adjusting the aperture and shutter speed. When the amount of light striking the CCD doubles, the EV increases by 1. Likewise, when the light is halved, the EV decreases by 1.
- JPEG:** Joint Photographics Experts Group  
A file format used for compressing and saving color images. The compression ratio can be selected, but the higher the compression ratio, the poorer the quality of the expanded image.
- White Balance:** Regardless of the type of lighting, the human eye adapts so that a white object still looks white. On the other hand, devices such as digital still cameras register a white subject as white by first adjusting their internal color balance to match the color of the ambient light around the subject. This adjustment process is referred to as matching the white balance. A function that automatically matches the white balance is called **an auto white balance function**.

## Notes on Using Your Camera Correctly

---

► Be sure to read this information in conjunction with before you use this product “Safety Notes” (→P.80) to ensure that you use your camera correctly.

### ■ Places to Avoid

Do not store or use the camera in the following types of locations:

- Very humid, dirty or dusty places
- In direct sunlight or in places subject to extreme temperature rises, such as in a closed car in summer. Extremely cold places
- Places subject to strong vibrations
- Places affected by smoke or steam
- Places subject to strong magnetic fields (such as places near motors, transformers or magnets)
- For long periods in contact with chemicals such as pesticides or next to rubber or vinyl products

### ■ Do not expose the camera to sand.

The FinePix2400 ZOOM is particularly and adversely affected by sand. In sandy locations such as beaches or deserts, or in locations where there is wind borne sand, ensure that the camera is not exposed to sand. This can cause faults that may be irreparable.

### ■ Notes on Condensation

If the camera is carried suddenly from a cold location into a warm place, water droplets (condensation) may form on the inside of the camera or on the lens. When the viewfinder lamp is lit orange or flashing orange, this indicates that data access is in progress. Condensation

may also form on the SmartMedia card. In this event, remove the SmartMedia and wait a short time before using it again.

### ■ When the Camera is Unused for Long Periods

If you do not intend to use the camera for a long period, of time remove the batteries and the SmartMedia card before storing the camera.

### ■ Cleaning Your Camera

- Use a blower brush to remove dust from the lens and LCD surface and then wipe lightly with a soft, dry cloth. If any soiling remains, apply a small amount of lens cleaning liquid to a piece of lens cleaning paper and wipe gently.
- Do not scratch hard objects against the lens, LCD monitor screen or viewfinder as these surfaces are easily damaged.
- Clean the body of the camera with a soft dry cloth. Do not use volatile substances such as thinners, benzine or insecticide, as these may react with camera body and cause deformation or remove the coating.

### ■ When travelling overseas

Do not place your camera in the check-in baggage. Baggage handling at airports may subject baggage to violent shocks, and the camera may be damaged internally even when no external damage is visible.

# Notes on the Power Supply

## Applicable Batteries

- AA-size alkaline, Ni-MH (nickel metal hydride), or Ni-Cd batteries can be used with this camera.  
Do not use AA-size manganese or lithium batteries in your FinePix2400 ZOOM because the heat generated by the batteries could damage the camera or cause malfunctions.
- Because different brands of alkaline batteries have different capacities, the life of some batteries (the length of time for which they can be used) may be considerably shorter than that of the alkaline batteries supplied with this camera.

## Notes on the Batteries

Incorrect use of the batteries could cause them to leak, become hot, ignite or burst. Always observe the precautions given below.

- Do not heat the batteries or throw them into a fire.
- Do not carry or store a battery with metal objects such as necklaces or hairpins that could come into contact with the metal positive ⊕ and negative ⊖ poles of the battery.
- Do not expose the batteries to fresh or sea water, and take particular care to keep the terminals dry.
- Do not attempt to deform, disassemble or modify the batteries.
- Do not attempt to peel off or cut the battery casing.
- Do not drop, strike or otherwise subject the batteries to strong impacts.
- Do not use batteries that are leaking, deformed,

discolored or exhibit any other obvious abnormality.

- Do not store batteries in very warm or moist locations.
- Keep the batteries out of the reach of babies and small children.
- When loading the batteries in the camera, ensure that the battery polarity (⊕ and ⊖) is as indicated on the camera.
- Do not use new batteries together with used batteries. In the case of rechargeable batteries, do not use charged and discharged batteries together. Do not use batteries of different types or brands together.
- If you do not intend to use the camera for a long period of time, remove the batteries from the camera. (Note that if the camera is left with the batteries removed, the time and date settings are cleared.)
- The batteries may feel warm immediately after being used. Before removing the batteries, switch the camera off and wait until the batteries cool down.
- When replacing the batteries, always fit 4 new batteries. Here, 'new batteries' refers to either recently purchased unused alkaline batteries, or Ni-Cd or Ni-MH (nickel metal hydride) batteries that have recently been fully recharged together.
- Battery performance deteriorates at low temperatures (+10°C or below) and the time for which they can be used shortens. This is particularly true of alkaline batteries. In cold conditions, put the batteries in your pocket or a similar place to warm them before loading them into the camera. If you use a body warmer to warm the batteries, ensure that they are not in direct contact with the warmer.
- Soiling such as fingerprints on the battery terminals can

significantly reduce the number of available shots. Carefully wipe the battery terminals clean with a soft, dry cloth before loading the batteries.

- ⚠ If any liquid at all leaks from the batteries, wipe the battery compartment thoroughly and then load new batteries.
- ⚠ If any battery fluid comes into contact with your hands or clothing, flush the area thoroughly with water. Note that battery fluid can cause loss of eyesight if it gets in your eyes. If this occurs, do not rub your eyes. Flush the fluid out with clean water and contact your physician for treatment.

## Disposing of Batteries

When disposing of batteries, do so in accordance with your local waste disposal regulations.

## Notes on Small Rechargeable Batteries (Ni-MH or Ni-Cd batteries)

- Always use the special battery charger to charge AA-size Ni-MH or Ni-Cd batteries. Charge the batteries as described in the instructions provided with the battery charger.
- Do not use the battery charger to charge batteries other than those specified for use with the charger.
- Note that the batteries may feel warm immediately after being charged.
- Ni-MH and Ni-Cd batteries are not charged at shipment. Be sure to charge the batteries before using them.
- The camera mechanism is such that it draws a minute amount of current even when the camera is switched off. Take particular care not to leave Ni-MH or Ni-Cd

batteries in the camera for a long period of time as they can become excessively discharged and no longer be usable even when charged.

- Ni-MH and Ni-Cd batteries self-discharge even when not used. Always charge Ni-MH and Ni-Cd batteries before using them. If the time for which a battery provides power shortens markedly when it has been correctly charged, this indicates that the battery has reached the end of its effective life and should be replaced.

## Notes on Using the AC Power Adapter

Always use the AC-5V/AC-5VH AC Power Adapter AC-5V/AC-5VH (sold separately) with the FinePix2400 ZOOM Digital Camera.

The use of an AC power adapter other than the AC-5V/AC-5VH could result in damage to your camera.

- Ensure that you do not touch the contact areas on the AC power adapter against any other metal object as this could cause a short circuit.
- Do not plug the AC power adapter into the DIGITAL socket as this could damage your camera.
- Do not plug in the AC power adapter while you are operating the camera using batteries. Switch the camera off first.
- Do not load the batteries while you are operating the camera using the AC power adapter. Switch the camera off first.
- If you disconnect the AC power adapter when there are no batteries in the camera, the date may be cleared. If this occurs, reset the date.

# Notes on the SmartMedia™

## ■ SmartMedia

The SmartMedia card supplied with your FinePix2400 ZOOM camera is a new image recording medium developed especially for use in digital cameras. Each SmartMedia card contains a built-in semiconductor memory chip (NAND flash memory) which is used for storing digital image data.

Because the data is stored electronically, the stored image data can be erased from the card and new data recorded.

## ■ SmartMedia with IDs

The SmartMedia ID is a SmartMedia that has an individually assigned identification number. SmartMedia ID cards can be used with devices that use ID numbers for copyright protection or other purposes. This camera accepts SmartMedia ID cards in the same way as conventional SmartMedia cards.

## ■ Storing Data

In the situations listed below, recorded data may be erased (destroyed). Please note that Fuji Photo Film Co., Ltd. accepts no responsibility whatsoever for the loss (destruction) of recorded data.

\*When the SmartMedia is used incorrectly by the owner or a third party

\*When the SmartMedia is exposed to static electricity or electrical noise

\*When the SmartMedia cover is opened or the SmartMedia removed and the camera is then switched off during data recording, during data erasing (SmartMedia formatting) or during frame advance when images are being played back.

**Back up important data onto another medium (MO disk, floppy disk, hard disk, etc.).**

## ■ Notes on Handling SmartMedia

- When inserting the card into the camera, hold the SmartMedia straight as you push it in.
- Never remove the SmartMedia or switch the camera off during data recording, during data erasing (SmartMedia formatting) or during frame advance when images are being played back. These actions could result in damage to the SmartMedia.
- Use only the SmartMedia specified for use with the FinePix2400 ZOOM. The use of other SmartMedia could damage the camera.
- SmartMedia are precision electronic devices. Do not bend, drop, or subject SmartMedia to excessive shocks.
- Do not use or store SmartMedia in environments likely to be affected by strong static electricity or electrical noise.
- Do not use or store SmartMedia in very hot, humid or corrosive environments.
- Be careful not to touch the SmartMedia's contact area or allow the area to become soiled. Use a dry lint-free cloth

to wipe away any soiling that does occur.

- To avoid damage caused by static electricity, always use the special static-free case provided during transportation or storage, or keep the SmartMedia in a storage case if available.
- Do not carry SmartMedia in locations such as a trouser pocket. This could subject the SmartMedia to excessive force when you sit down, therefore damaging the SmartMedia.
- The SmartMedia may feel warm when it is removed from the camera after extended periods of picture taking or image viewing. This is normal and does not indicate a fault.
- Inserting a SmartMedia that is charged with static electricity into your camera may result in a camera malfunction. If this occurs, switch the camera off and then on again.
- Affix the label onto the designated area of the card. Do not use third-party labels as this can lead to problems when the card is inserted or removed.
- When you attach the label, take care that it does not cover any of the write-protect area.

## ■ Notes on Using SmartMedia with a PC

- If you intend to take photos using a SmartMedia that has been used on a PC, format the SmartMedia on your camera.







- When you format a SmartMedia in the camera and then shoot and record images, a directory (folder) is automatically created. Image data is then recorded in this directory.
- Do not change or delete the directory (folder) names or file names on the SmartMedia from your PC as this will make it impossible to use the SmartMedia in your camera.
- Always use the camera to erase image data on a SmartMedia.
- To edit image data, copy the image data to the computer's hard disk and then edit the copied data.



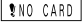

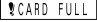
## ■ Specifications

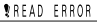
Type	Image memory card for digital cameras (SmartMedia)
Operating voltage	3.3V
Operating conditions	Temperature: 0°C to +40°C (+32°F to +104°F) Humidity: 80% or less (no condensation)
Dimensions	37 × 45 × 0.76mm (1.45 × 1.77 × 0.03in.) (W × H × D)

## Warning Displays

► The table below lists the warnings that are displayed on the LCD monitor.

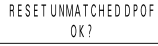
Explanation	Warning Displayed	Remedy
	The camera battery is low on charge.	Replace or recharge the battery.
	No SmartMedia is loaded, or it is loaded incorrectly.	Insert the SmartMedia (3.3V) in the correct direction.
	The SmartMedia is not formatted.	Format the SmartMedia.
	<ul style="list-style-type: none"> <li>The SmartMedia contact area are soiled.</li> <li>The SmartMedia is damaged.</li> <li>The SmartMedia format is incorrect.</li> </ul>	Wipe the contact area on the SmartMedia with a soft dry cloth. It may be necessary to format the SmartMedia. If the error message is still displayed, replace the SmartMedia.
	The SmartMedia is fully recorded.	Erase some images or use a SmartMedia that has ample free space.
	The SmartMedia is write-protected.	Use a SmartMedia that is not write-protected.
	<ul style="list-style-type: none"> <li>An attempt was made to playback incorrectly recorded data.</li> <li>An attempt was made to playback a frame not recorded on camera.</li> </ul>	Images cannot be played back.
	You attempted to erase a frame with DPOF settings.	Reset the DPOF settings.

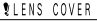
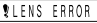
Explanation	Warning Displayed	Remedy
	The frame number has reached 999-9999.	Switch the Frame NO. Memory function off and use a formatted SmartMedia to take the picture.
	There is a strong likelihood of camera shake because the shutter speed is slow.	Use a tripod or set the flash mode to Auto, Red-eye Reduction or Forced Flash.
	A protected frame was erased.	Remove the protection.
<b>! AF</b>	The AF (auto focus) cannot work effectively.	<ul style="list-style-type: none"> <li>If the shot is too dark, move at least 1.5 m away from the subject and try again.</li> <li>Use AF/AE lock to take the picture.</li> </ul>
<b>! AE</b>	Outside the AE continuous range.	<ul style="list-style-type: none"> <li>The shot can be taken, but the exposure will not be correct.</li> </ul>
	The DPOF file contains an error. Alternatively, the DPOF file was set up on a different device.	Press the MENU/OK button to create a new DPOF file and specify all the DPOF settings again.
	Prints were specified for more than 1000 frames in the DPOF frame settings.	The maximum number of frames for which prints can be specified on the same SmartMedia is 999.
	The lens cover is not open.	Open the lens cover.
	Lens malfunction or fault.	Try switching the camera on and off a few times.

# Troubleshooting

► Before you decide the camera is faulty, check the following once more.

Problem	Cause	Remedy
No power	<ul style="list-style-type: none"> <li>The battery is exhausted.</li> <li>The AC power adapter plug has come out of the power outlet.</li> <li>The Mode Switch has been moved to another setting.</li> </ul>	<ul style="list-style-type: none"> <li>Load a new battery.</li> <li>Plug the adapter back in.</li> <li>Set the Mode Switch to the correct setting.</li> </ul>
Power cuts out during operation.	<ul style="list-style-type: none"> <li>The battery is exhausted.</li> </ul>	<ul style="list-style-type: none"> <li>Load new batteries.</li> </ul>
Battery runs out quickly.	<ul style="list-style-type: none"> <li>You are using the camera in extremely cold conditions.</li> <li>The terminals are soiled.</li> <li>The batteries are flat.</li> </ul>	<ul style="list-style-type: none"> <li>Put the battery in your pocket or another warm place to heat it and then load it into the camera just before you take a picture.</li> <li>Wipe the battery terminals with a clean, dry cloth.</li> <li>Load a new battery.</li> </ul>
No photograph is taken when the shutter button is pressed.	<ul style="list-style-type: none"> <li>The lens cover is not open.</li> <li>No SmartMedia is loaded.</li> <li>The SmartMedia is fully recorded.</li> <li>The SmartMedia is write-protected.</li> <li>The SmartMedia is not formatted.</li> <li>The SmartMedia contact area is soiled.</li> <li>The SmartMedia is damaged.</li> <li>The Auto Power Off function has switched the camera off.</li> <li>The battery is exhausted.</li> </ul>	<ul style="list-style-type: none"> <li>Open the lens cover.</li> <li>Load a SmartMedia.</li> <li>Erase some images or use a SmartMedia that has ample free space.</li> <li>Remove the write-protection.</li> <li>Format the SmartMedia.</li> <li>Wipe the SmartMedia contact area with a clean dry cloth.</li> <li>Load a new SmartMedia.</li> <li>Switch the camera on.</li> <li>Load new batteries.</li> </ul>
I can't use the flash to take pictures.	<ul style="list-style-type: none"> <li>The flash is set to Suppressed Flash mode.</li> </ul>	<ul style="list-style-type: none"> <li>Set the flash mode to Auto, Red-eye Reduction, Forced Flash or Night Scene.</li> </ul>

Problem	Cause	Remedy
I can't use the flash to take pictures.	<ul style="list-style-type: none"> <li>The shutter button was pressed when the viewfinder indicator was blinking orange.</li> <li>The camera is in continuous shooting mode.</li> </ul>	<ul style="list-style-type: none"> <li>Wait until the flash has finished charging before pressing the shutter button.</li> <li>Set continuous shooting to "OFF".</li> </ul>
The flash will not charge.	<ul style="list-style-type: none"> <li>No compatible SmartMedia is loaded.</li> <li>The camera is set to Suppressed Flash mode.</li> <li>The battery is exhausted.</li> </ul>	<ul style="list-style-type: none"> <li>Load a new SmartMedia, erase a frame, or remove the write-protection.</li> <li>Set the flash mode to Auto, Red-eye Reduction, Forced Flash or Night Scene.</li> <li>Load new batteries.</li> </ul>
The playback image is too dark even though I used the flash.	<ul style="list-style-type: none"> <li>The subject is too far away.</li> <li>Your finger is covering the flash.</li> </ul>	<ul style="list-style-type: none"> <li>Move closer to the subject.</li> <li>Hold the camera correctly.</li> </ul>
The image is blurred.	<ul style="list-style-type: none"> <li>The lens is soiled.</li> <li>Macro photography was used to photograph scenery.</li> </ul>	<ul style="list-style-type: none"> <li>Clean the lens.</li> <li>Cancel Macro photography.</li> </ul>
I cannot format the SmartMedia.	<ul style="list-style-type: none"> <li>The SmartMedia is write-protected.</li> </ul>	<ul style="list-style-type: none"> <li>Remove the write-protection. (Peel off the write-protect sticker.)</li> </ul>
ERASE ALL does not erase all the frames.	<ul style="list-style-type: none"> <li>The frame is protected.</li> </ul>	<ul style="list-style-type: none"> <li>Remove the frame protection.</li> </ul>
Nothing happens when I use the camera buttons and switches.	<ul style="list-style-type: none"> <li>Camera malfunction.</li> <li>The Mode Switch has been moved to another setting.</li> <li>The battery is exhausted.</li> </ul>	<ul style="list-style-type: none"> <li>Remove the battery, re-insert them and try again.</li> <li>Move the Mode Switch to the correct setting.</li> <li>Load new batteries.</li> </ul>
No image appears when I press the, "DISP" button.	<ul style="list-style-type: none"> <li>The Mode Switch is set incorrectly.</li> </ul>	<ul style="list-style-type: none"> <li>Move the Mode Switch to the correct setting.</li> </ul>

# Specifications

## System

- Model  
Digital camera
- Pickup Elements  
1/2.7-inch square pixel CCD (2.11 million pixels)
- Image File Size  
1600×1200 pixels/1280×960 pixels/640×480 pixels
- File format  
DCF-compliant (Exif Ver.2.1 JPEG-compliant), DPOF-compatible
- Viewfinder  
Real image optical ; Frame coverage : 80%
- Lens  
Fujinon optical 3×ZOOM lens F3.5/F8.7
- Storage media  
SmartMedia (3.3V)

- Focus distance  
f = 6 -18 mm (equivalent to 38 -114 mm on a 35 mm camera)
- Exposure control  
64 zones TTL metering, Program AE (exposure compensation available in Manual mode)
- Sensitivity  
Equivalent to ISO 100
- White balance  
Auto-selected (7 modes selectable in Manual mode)
- Focal range  
Normal : Approx. 0.8 m/31.5 in. to infinity  
Macro : Approx. 10 cm/3.9 in. to 80 cm/31.5 in.
- Shutter speeds  
Variable-speed, 1/2 to 1/1000 sec. (combined with mechanical shutter)
- Flash (Auto flash using flash control sensor)  
Effective range : Wide Approx. 0.2 - 3.0 m (7.9 in. -9.8 ft.)  
: Tele Approx. 0.8 - 3.0 m (2.6 ft. -9.8 ft.)  
Flash modes : Auto, Red-Eye Reduction, Forced Flash, Suppressed Flash, Slow Synchro

### ■ Number of frames recorded

Pixel	1600 × 1200			1280 × 960		640 × 480
	FINE	NORMAL	BASIC	FINE	NORMAL	NORMAL
Quality Mode	Approx.1/5	Approx.1/10	Approx.1/20	Approx.1/4	Approx.1/8	Approx.1/8
Compression Ratio	Approx.760KB	Approx.390KB	Approx.200KB	Approx.610KB	Approx.310KB	Approx.90KB
Image Data Size	4	9	19	6	12	44
4MB (MG-4S)	10	19	39	12	24	89
8MB (MG-8S)	20	39	75	25	49	164
16MB (MG-16S/SW)	41	79	152	50	99	330
32MB (MG-32S/SW)	82	159	306	101	198	663
64MB (MG-64S/SW)						

- LCD monitor  
1.6-inch, 55,000-pixel D-TFD
- Self-Timer  
10 sec. timer clock

## Input/Output Terminals

- Digital  
USB (1) for image data output with a personal computer
- DC Input  
Socket for specified AC power adapter

## Power Supply and Others

- Power supply  
Use one of the following:
  - 4AA-size alkaline batteries
  - 4AA-size Ni-MH (nickel metal hydride) batteries (sold separately)
  - 4AA-size long-life (Minimum 1,000mAh) Ni-Cd (nickel-cadmium) batteries (sold separately)
  - AC-5V/AC-5VH AC Power Adapter (sold separately)
- No. of available shots using battery (battery life)

Battery type	With LCD monitor ON	With LCD monitor OFF
Alkaline batteries	Approx.200 frames	Approx.400 frames
Ni-MH battery HR-3UF	Approx.200 frames*	Approx.400 frames*
Ni-Cd battery KR-3UF	Approx.130 frames*	Approx.270 frames*

\* With fully charged battery

This indicates the number of available frames shot consecutively at room temperature with a flash use rate of 50%. Note that these figures may vary depending on the ambient temperature and the amount of charge in the battery.

- Conditions for use  
Temperature : 0°C to +40°C (+32°F to +104°F) ; 80% humidity or less (no condensation)
- Camera dimensions (W/H/D)  
125×65×39 mm/4.9×2.6×1.5 in. (not including accessories and attachments)
- Camera mass (weight)  
Approx. 250 g/8.8oz (not including accessories, batteries or SmartMedia)
- Mass (weight) for photography  
Approx. 350 g/12.3oz (including batteries and SmartMedia)
- Accessories  
See P.7
- Optional Accessories  
See P.66, 67

\* These specifications are subject to change without notice.

\* The LCD monitor on your digital camera is manufactured using advanced high-precision technology. Even so, small bright points and anomalous colors (particularly around text) may appear on the monitor. These are normal display characteristics and do not indicate a fault with the monitor. This phenomenon will not appear on the recorded image.



# Safety Notes

- To ensure that you use your FinePix2400 ZOOM camera correctly, read these Safety Notes and your Owner's Manual carefully beforehand.
- After reading these Safety Notes, store them in a safe place.

## About the Icons

The icons shown below are used in this document to indicate the severity of the injury or damage that can result if the information indicated by the icon is ignored and the product is used incorrectly as a result.

	<b>WARNING</b> This icon indicates that death or serious injury can result if the information is ignored.
	<b>CAUTION</b> This icon indicates that personal injury or material damage can result if the information is ignored.

The icons shown below are used to indicate the nature of the information which is to be observed.







- Triangular icons notify the user of information requiring attention ("Important").
- Circular icons with a diagonal bar notify the user that the action indicated is prohibited ("Prohibited").
- Filled circles with an exclamation mark notify the user of an action that must be performed ("Required").





<b>WARNING</b>	
<p><b>When a fault arises, switch the camera off and then remove the batteries and disconnect the AC power adapter.</b></p> <p>Continued use of the camera when it is emitting smoke, is emitting any unusual odor, or is in any other abnormal state can cause a fire or electric shock.</p> <ul style="list-style-type: none"> <li>● Contact your Fujii dealer.</li> </ul>	 Unplug from power socket.
<p><b>Do not allow water or foreign objects to enter the camera.</b></p> <p>If water or a foreign object has entered the camera, switch the camera off and then remove the batteries and disconnect the AC power adapter.</p> <p>Continued use of the camera can cause a fire or electric shock.</p> <ul style="list-style-type: none"> <li>● Contact your Fujii dealer.</li> </ul>	
<p><b>Do not place the camera on an unstable surface.</b></p> <p>This can cause the camera to fall or tip over and cause injury.</p>	
<p><b>Do not use the camera in the bathroom or shower.</b></p> <p>This can cause a fire or electric shock.</p>	 Do not use in the bathroom or shower.

<b>WARNING</b>	
<p><b>Never attempt to modify or disassemble the camera. (Never open the casing.)</b></p> <p>Do not use the camera when it has been dropped or the casing is damaged.</p> <p>This can cause a fire or electric shock.</p> <ul style="list-style-type: none"> <li>● Contact your Fujii dealer.</li> </ul>	 Do not disassemble.
<p><b>Never attempt to take pictures whilst in motion.</b></p> <p>Do not use the camera while you are walking or operating a moving car or other vehicle.</p> <p>This can result in you falling down or being involved in a traffic accident.</p>	
<p><b>Do not heat, modify or attempt to disassemble the batteries.</b></p> <p><b>Do not drop or subject the batteries to impacts.</b></p> <p><b>Do not attempt to recharge lithium or alkaline batteries.</b></p> <p><b>Do not store the batteries with metallic products.</b></p> <p>Any of these actions can cause the batteries to burst or leak and cause fire or injury as a result</p>	

<b>WARNING</b>	
<p><b>Do not touch any metal parts of the camera during a thunderstorm.</b></p> <p>This can cause an electric shock due to induced current from the lightning discharge.</p>	
<p><b>Do not use the batteries except as specified.</b></p> <p>Load the batteries with the poles positioned as indicated by the ⊕ and ⊖ marks.</p>	
<p><b>Use only the batteries or AC power adapter specified for use with this camera.</b></p> <p>The use of other power sources can cause a fire.</p>	
<p><b>If the battery leaks and fluid gets into your eyes or comes into contact with your skin or clothing, this can cause injury or loss of eyesight. Immediately flush the affected area thoroughly with clean water and seek medical treatment.</b></p>	
<p><b>When discarding or storing batteries, cover the battery terminals with insulation tape.</b></p> <ul style="list-style-type: none"> <li>● Contact with other metallic objects or batteries could cause the batteries to ignite or burst.</li> </ul>	

## Safety Notes

 <b>CAUTION</b>	
<p><b>Do not use this camera in locations severely affected by oil fumes, steam, humidity or dust.</b></p> <p>This can cause a fire or electric shock.</p>	
<p><b>Do not leave this camera in places subject to extremely high temperatures.</b></p> <p>Do not leave the camera in locations such as a sealed vehicle or in direct sunlight.</p> <p>This can cause a fire.</p>	
<p><b>Do not place heavy objects on the camera.</b></p> <p>This can cause the heavy object to tip over or fall and cause injury.</p>	
<p><b>Do not move the camera while the AC power adapter is still connected.</b></p> <p>This can damage the power cord or cables and cause a fire or electric shock.</p>	
<p><b>Do not cover or wrap the camera or the AC power adapter in a cloth or quilt.</b></p> <p>This can cause heat to build up and distort the casing or cause a fire.</p>	

 <b>CAUTION</b>	
<p><b>Remove the batteries and disconnect the AC power adapter when you are cleaning the camera or if you intend to leave the camera unused for a long period.</b></p> <p>Failure to do so can cause a fire or electric shock.</p>	
<p><b>Do not use the flash close to anyone's eyes.</b></p> <p>This can cause temporary damage to the person's eyesight.</p>	
<p><b>Request regular internal testing and cleaning for your camera.</b></p> <p>Build-ups of dust in your camera can cause a fire or electric shock.</p> <ul style="list-style-type: none"><li>● Contact your Fuji dealer to request internal cleaning every 2 years.</li></ul>	



---

**FUJI PHOTO FILM CO., LTD.**

26-30, Nishiazabu 2-chome, Minato-ku, Tokyo 106-8620, Japan

Printed in Japan

Printed on recycled paper.

FGS-002108-FG