



digital
Tools for the imagination.

DIGITAL CAMERA

FinePix6900Zoom



Getting Ready

1

Basic Photography

2

Advanced Features

3

Advanced Features
Playback

4

Settings

5

PC Connection

6

OWNER'S MANUAL

This manual will show you how to use your FUJIFILM DIGITAL CAMERA FinePix6900 ZOOM correctly. Please follow the instructions carefully.

BL00004-200(1) **E**

Warning

To prevent fire or shock hazard, do not expose the unit to rain or moisture.

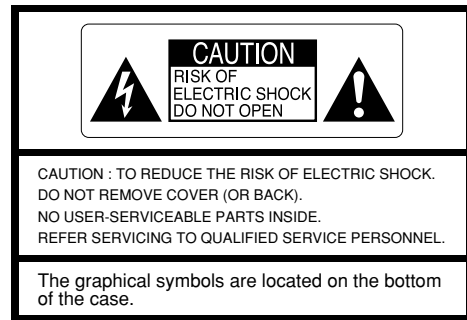

This symbol is intended to alert the user to the presence of uninsulated “dangerous voltage” within the product’s enclosure that may be of sufficient magnitude to constitute a risk of electric shock to persons.



This symbol is intended to alert the user to the presence of important operating and maintenance (servicing) instructions in the literature accompanying the appliance.

For customers in the U.S.A.

FCC Statement

This device complies with part 15 of the FCC Rules. Operation is subject to the following two conditions : (1) This device may not cause harmful interference, and (2) this device must accept any interference received, including interference that may cause undesired operation.

CAUTION

This equipment has been tested and found to comply with the limits for a Class B digital device, pursuant to Part 15 of the FCC Rules. These limits are designed to provide reasonable protection against harmful interference in a residential installation. This equipment generates, uses, and can radiate radio frequency energy and, if not installed and used in accordance with the instructions, may cause harmful interference to radio communications. However, there is no guarantee that interference will not occur in a particular installation. If this equipment does cause harmful interference to radio or television reception, which can be determined by turning the equipment off and on, the user is encouraged to try to correct the interference by one or more of the following measures :

- Reorient or relocate the receiving antenna.
- Increase the separation between the equipment and receiver.
- Connect the equipment into an outlet on a circuit different from that to which the receiver is connected.

— Consult the dealer or an experienced radio/TV technician for help.

You are cautioned that any changes or modifications not expressly approved in this manual could void the user’s authority to operate the equipment.

Notes on the Grant:

To comply with Part 15 of the FCC rules, this product must be used with a Fujifilm-specified ferrite-core video cable, USB cable, and DC supply cord.

For customers in Canada

CAUTION

This Class B digital apparatus complies with Canadian ICES-003.

Please read the Safety Notes (→P.127) and make sure you understand them before using the camera.

Contents

Warning	2
Preface	6
Camera Features and Accessories	7
Nomenclature	8
Shutter Speed and Aperture Setting Displays	13

1 Getting Ready

ATTACHING THE LENS CAP AND SHOULDER STRAP ...	14
Using the Lens Cap Holder	15
LOADING THE BATTERY	16
CHARGING THE BATTERY	17
USING THE AC POWER ADAPTER	18
LOADING THE SmartMedia™	19
REMOVING THE SmartMedia™	20
SWITCHING ON AND OFF	21
SETTING THE DATE AND TIME	22

2 Basic Photography

TAKING PICTURES (AUTO MODE)	24
Number of Available Frames	29
USING AF/AE LOCK	30
FRAMING GUIDELINE FUNCTION	32
VIEWING YOUR IMAGES (PLAYBACK)	33
FAST FORWARDING IMAGES	34
PLAYBACK ZOOM	35
Saving Trimmed Images	36
MULTI-FRAME PLAYBACK	37
ERASING SINGLE FRAME	38
4 USING A TV MONITOR	40

3 Advanced Features

ADVANCED FEATURES	41
■ Photography mode specifications	41
PHOTOGRAPHY MODE	
AUTO AUTO/SP: SCENE POSITION	42
Portrait	43
Landscape	43
Sports	43
Night Scene	43
Black and white	43
P: PROGRAMED/S: SHUTTER-PRIORITY/	
A: APERTURE-PRIORITY	44
Program Shift	45
M: MANUAL	46
Shutter Speed Setting	46
Aperture Setting	47
MOVIE	48
FLASH PHOTOGRAPHY	51
AF Auto Flash Mode	52
Red-Eye Reduction	52
Forced Flash	53
Slow Synchro	53
Red-Eye Reduction + Slow Synchro	53
Suppressed Flash	54
MACRO (CLOSE-UP) PHOTOGRAPHY	55
AE-L: USING AE LOCK	56
EXPOSURE COMPENSATION	57
SETTING THE MANUAL FOCUS	58
One-touch AF Function	59
Focus Check Function	59
DIGITAL ZOOM	60
CONTINUOUS SHOOTING	61

SELF-TIMER PHOTOGRAPHY	62
PHOTOGRAPHY INFORMATION	64

PHOTOGRAPHY MENU

PHOTOGRAPHY MENU OPERATION	65
FLASH BRIGHTNESS ADJUSTMENT	66
SETTING THE WHITE BALANCE	66
Custom White Balance Setting	67
PHOTOMETRY	69
SETTING THE SENSITIVITY	70
AUTO BRACKETING	70
SHARPNESS	72
MULTI-EXP	72
USING AN EXTERNAL FLASH	74
External Flash Settings	75
When the White Balance is Incorrect	76

4 Advanced Features Playback

ADVANCED PLAYBACK	77
■ Playback mode menu	77
PLAYBACK INFORMATION	78
MOVIE PLAYBACK	79
■ Playing Back Movies	80

PLAYBACK MENU

ERASING SINGLE • ALL FRAMES/FORMATTING ...	81
PLAYBACK (AUTOMATIC PLAYBACK)	83
SETTING AND REMOVING SINGLE FRAME PROTECTION ...	84
SETTING AND REMOVING PROTECTION FOR ALL FRAMES ...	86
HOW TO SPECIFY PRINT OPTIONS	88
DPOF DATE SETTING	89
DPOF SET FRAME	90
DPOF REVIEW/RESET	92
DPOF RESET ALL	93

5 Settings

SET SET-UP MODE	95
SET USING THE SET-UP SCREEN	96
SET SETTING THE FILE SIZE AND QUALITY (COMPRESSION RATIO)	97
SET IMAGE DISPLAY	98
Preview Zoom	98
Selecting Recorded Images	99
SET AUTO POWER SAVE SETTING	100
SET FRAME NO. MEMORY	101
ADJUSTING THE MONITOR BRIGHTNESS	102

6 PC Connection

IN PC CONNECTION	103
CONNECTING TO A PERSONAL COMPUTER	104
DISCONNECTING THE CAMERA FROM YOUR COMPUTER ...	106
CAMERA CUSTOMIZING	107

System Expansion Options	108
Overview of the Conversion Lens/Adapter Ring	109
Accessories Guide	110
Explanation of Terms	112
Notes on Using Your Camera Correctly	113
Notes on the Power Supply	114
Notes on Using the Battery	114
AC Power Adapter	116
Notes on the SmartMedia™	117
Warning Displays	119
Troubleshooting	122
Specifications	125
Safety Notes	127
EC Declaration of Conformity	131

Preface

■ Test Shots Prior to Photography

For particularly important photographs (such as weddings and overseas trips), always take a test photograph and view the image to make sure that the camera is functioning normally.

- Fuji Photo Film Co., Ltd cannot accept liability for any incidental losses (such as the costs of photography or the loss of income from photography) incurred as a result of faults with this product.

■ Notes on Copyright

Images recorded using your digital camera system cannot be used in ways that infringe copyright laws without the consent of the owner, unless intended only for personal use. Note that some restrictions apply to the photographing of stage performances, entertainments and exhibits, even when intended purely for personal use. Users are also asked to note that the transfer of memory cards containing images or data protected under copyright laws is only permissible within the restrictions imposed by those copyright laws.

■ Liquid Crystal

If the LCD monitor or LCD panel is damaged, take particular care with the liquid crystal in the monitor or panel. If any of the following situations arise, take the urgent action indicated.

- If liquid crystal comes in contact with your skin
Wipe the area with a cloth and then wash thoroughly with running water and soap.
- If liquid crystal gets into your eye
Flush the affected eye with clean water for at least 15 minutes and then seek medical assistance.
- If liquid crystal is swallowed
Flush your mouth thoroughly with water. Drink large quantities of water and induce vomiting. Then seek medical assistance.

■ Notes on Electrical Interference

If the camera is to be used in hospitals or aircrafts, please note that this camera may cause interference to other equipment in the hospital or aircraft. For details, please check with the applicable regulations in that place.

■ Handling Your Digital Camera

This camera contains precision electronic components. To ensure that images are recorded correctly, do not subject the camera to impacts or shocks while an image is being recorded.

■ Trademark Information

- IBM PC/AT is a registered trademark of International Business Machines Corp. of the U.S.A.
- iMac and Macintosh are registered trademarks of Apple Computer, Inc.
- Windows is a registered trademark of the Microsoft Corporation of the U.S. registered in the U.S.A. and other countries.
Windows is an abbreviated term referring to the Microsoft Windows Operating System.
- SmartMedia is a trademark of Toshiba Corporation.
- Other company or product names are trademarks or registered trademarks of the respective companies.

■ Explanation of Color Television System

NTSC: National Television System Committee, color television telecasting specifications adopted mainly in the U.S.A., Canada and Japan.

PAL: Phase Alternation by Line, a color television system adopted mainly by European countries and China.

Camera Features and Accessories

Features

- The newly developed "Super CCD" (featuring a total of 3.3 million pixels) used in the FinePix6900 ZOOM provides ultra-high resolution image file with 6.03 million (2832 × 2128) pixels.
- 6× optical zoom that uses aspherical lenses for superb optical performance
- Maximum 4.4× seamless digital zoom at VGA mode
- 0.55-inch 110,000 pixel Electronic Viewfinder
- The wide range of exposure modes, which includes a manual photography mode, allows you to precisely tailor the photography settings to the conditions.
- Quick, responsive operation with a 3-second startup and as little as 1-second between shots.
- Fast ISO 400 film speed (compared to a standard film speed of ISO 100) and a built-in automatic flash allow shooting in a wider range of situations.
- Hot shoe for synchronizing an external flash unit
- Auto focus with macro photography function (manual focus also available)
- Automatic shooting modes for different types of shots allow settings that are matched to your subject
- Convenient preview function so you can quickly check your shots
- Continuous shooting function even at maximum resolution
- Histogram display function lets you instantly check exposure levels after you take a shot.
- Trimmed recording function saves only that part of the image you want to keep.
- Playback zoom function (up to 18×)
- Multi-level exposure and black-and-white photography functions allow even more scope for photographic expression
- Information button shows a list of the camera settings at one touch whenever you need it
- Magnesium alloy body
- Easy high-speed image file transfer via the USB connection

Accessories

- **SmartMedia (16MB, 3.3V) (1)**
Supplied with:
 - Anti-static case (1)
 - Index label (1)



- **NP-80 Rechargeable Battery (1)**

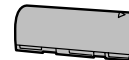

- **AC Power Adapter AC-5VS/AC-5VH (approx. 2 m (6.6 ft.) connection cord) (1)**

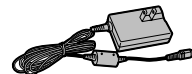

- **Shoulder strap (1)**



- **Lens cap (1)**
- **Lens cap holder (1)**



- **Video Cable (approx. 1.5 m (4.9 ft.), mini-plug (3.5 mm dia.) to pin-plug cable) (1)**



- **Interface Set (1)**
 - CD-ROM (1)
 - Special USB cable with Noise Suppression core (1)
 - Software Quick Start Guide (1)
- **Owner's Manual (this manual) (1)**

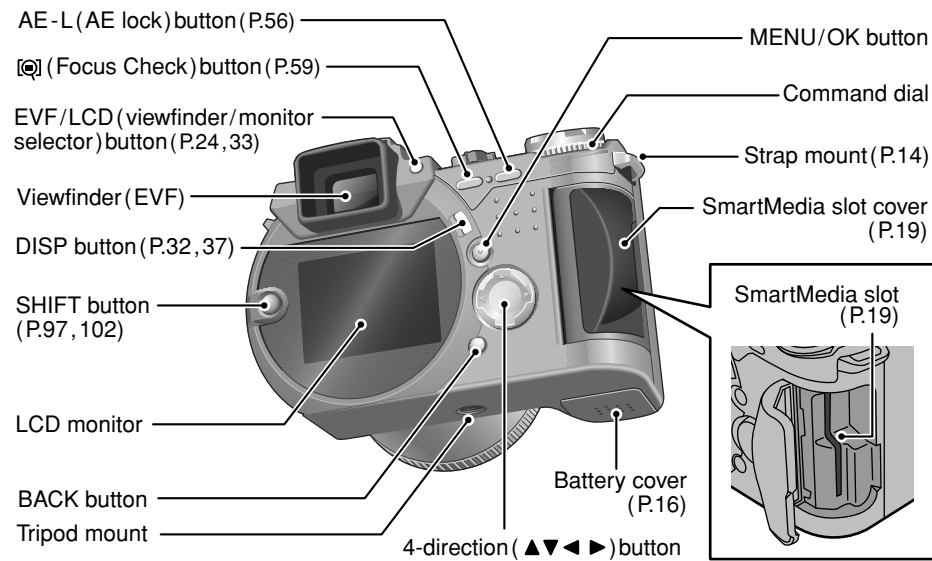
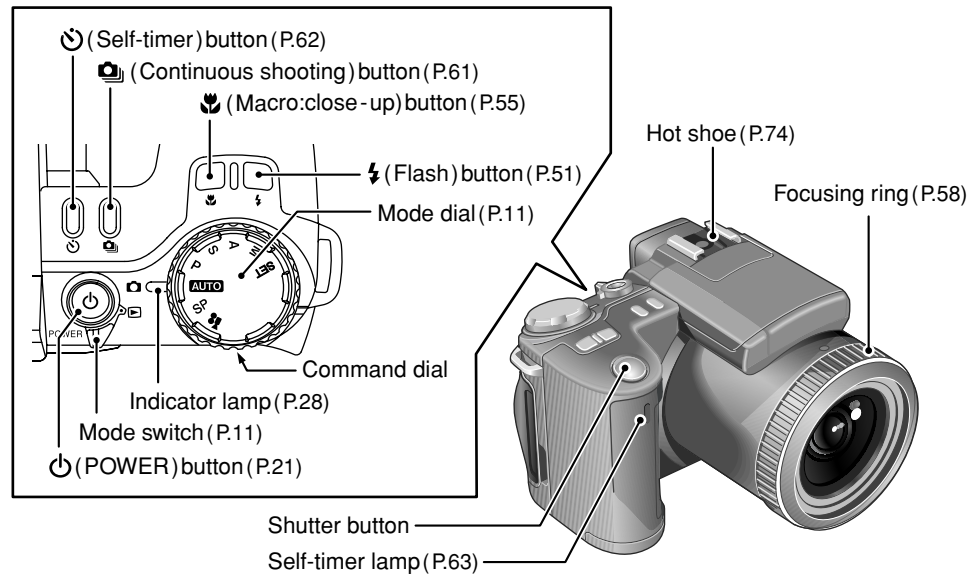

Nomenclature

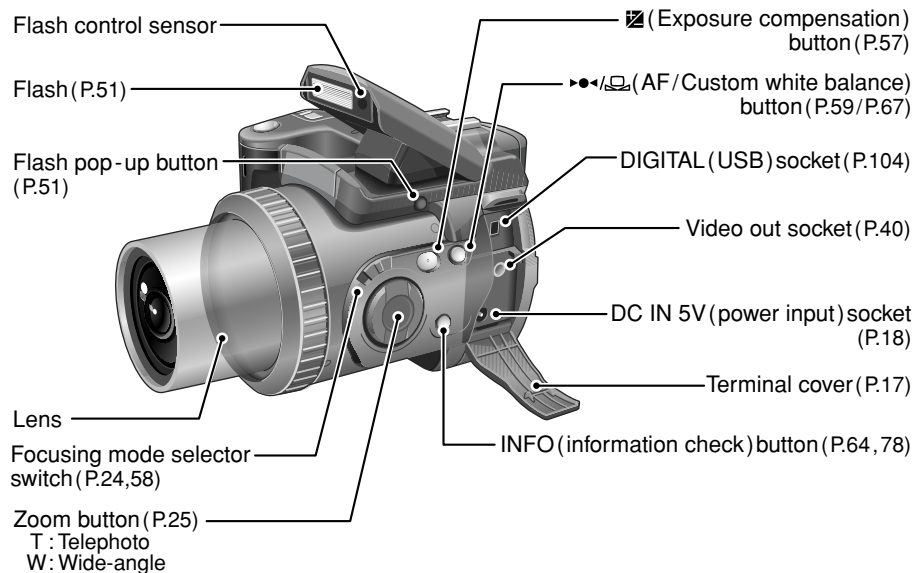

Mode switch

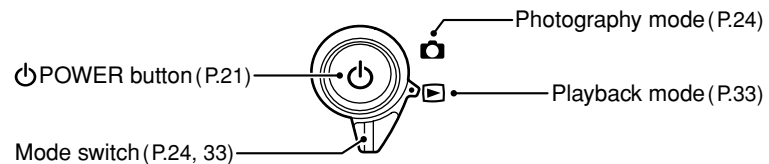

Mode dial

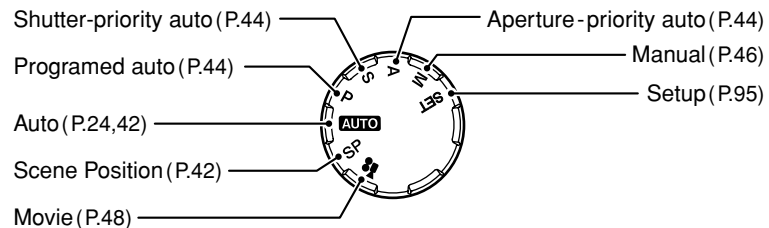

Nomenclature

Example of Monitor Text Display : Shooting

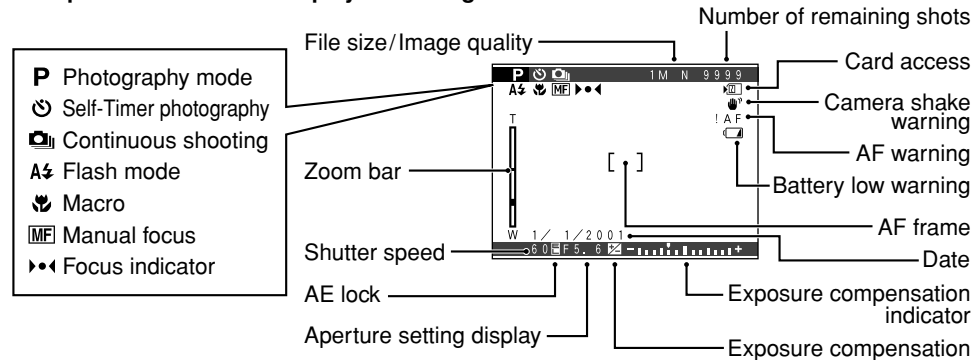

Example of Monitor Text Display : Playback

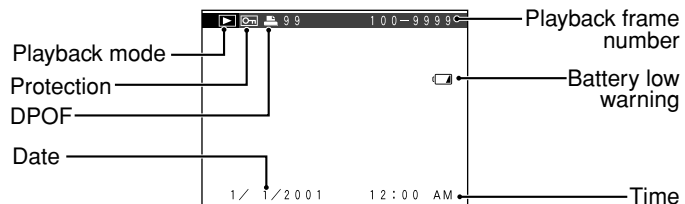

Shutter Speed and Aperture Setting Displays

If you exceed the control range for a photography mode (as with a scene that is extremely overexposed or underexposed), the shutter speed or aperture is displayed in red on the screen. For dimly lit scenes, “----” is displayed on the screen as the shutter speed and aperture setting. When this occurs, press the shutter button down halfway so that the camera takes the measurements and displays the settings.

Photography modes and Responses

	Photography mode	Response
Overexposure	AUTO (Auto)	Use the optional Adapter Ring and ND (Light Adjustment) Filter (➡P.109).
	SP (Scene Position)	
	P (Program)	
	S (Shutter-priority)	Select a faster shutter speed (up to 1/1000 sec.) (➡P.44). *1
Underexposure	A (Aperture-priority)	Select a higher aperture setting (up to F11) (➡P.44). *1
	M (Manual)	Select a faster shutter speed (up to 1/1000 sec.) or a higher aperture setting (up to F11) (➡P.46). *1
	AUTO (Auto)	Use the flash.
	SP (Scene Position)	
Underexposure	P (Program)	
	S (Shutter-priority)	Select a slower shutter speed (up to 3 sec.) (➡P.44). *2 *3
	A (Aperture-priority)	Select a lower aperture setting (down to F2.8) (➡P.44). *2 *3
	M (Manual)	Select a slower shutter speed (up to 3 sec.) or a lower aperture setting (down to F2.8) (➡P.46). *2 *3

*1 If you change the settings and the image is still overexposed, use the optional Adapter Ring and ND (Light Adjustment) Filter (➡P.109).

*2 If the image is underexposed even after you change the shutter speed, use the flash (➡P.51).

*3 If you do not use a flash, the shutter speed will be slow and a tripod should be used.

ATTACHING THE LENS CAP AND SHOULDER STRAP

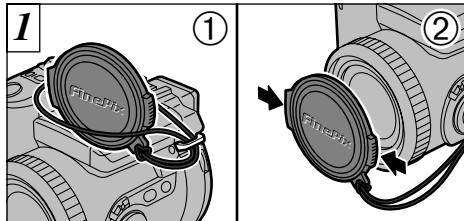

- ① Pull the lens cap cord through the strap mount.
- ② Fit and remove the lens cap by squeezing the left and right sides of the cap.

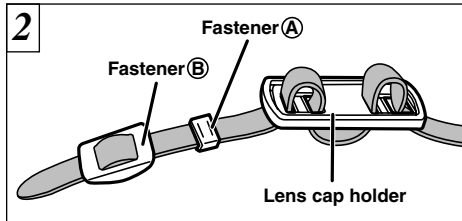

Remove fasteners **A** and **B** from only one side of the shoulder strap. Then pass the shoulder strap through the lens cap holder and then back through fasteners **A** and **B**.

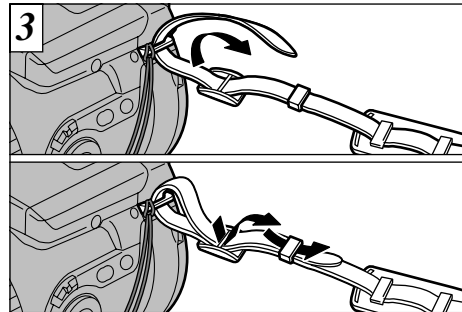

Attach the shoulder strap to the strap mounts. After attaching the shoulder strap, check carefully that the strap is firmly secured.

Using the Lens Cap Holder

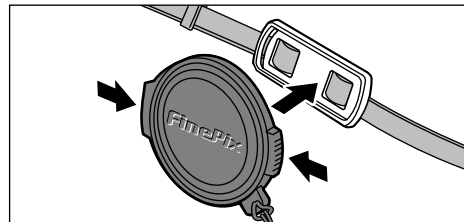

To prevent the lens cap from appearing in the shot when you take pictures, attach the lens cap to the lens cap holder.

LOADING THE BATTERY

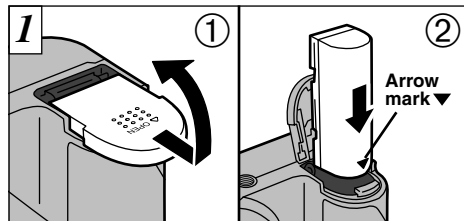

- ① Slide the battery cover and lift it open.
- ② Insert the battery in the direction indicated by the arrow “▼” on the battery.

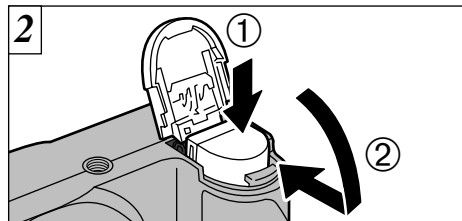

- ① Hold the battery in, ② and close the battery cover.

- ⚠ Do not use excessive force to open the battery cover.
- ⚠ When replacing the battery, always switch the camera off beforehand. If you open the battery cover without switching the camera off, the camera settings may revert to the factory defaults.

◆ Battery Type ◆

NP-80 rechargeable battery.

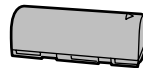

- ⚠ The battery is not fully charged at shipment. You must charge the battery before you use it.
- ⚠ See P.114 – 116 for more information on the battery.

CHARGING THE BATTERY

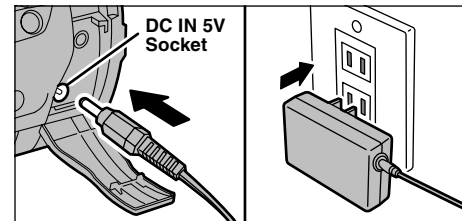

Check that the camera is switched off. Open the terminal cover and plug the AC power adapter connector into the “DC IN 5V” socket. Then plug the AC power adapter into a power outlet.

- ⚠ Problems arising from the use of products other than genuine FUJIFILM products are not covered by your warranty.
- ⚠ See P.116, 117 for additional notes on the AC power adapter.

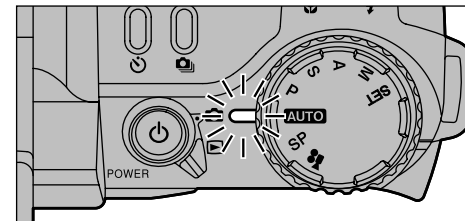

The indicator lamp lights (orange) and battery charging begins. When charging is completed, the indicator lamp goes off.

- ⚠ A fully discharged battery takes about 5 hours to recharge.
- ⚠ An almost fully charged battery will not charge. This is normal and does not indicate a fault.
- ⚠ If you switch the camera on while the battery is charging, the charging will stop.
- ⚠ By using the optional Battery Charger BC-80, you can reduce the charging time to approximately 70 minutes (→P.110).

USING THE AC POWER ADAPTER

Connecting the AC-5V AC Power Adapter to your camera allows you to take pictures or play back images (using a TV connection, etc.) without worrying about the battery running out. You can also use the AC power adapter to recharge the camera's battery, making it very convenient for travelling, etc.

●Compatible AC power adapters

Model: AC-5VS/AC-5VH (provided as an accessory or sold separately)

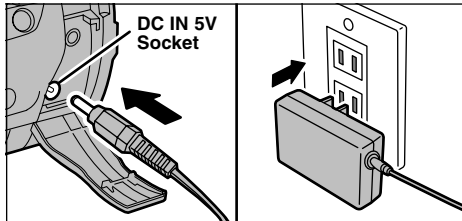

Check that the camera is switched off. Open the terminal cover and plug the AC power adapter connector into the "DC IN 5V" socket. Then plug the AC power adapter into a power outlet.

- ⚠ Problems arising through the use of products other than genuine FUJIFILM products are not covered by your warranty.
- ⚠ See P.116 for additional notes on the AC power adapter.

LOADING THE SmartMedia™

SmartMedia™

■Only use 3.3V SmartMedia

MG-4S (4MB), MG-16SW (16MB, ID)
MG-8S (8MB), MG-32SW (32MB, ID)
MG-16S (16MB), MG-64SW (64MB, ID)
MG-32S (32MB), MG-128SW (128MB, ID)
MG-64S (64MB)

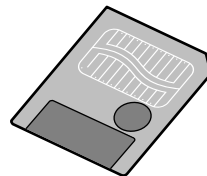

- ⚠ Images cannot be recorded or erased if a write-protect sticker is affixed to the SmartMedia.
- ⚠ Operation of this camera is only guaranteed when it is used with FUJIFILM SmartMedia.
- ⚠ Some 3.3V SmartMedia are labelled as "3V" or "ID" cards.
- ⚠ See P.117, 118 for more information on SmartMedia.

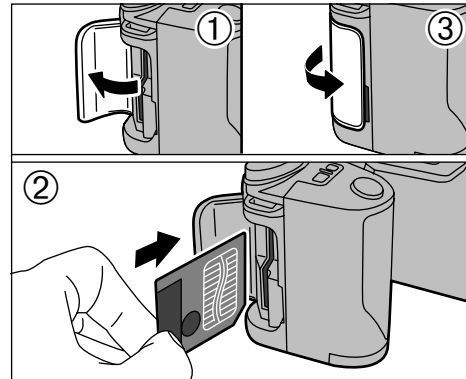

- ① Check that the camera is switched off and open the slot cover.
 - ② Push the SmartMedia firmly into the SmartMedia slot as far as it will go.
 - ③ Close the slot cover.
- ⚠ If you open the slot cover while the camera is switched on, the camera is automatically switched off to protect the SmartMedia.
 - ⚠ The SmartMedia will not slide fully into the slot if it is inserted facing the wrong way. Be careful not to apply undue force to the SmartMedia.

REMOVING THE SmartMedia™

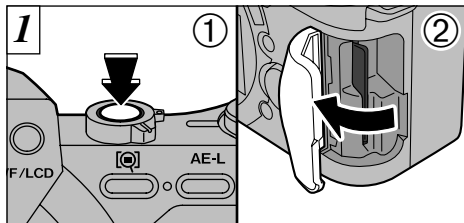

- ① Check that the indicator lamp is green and switch the camera off (➡P.21).
- ② Open the slot cover.

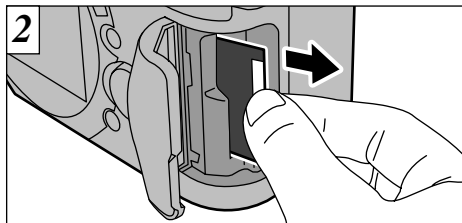

Grasp the SmartMedia with your fingertips and pull it out.

! To protect the SmartMedia, always store it in the special anti-static case.

◆ Printing Images and Downloading Images to a Personal Computer ◆

- See P.88, 108 for information on printing images.
- See P.103 – 106 for information on downloading images to a personal computer.

Never open the SmartMedia slot cover while the camera is switched on. This could destroy the image data or damage the SmartMedia itself.

SWITCHING ON AND OFF

* See P.95 – 96 for information on selecting the language.

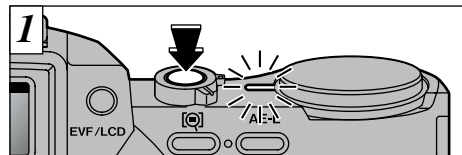

Press the “” (Power) button to switch the camera on and off. When you switch the camera on, the indicator lamp turns green. If the date has been cleared, a confirmation message appears.

SET ➡ OK : Switches to the DATE/TIME setting screen (➡P.23).

NO ➡ BACK : Switches to photography or playback mode.

- ! If you do not set the date and time, this confirmation screen will appear each time you switch the camera on.
- ! If you switch the camera on when the Mode switch is set to “”, the lens extends. Take care not to press on the lens.

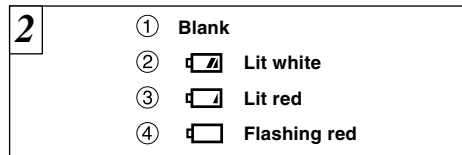

Check the battery level warning when you switch the camera on.

- ① Battery has ample charge. (No indicator displayed.)
- ② The battery is approximately half charged.
- ③ Battery charge low. Replace or recharge the battery as it will run out shortly.
- ④ The battery is exhausted. The display will shortly go blank and the camera will stop working. Replace or recharge the battery.

◆ Auto Power Save Function ◆

If the camera is not used in any way for 30 seconds when the camera functions are enabled, this function temporarily switches features such as the LCD screen off to reduce power consumption. If the camera is then left unused for a further period (2 or 5 minutes), the Auto Power Save function automatically switches the camera off. (See P.100 for details.)

SETTING THE DATE AND TIME

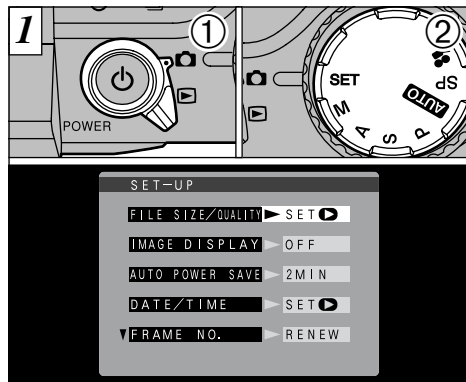

① Set the Mode switch to “**SET**”. The SET-UP screen appears on the monitor.

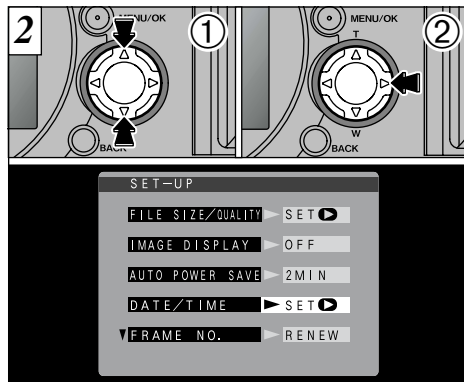

① Use “▲” or “▼” to select “DATE/TIME”.
② Press “▶”.

- See P.95 for more information on the “SET” (setup) menu.
- If at least 3 hours have passed since the AC power adapter was connected or the battery inserted and date and time set, then those settings will be maintained for roughly 1 hour even when the camera has no power supply (when the AC power adapter is disconnected and the battery is removed).

If the date was cleared and you selected “SET DATE/TIME”, proceed from step [3]. (➡P.23)

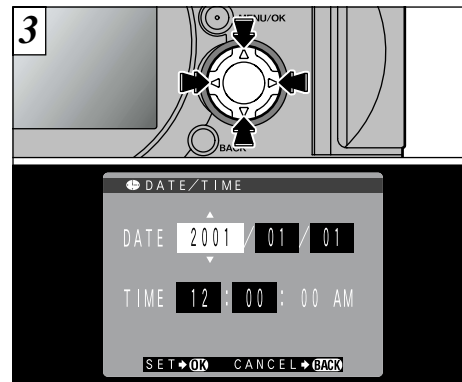

Use the “◀▶” button to select the desired item and then use the “▲” and “▼” buttons to correct the setting.

- If you hold down “▲” or “▼”, the numbers change continuously.
- When the time displayed passes “12:00:00”, the AM/PM setting automatically switches.
- To set the time precisely, press the “MENU/OK” button when the time is at zero seconds.

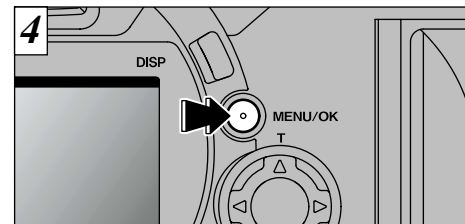

When you have finished setting the date and time, press the “MENU/OK” button to confirm the setting.
When the SET-UP screen reappears, move the Mode dial to a setting other than “SET” to exit the SET-UP screen.

If the date setting was cleared and you have set the date and time from the confirmation screen, pressing the “MENU/OK” button returns you to the selected photography or playback mode.

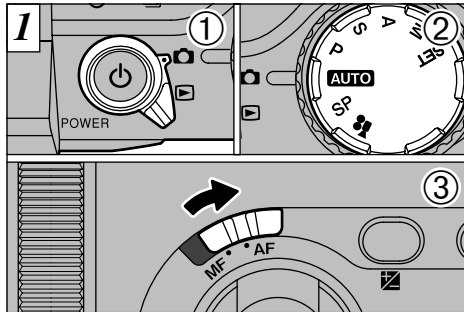

① Set the Mode switch to “” ② and set the Mode dial to “**AUTO**”. ③ Then slide the focus mode selector switch to “AF”.

● Effective Photography Range

Wide-angle: Approx. 50 cm to infinity
Telephoto : Approx. 90 cm to infinity

- For close-up photography, set the mode to MACRO (➡P.55).
- Check that the lens is clean. If it is dirty, clean the lens as described on P.113.

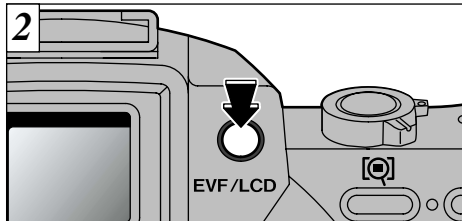

You can switch between using the viewfinder (EVF) and the monitor (LCD) to take pictures by pressing the EVF/LCD button.

- If “ CARD ERROR”, “ CARD NOT INITIALIZED” or “ WRITE ERROR” is displayed, first wipe the contact surface on the SmartMedia (gold-colored area) thoroughly with a soft, dry cloth and then reload the SmartMedia. If this does not resolve the problem, format the card.

The EVF/LCD selection setting is retained when the mode is switched or the camera is switched off.

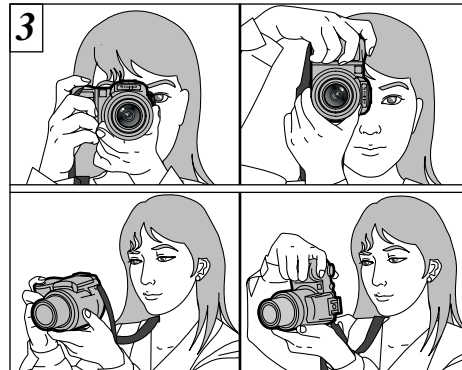

Put your arm through the shoulder strap so that the strap is looped around your shoulder. Hold the camera grip with your right hand and use your left hand to support the camera (lens) securely.

- Use of the automatic flash is recommended (➡P.52).
- Moving the camera when you take a picture can result in a blurred image. You should use the flash or a tripod to prevent camera shake, particularly when you are shooting in dark locations.

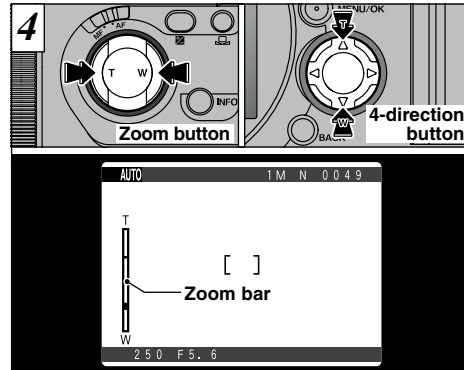

You can use the Zoom button or “▲” and “▼” on the 4-direction button to zoom in and out. To zoom in on the subject, press the T side of the button. To zoom out, press the W side. When you use the zoom, a “zoom bar” appears on the screen.

- Zooming pauses briefly when you switch between the optical zoom and the digital zoom (➡P.60).
- When you are shooting with the camera held on its side, you should use the 4-direction button to operate the zoom.
- The FinePix6900 ZOOM uses a 6× optical zoom with a focal length equivalent to 35 – 210 mm on a 35 mm camera. The focal length when the camera is switched on is equivalent to roughly 50 mm.

TAKING PICTURES (AUTO MODE)



Frame the shot so that the subject fills the entire AF (Auto Focus) frame.

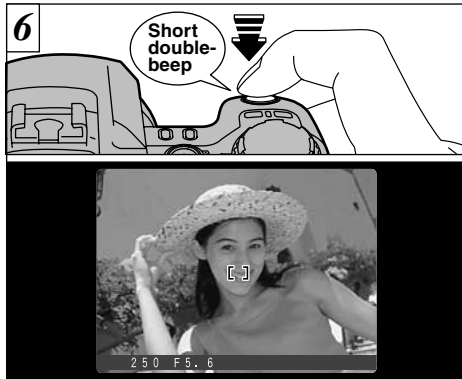

When you press the shutter button down halfway, the camera emits a short double-beep and focuses on your subject. At that point, the AF frame on the screen becomes smaller and the camera sets the shutter speed and aperture.

- ❗ If the camera does not emit a short double-beep and “!AF” appears on the screen, the camera cannot focus.
- ❗ When you press the shutter button down halfway, the image on the screen freezes temporarily. However, this image is not the recorded image.
- ❗ If “!AF” is displayed on the screen (e.g. the shot is too dark for the camera to focus), try standing about 2 m from your subject to take the picture.

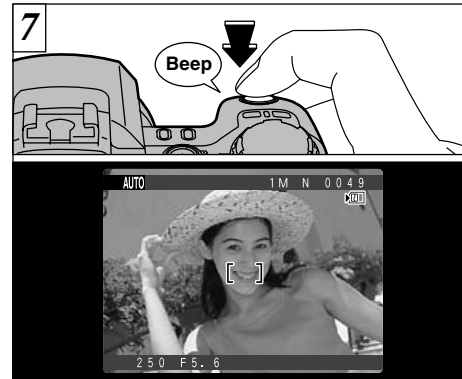

If you press the shutter button down halfway and then press the shutter button down fully without releasing it, the camera beeps once and takes the picture. The “AF” icon then appears on the screen and the shot is recorded as an image file.

- ❗ When the “AF” icon appears on the screen, image recording is in progress. Do not remove the SmartMedia while the icon is displayed.
- ❗ You cannot take the next shot when the number of available shots is displayed in red.

◆ Taking Pictures ◆

If the camera cannot focus, the AF frame does not change and the camera does not beep.

- To focus on your subject, use the AF/AE lock and focus on another subject that is roughly the same distance away and has about the same brightness (➡P.30).
- You can also focus the camera manually. (An easy solution is to use the one-touch AF function to focus on a subject that is roughly the same distance away. ➡P.59)
- If it is too dark to focus, move to roughly 2 m away from the subject and then take the picture.

- ❗ When you take a picture, the indicator lamp turns orange (photographs cannot be taken). When the indicator lamp turns green again, the camera is ready to take pictures.
- ❗ If you press the shutter button down fully in a single motion, the AF frame does not change size and the camera does not beep when the picture is taken.
- ❗ The indicator lamp flashes orange while the flash is charging.
- ❗ Refer to P.120 for information on warning displays.

TAKING PICTURES (AUTO MODE)

Indicator Lamp Display

Color	Status	Meaning
Green	Lit	Ready to shoot.
	Flashing	AF/AE in progress or camera shake warning. Recording to SmartMedia (the next picture can be taken).
Orange	Lit	<ul style="list-style-type: none"> Image being recorded onto the SmartMedia (the next picture cannot be taken). Battery charging in progress.
	Flashing	Flash charging.
Red	Flashing	<ul style="list-style-type: none"> SmartMedia warning. No SmartMedia loaded, SmartMedia not formatted, incorrect format, write-protect sticker used, SmartMedia full, SmartMedia error. Battery charging error. Lens operation error.

* Detailed warning messages are displayed on the screen (➡P.120).

Subjects Not Suitable for Autofocus

Though the FinePix6900 ZOOM uses an accurate autofocus mechanism, it may have difficulty focusing or not be able to focus at all for the types of subject and situation listed below. In such cases, the image may be out of focus.

- Very shiny subjects such as a mirror or car body.
- Subjects photographed through glass.
- Subjects that do not reflect well, such as hair or fur.
- Subjects with no substance, such as smoke or flames.
- When the subject is distant and dark.
- When there is very little contrast between the subject and the background (such as white walls or subjects dressed in the same color as the background).
- When a subject other than your main subject is close to the AF frame, has good contrast and is in front of or behind your main subject (such as a strongly contrasting person standing out against the background).
- Subjects moving at high speed.

In situations of this sort, use the AF/AE lock (➡P.30) or manual focus (➡P.58).

Number of Available Frames

The number of available shots appears on the screen.

- ! See P.97 for information on changing the File size and Quality setting.
- ! At shipment, the default settings are **1M** (for File Size) and NORMAL (for Quality).

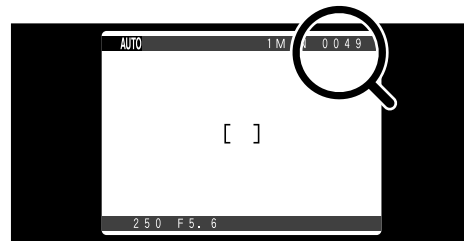

Standard number of shots per SmartMedia

Because the amount of data recorded varies depending on the subject, the number of available shots may not decrease when recording ends, or may decrease by 2 frames. Also, the discrepancy between the actual number of shots and the standard number of shots tends to be larger when there is more space remaining on the SmartMedia.

File Size	6M 2832 × 2128				3M 2048 × 1536		1M 1280 × 960		VGA 640 × 480
Quality Mode	HI	FINE	NORMAL	BASIC	FINE	NORMAL	FINE	NORMAL	NORMAL
Image Data Size	Approx. 17720KB	Approx. 2400KB	Approx. 1200KB	Approx. 460KB	Approx. 1300KB	Approx. 590KB	Approx. 620KB	Approx. 320KB	Approx. 90KB
MG-4S (4MB)	0	1	3	8	2	6	6	12	44
MG-8S (8MB)	0	3	6	17	6	13	12	25	89
MG-16S/SW (16MB)	0	6	13	33	12	26	25	49	163
MG-32S/SW (32MB)	1	13	28	68	25	53	50	99	330
MG-64S/SW (64MB)	3	26	56	137	50	107	101	198	663
MG-128SW (128MB)	7	53	113	275	102	215	204	398	1330

* The numbers of available shots are shown for formatted SmartMedia. 29

USING AF/AE LOCK



In a shot with this type of composition, the subjects (two people in this case) are not in the AF frame. If the shot is taken at this point, the subjects will not be in focus.



Move the camera slightly so that one of the subjects in the AF frame.

! Check that the focus mode selector switch is set to "AF".

◆ AF (Autofocus)/AE (Autoexposure) Lock ◆

On the FinePix6900 ZOOM, pressing the shutter button down half way locks the focus and exposure settings (AF and AE lock). If you want to focus on a subject that is not centered in the frame or change the picture composition after the exposure is set, you can obtain good results by changing the composition after the AF and AE settings are locked.

When you cannot focus and AF/AE lock does not give the correct exposure

- Position the AF frame over your main subject and apply the AE lock (➡P.56). Move the AF frame to another subject at roughly the same distance and press the shutter button halfway. Holding the shutter button down halfway, recompose your original shot and take the picture.



Press and hold the shutter button down halfway (AF/AE lock). The AF frame on the screen becomes smaller and the camera determines the shutter speed and aperture setting.



With the shutter button still held down halfway (AF/AE lock), move the camera back to the original image and press the shutter button down fully.

- ! You can reapply the AF/AE lock as many times as you like before releasing the shutter.
- ! The AF/AE lock operates in all photography modes and can be used to ensure excellent results.

FRAMING GUIDELINE FUNCTION

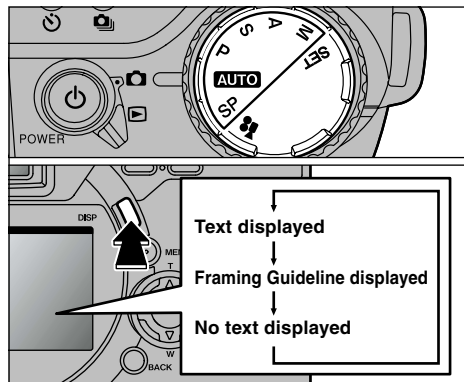

This function can be selected in the “**AUTO • SP • P • S • A** and **M**” photography modes. The screen display changes each time you press the “DISP” button. Press the “DISP” button to display the framing guideline.

- ⚠ The framing guideline is not recorded on the image.
- ⚠ The lines in the scene frame roughly divide the recorded pixels into three equal parts horizontally and vertically. When the image is printed, the resulting print may be shifted slightly from the scene frame.

Scene

Use this frame when you want to position your main subject in the center of the frame or when you want to align your shot with the horizon. This feature allows you to compose a shot that captures the moment while focusing on the subject size and the overall balance of the shot.

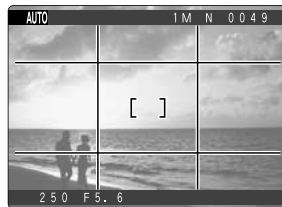

◆ Important ◆

Always use the AF/AE lock to compose your picture. Failing to use the AF/AE lock may result in the image being out of focus.

VIEWING YOUR IMAGES (PLAYBACK)

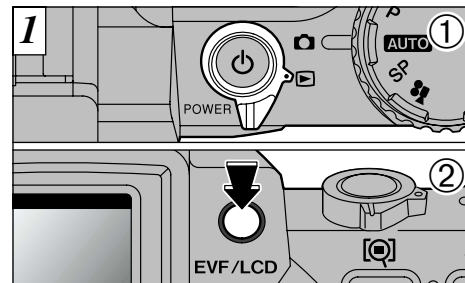

- ① Set the Mode switch to “▶”.
 - ② The setting toggles between the viewfinder (EVF) and the monitor (LCD) each time you press the “EVF/LCD” button.
- ⚠ When you set the Mode switch to “▶”, the last image shot is displayed.

The EVF/LCD selection setting is retained when the mode is switched or the camera is switched off.

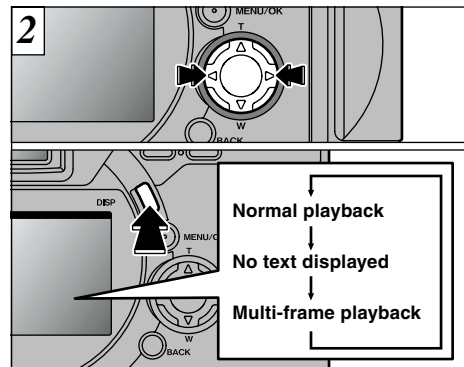

You can use “▶” and “◀” button to move forward and backward respectively through your images. The monitor display changes each time you press the “DISP” button.

- ⚠ If image on the monitor is difficult to see, adjust the monitor brightness (➡P.102).

◆ Images That Can be Viewed on the FinePix6900 ZOOM ◆

You can use this camera to view (excluding some uncompressed data) images recorded on an FinePix6900 ZOOM or images recorded onto a 3.3V SmartMedia using a FUJIFILM FinePix series, MX series and DX series digital camera.

FAST FORWARDING IMAGES

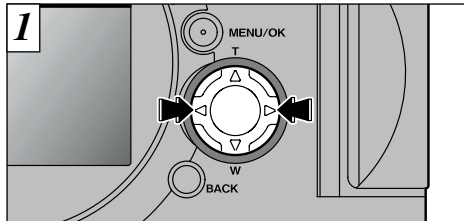

You can fast forward through the frames by holding down “◀” or “▶” button for about 1 second during playback.



During fast forward, 3 frames are shown together in miniature on the monitor. When you stop fast forward, the image enclosed in the frame is displayed on the monitor as a single image.

! A progress bar is displayed to show the approximate playback position on the SmartMedia.

PLAYBACK ZOOM

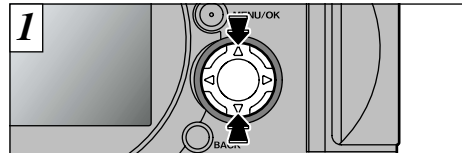

Pressing “▲” or “▼” during single-frame playback zooms in or out on the still image. A “zoom bar” is displayed during zooming.

● Zoom scales:

- 6M** 2832 × 2128 pixel images: Max 18×
- 3M** 2048 × 1536 pixel images: Max 13×
- 1M** 1280 × 960 pixel images: Max 8×
- VGA** 640 × 480 pixel images: Max 4×

! Pressing “◀” or “▶” during zooming cancels zooming and moves to the next image.

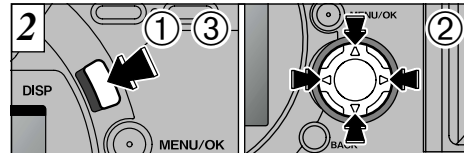

After you have zoomed in on your image,

- ① Press the “DISP” button.
- ② Use the “▲▼” and “◀▶” buttons to zoom in on different parts of the image.
- ③ Press the “DISP” button again to revert to zoomed display.

! Press the “BACK” button to return to normal unscaled display.

PLAYBACK ZOOM

Saving Trimmed Images

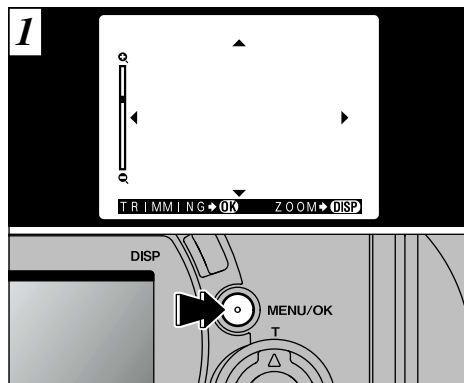

After you use the playback zoom, press the “MENU/OK” button to trim the image.

The size of the saved image varies depending on the zoom scale. In VGA mode, “TRIMMING▶OK” is displayed in yellow. At resolutions below VGA, “TRIMMING▶OK” is no longer displayed.



Check the size at which the image will be saved and then press the “MENU/OK” button. The trimmed image is saved as a separate file.

Image Sizes

3M	Suitable for A5 printing
1M	Suitable for A6 printing
VGA	“TRIMMING” is displayed in yellow since the quality is too low for printing.

* Because images with resolutions of less than **VGA** are not suitable for printing, “TRIMMING▶OK” is no longer displayed and trimmed images cannot be saved.

MULTI-FRAME PLAYBACK

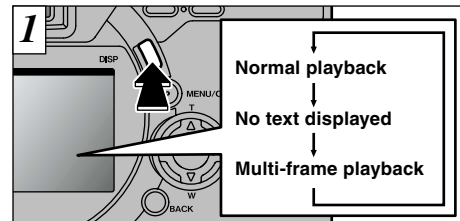

The displayed playback mode switches each time you press the “DISP” button. Press the “DISP” button to switch to multi-frame playback (9-frame).

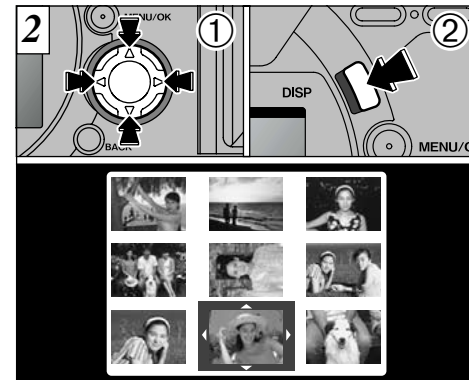

- ① Select a frame by using “▲”, “▼”, “◀” and “▶” to move the cursor (the orange box) to the desired frame. Press “▲” or “▼” several times to switch to the previous page or the next page.
- ② You can enlarge the selected image by pressing the “DISP” button again.

- ! The text displayed on screen disappears after about 3 seconds.
- ! Multi-frame playback cannot be used at the same time as playback zoom.

- ! Multi-frame playback is also useful for specifying erase, protect and DPOF settings for single frames and for selecting images when you want to check or cancel DPOF settings.

ERASING SINGLE FRAME

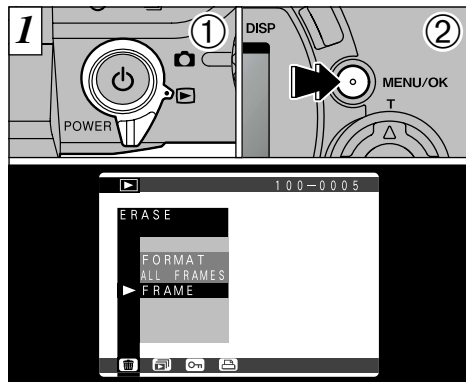

- ① Set the Mode switch to "▶".
- ② Press the "MENU/OK" button to display the menu screen on the monitor.

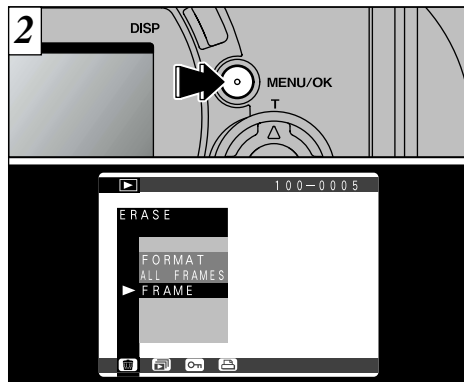

Select "FRAME" in the "ERASE" menu and press the "MENU/OK" button.

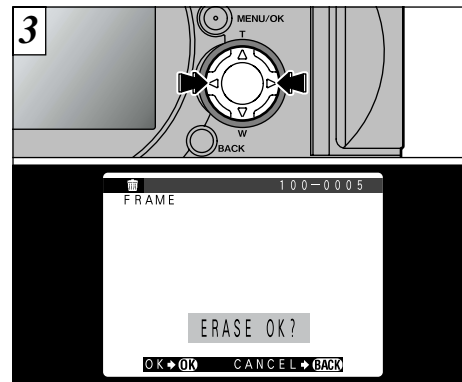

Press "◀" or "▶" button to display the image to be erased.

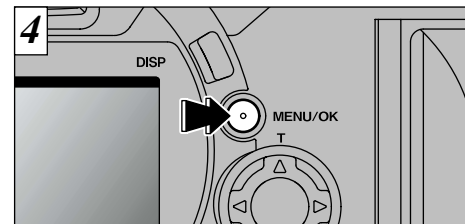

Press the "MENU/OK" button to erase the displayed image. When erasing is complete, the next image appears and the "⚠ ERASE OK?" message is displayed.

- ! See P.81 for more information on Erasing all frames and Formatting.
- ! Multi-frame playback (➡P.37) is an easy way to select images to be protected.

- ! To cancel single-frame erase, press the "BACK" button to return to the menu. To exit the menu screen, press the "BACK" button again.

- ! If "⚠ PROTECTED FRAME" is displayed, the image protection must be removed to erase the image (➡P.84).
- ! If the "⚠ DPOF SPECIFIED. ERASE OK?" message is displayed, DPOF is specified. When you press the "MENU/OK" button, the image is erased and the DPOF settings are updated.

To continue erasing images, repeat steps 3, 4.

USING A TV MONITOR

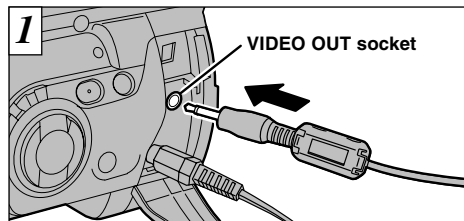

Switch off the camera and the TV. Plug the video cable (provided) into the “VIDEO OUT” socket on the camera.

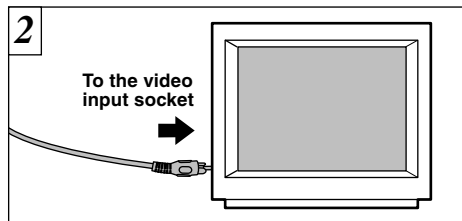

Plug the other end of the cable into the video input socket on the TV. Then switch the camera and TV on and take pictures or play back images as you would normally.

⚠ If there is a power outlet available, connect the AC-5VS/AC-5VH AC Power Adapter.

⚠ Refer to the instructions provided with your TV for more information on video input for your TV.

3 Advanced Features

ADVANCED FEATURES

The Advanced Photography section introduces a range of camera functions that you can access by setting the Mode switch to “”.

■ Photography mode specifications

Photography mode	Accessible menu settings	Factory default	Flash Photography (P.51)	Macro Photography (P.55)	AE lock (P.56)	Exposure Compensation (P.57)	MF (P.58)	Continuous Shooting (P.61)	Self-Timer Photography (P.62)
AUTO Auto (⇒P.42)	—	—		○	○	×	○	○	○
SP Scene Position (⇒P.42)									
Portrait (⇒P.43)	—	—							
Landscape (⇒P.43)				×		×	○	○	○
Sports (⇒P.43)					○	×	○	○	○
Night Scene (⇒P.43)									
Black and White (⇒P.43)				○					
P Programed Auto (⇒P.44)	Flash (⇒P.66) White balance (⇒P.66) Photometry (⇒P.69)	0 AUTO		○	○	○	○	○	○
S Shutter-priority Auto (⇒P.44)	Sensitivity (⇒P.70)	MULTI 100		○	○	○	○	○	○
A Aperture-priority Auto (⇒P.44)	Auto bracketing (⇒P.70) Sharpness (⇒P.72)	OFF NORMAL		○	○	○	○	○	○
M Manual (⇒P.46)	Multi-exp (⇒P.72) External Flash (⇒P.74)	OFF OFF		○	×	×	○	○	○
Movie (⇒P.48)	—	—	×	×	×	×	×	×	×

* The flash cannot be used when “” Continuous Shooting or “” Auto Bracketing is selected.

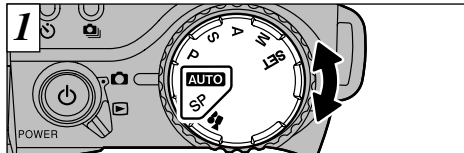

Turn the Mode dial to select the setting.

AUTO Auto

This is the simplest mode for taking pictures and can be used in a wide range of situations.

SP : Scene Position

This mode provides photography settings tailored to particular types of shot.

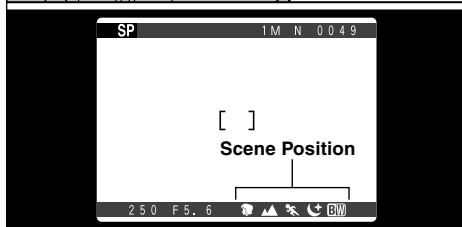
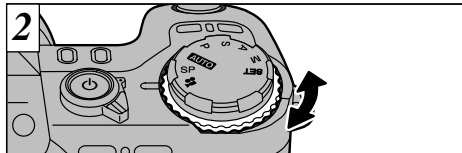

In “**SP** Scene Position” mode, you can select 5 types of shot (👤 • 🏔️ • 🌸 • 🌃 • 🖼️). Turn the command dial to select the setting.

👤 Portrait

Use this mode for shots of people. Portrait mode provides soft-tone images with natural skin colors.

● When using the flash

Auto Flash, Red-Eye Reduction, Forced Flash, Slow Synchro.

🏔️ Landscape

Use this mode for daytime shots of scenery. Landscape mode provides crisp, clear shots of buildings, mountains and other scenery.

● When using the flash

The Flash mode is automatically set to Suppressed Flash. This setting cannot be changed.

🌸 Sports

Use this mode for moving objects. Sports mode gives priority to faster shutter speeds.

● Shutter

Takes pictures using fast shutter speeds.

● When using the flash

Auto Flash or Forced Flash only.

🌃 Night Scene

Use this mode for shots taken in the evening or at night. Night Scene mode gives priority to slower shutter speeds.

● Shutter

Slow shutter speed mode with speeds as slow as 3 seconds.

● When using the flash

Slow Synchro, Red-Eye Reduction+Slow Synchro only.

🖼️ Black and white

You can use this option to shoot in black and white regardless of the type of scene.

● Using flash

Auto flash, Red-Eye Reduction, Forced Flash, Slow Synchro.

With the exception of “**🖼️** Black and White mode, the macro setting cannot be selected.

🔊 In “**AUTO**” or “**SP**” mode, the sensitivity is set to ISO

100.

PHOTOGRAPHY MODE **P: PROGRAMED/S: SHUTTER-PRIORITY/A: APERTURE-PRIORITY**

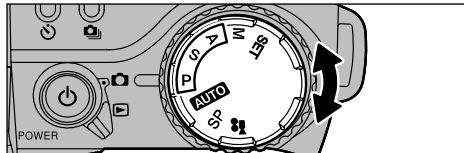

Turn the Mode dial to select a setting.

P: Programed Auto

This is an automatic mode that selects the shutter speed and aperture for you but still allows you to select the other camera settings. Like the Shutter-priority and Aperture-priority modes, this mode is relatively simple to use (Program Shift).

S: Shutter-priority Auto

This is an automatic mode that allows you to set the shutter speed. You can use this mode to take shots that freeze movement (fast shutter speeds) or that give the impression of movement (slow shutter speeds).

A: Aperture-priority Auto

This is an automatic mode that allows you to set the aperture. You can use this mode to take shots with a blurred background (wide aperture) or with both foreground and background in sharp focus (narrow aperture).

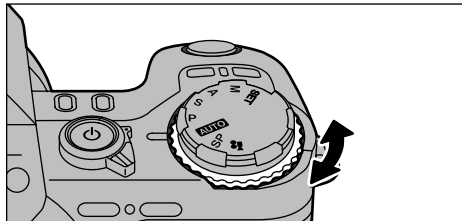

Turning the Command dial gives you access to the following :

P : Program Shift

S : Shutter speed setting (1step: 1/3 EV)

ISO 100 3 sec. to 1/1000 sec.

ISO 200 3 sec. to 1/1000 sec.

ISO 400 1.6 sec. to 1/1000 sec.

A : Aperture setting

F2.8 to F11 in 1/3 EV steps

See P.65 – 76 for information on the Photography menu.

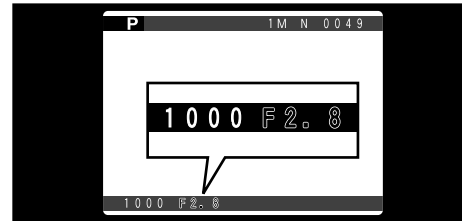

If you exceed the control range for the photography mode (as with a scene that is extremely overexposed or underexposed), the shutter speed or aperture is displayed in red on the screen (⇒P.13).

Set the correct exposure compensation for the shooting conditions (⇒P.57).

Program Shift

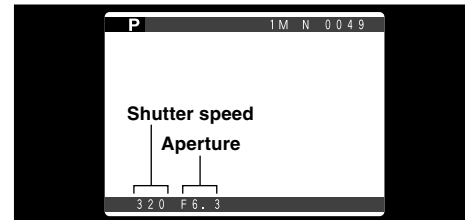

This function allows you to select different shutter speed and aperture setting combinations without changing the exposure setting. In Program Shift mode, the shutter speed and aperture settings are displayed in yellow. Program Shift is cancelled when you switch modes or switch the camera off.

PHOTOGRAPHY MODE M: MANUAL

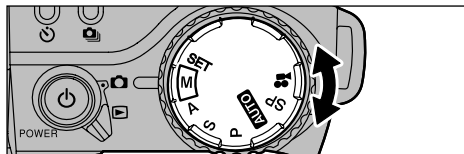

Turn the Mode dial to select the settings.

M: Manual

This mode allows you to set any shutter speed or aperture setting.

● Shutter speed setting (1 steps: 1/3 EV)

ISO 100 3 sec. to 1/1000 sec.

ISO 200 3 sec. to 1/1000 sec.

ISO 400 1.6 sec. to 1/1000 sec.

● Aperture setting

F2.8 to F11 in 1/3 EV steps

Shutter Speed Setting

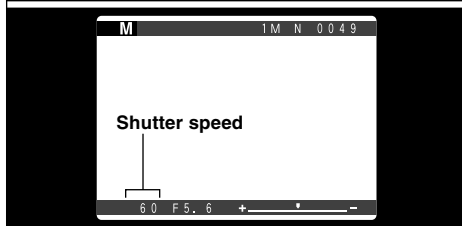
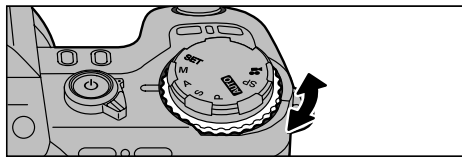

Turn the Command dial to set the shutter speed.

Aperture Setting

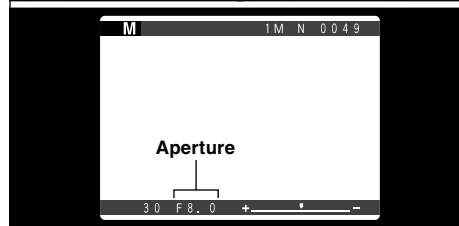
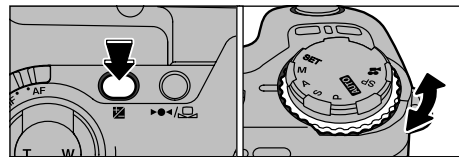

Set the aperture by holding down the “” (exposure compensation) button and turning the Command dial.

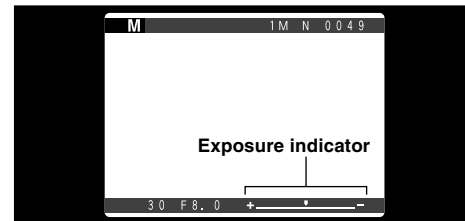

Use the exposure indicator on the monitor as a guide to setting the exposure. Moving the indicator towards plus gives an overexposed image (plus displayed in yellow), while moving the indicator towards minus (minus displayed in yellow) gives an underexposed image.

See P.65 – 76 for information on the Photography menu.

46 See P.112 for more information on EVs.

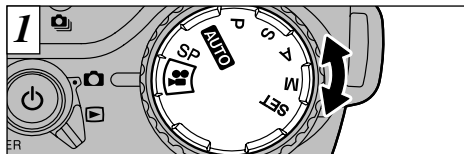

Turn the Mode dial to select the settings.

Movie

Use this mode to shoot up to 160 seconds of video per movie.

- **Movie format:** Motion JPEG (➡P.112)
320 × 240 pixels
10 frames per second
Without sound

⚠ Depending on the space available on the SmartMedia, the time that can be recorded in one movie may be shorter than 160 seconds.

If you use the FinePix6900 ZOOM to record a movie that is longer than 80 seconds and then attempt to play back the movie on a different camera model, the “ READ ERROR” message appears and playback may fail.

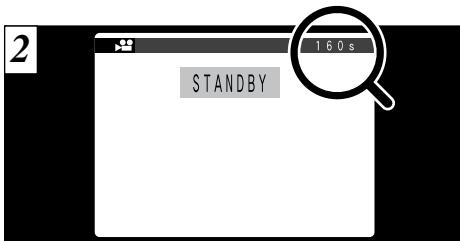

The available shooting time and the “STANDBY” message are shown on the monitor.

■ SmartMedia standard shooting time

SmartMedia Capacity	Available recording time
MG-4S (4MB)	Approx. 23 sec.
MG-8S (8MB)	Approx. 47 sec.
MG-16S (16MB)	Approx. 94 sec.
MG-32S (32MB)	Approx. 191 sec.
MG-64S (64MB)	Approx. 385 sec.
MG-128S (128MB)	Approx. 774 sec.

*The numbers of available shots are shown for formatted SmartMedia.

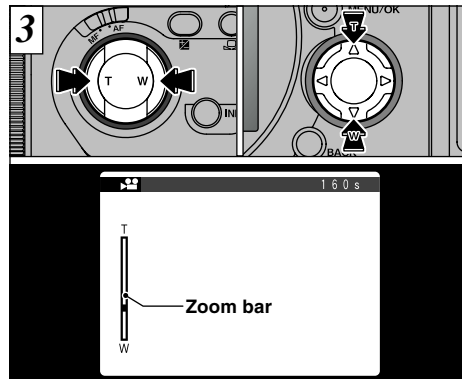

In Movie mode, the lens is locked at the wide-angle setting and only the digital zoom can be used. You can use the Zoom button or the 4-direction button “▲” and “▼” to zoom in and out. When you use the zoom, a “Zoom bar” appears on the screen.

● Digital zoom focal distance

Approx. 35 mm to 70 mm (1.4 in. to 2.8 in.)
(Approx. 2×)

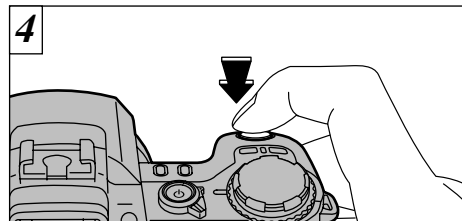

Shooting begins when you press the shutter button down fully.

- ⚠ You do not need to hold down the shutter button.
- ⚠ The focus is fixed at 50 cm (1.6 ft.) to infinity.
- ⚠ The focus and white balance are fixed during shooting, but the exposure varies automatically to suit the scene being shot.

The white balance is automatically set when you press the shutter button down fully.

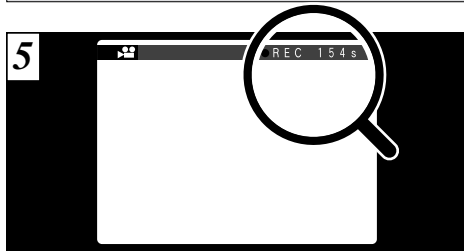

During shooting, a timer in the top-right corner of the monitor counts down the remaining time.

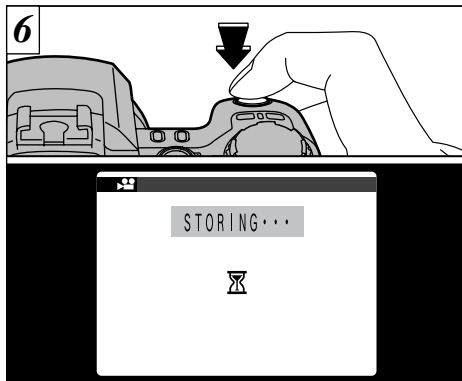

If you press the shutter button during shooting, shooting ends and the movie is recorded on the SmartMedia.

- ! It takes about 22 seconds to record an 160 second movie (roughly 24MB) onto a SmartMedia.
- ! If you start shooting and then immediately end shooting, only 3 seconds of movie is recorded onto the SmartMedia.

- ! Once the remaining time runs out, shooting automatically ends and the movie is recorded on the SmartMedia.

FLASH PHOTOGRAPHY

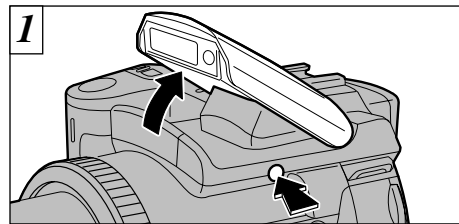

Press the flash pop-up button to set the flash.

● Effective flash range (for "AUTO")

Wide-angle: Approx. 0.3 m to 3.6 m (1 ft. to 11.8 ft.)

Telephoto : Approx. 0.9 m to 3.2 m (2.9 ft. to 10.5 ft.)

(Built-in flash guide number: 8 (at ISO 100))

- ! You cannot use the flash in "MOVIE" mode.
- ! If the photography mode is "AUTO", use the Auto Flash mode.
- ! When you pop the flash up, the image shown on the screen may disappear and the screen may go dark. This is because the flash is charging. In this event, the indicator lamp flashes orange.

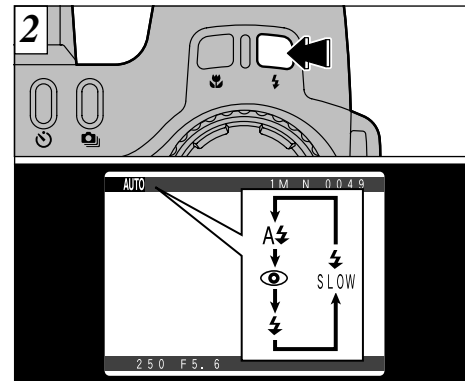

Press the "⚡" button to select the flash setting. The flash setting changes each time you press the "⚡" button.

- ! The available flash settings are limited depending on the photography mode (→P.41).
- ! See P.74 for information on using external flash units.

FLASH PHOTOGRAPHY



⚡ Auto Flash Mode

Use this mode for ordinary photography. The flash fires automatically as required by the shooting conditions.



👁 Red-Eye Reduction

Use this mode to ensure that the subject's eyes appear natural when photographing people in low-light conditions.

The flash fires a pre-flash just before the picture is taken and then fires again to take the actual picture.

! The 👁 red-eye reduction flash in “**AUTO**” or “**SP**” mode fires automatically when required by the conditions.

◆ Red-Eye Effect ◆

When you use the flash to photograph people in low-light conditions, their eyes sometimes appear red in the picture. This is caused by the light of the flash reflecting off the inside of the eye. Use Red-Eye Reduction flash to effectively minimize the likelihood of the red-eye effect.

Take the following measures to make Red-Eye Reduction more effective :

- Get the subjects to look at the camera.
- Get as close as possible to the subjects.



⚡ Forced Flash

Use this flash mode to photograph backlit scenes, such as a subject against a window or in the shade of a tree, or to obtain the correct colors when you are shooting under lighting such as fluorescent tubes. In this mode, the flash fires in bright as well as dark conditions.



⚡ SLOW Slow Synchro

This is a flash mode that uses a slow shutter speed. This allows you to take pictures of people at night that clearly show both your subjects and the nighttime backdrop.

👁 SLOW Red-Eye Reduction + Slow Synchro

Use this mode for slow synchro shots with red-eye reduction.

- ! The image may be overexposed when you shoot bright scenes.
- ! Because a slow shutter speed is used, a tripod should be used to prevent camera shake.

To take a picture of a main subject at night with the background brightly lit, please use the “**SP**” mode “**🌃**” (Night Scene) settings (➡P.43).

FLASH PHOTOGRAPHY



④ Suppressed Flash

Pressing the flash down switches the camera to Suppressed Flash mode.

Use this mode for photography using indoor lighting, for shots taken through glass, and for photography in venues such as theaters or at indoor sporting events where the distance is too great for the flash to be effective. When you use Suppressed Flash, the Auto White Balance function (⇒P.112) operates so that natural colors are captured along with the ambience of the available light.

- ⚠ If you are shooting in Suppressed Flash mode in dark conditions, use a tripod to prevent camera shake.
- ⚠ See P.28, 121 for information on the camera shake warning.

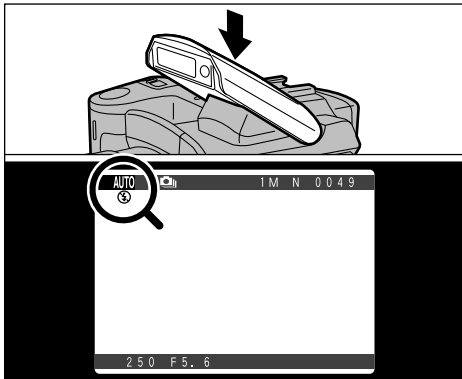

Close the flash to switch to Suppressed Flash mode.

In the modes listed below, the flash pops up but the “④” icon appears on the monitor and the flash cannot be used.

● Modes in which flash cannot be used

- ▲ Landscape (⇒P.43)
- 📷 Continuous shooting (⇒P.61)
- 📷 Auto bracketing (⇒P.70)

🌸 MACRO (CLOSE-UP) PHOTOGRAPHY

This mode can be selected in the “**AUTO** • **BW** • **P** • **S** • **A** and **M**” photography modes. Selecting Macro mode allows you to take close-up shots.

● Effective Photography Range:

Approx. 10 cm – 80 cm.

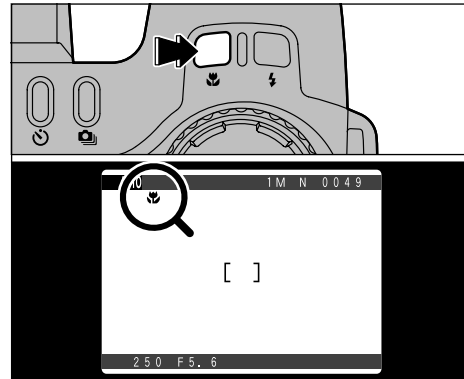

When you press the “🌸” button, the “🌸” icon appears on the screen and the camera is in Macro mode. Press the “🌸” button again to cancel Macro mode.

⚠ Macro photography is automatically cancelled in the following situations:

- When the photography mode is switched to “**SP** (excluding **BW**) • **📷** • **SET**”.
- When you switch to Playback mode.
- When the camera is switched off.

AE-L: USING AE LOCK

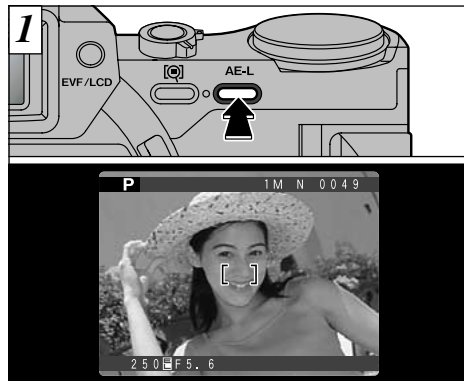

This mode can be selected in the “**AUTO** • **SP** • **P** • **S** and **A**” photography modes.

Use this function when you want to take pictures with the exposure fixed for a particular subject. Frame the shot so that the subject occupies most of the center of the screen and then press the “AE-L” button.

The “[]” icon appears on the screen and the exposure is locked while you hold down the “AE-L” button.

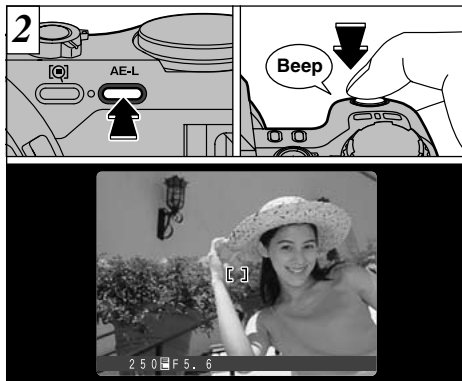

With the “AE-L” button held down, press the shutter button down halfway to focus the shot and then compose the shot again.

- ! Once you press the shutter button down halfway, the exposure remains locked even if you release the “AE-L” button.
- ! When the AE lock is applied, pressing the shutter button down halfway only sets the focus.

EXPOSURE COMPENSATION

This mode can be selected in the “**P** • **S** and **A**” photography modes.

Use this function for shots where you cannot obtain the optimum brightness (exposure), such as shots with extremely high contrast between the subject and the background.

- ! Exposure compensation is disabled in the following situations:

- When “” (Forced Flash) or “” (Red-eye Reduction) mode is used and the scene photographed is dark

◆ Subjects for Which Exposure Adjustment is Particularly Effective ◆

Exposure indicator moved towards + (plus)

- Copying of printed text (black characters on white paper) +4 steps (+1.3 EV)
- Backlit portraits +2 to +4 steps (+0.7 to +1.3 EV)
- Very bright scenes (such as snowfields) and highly reflective subjects +3 steps (+1 EV)
- Shots made up predominantly of sky. +3 steps (+1 EV)

Exposure indicator moved towards – (minus)

- Spotlit subjects, particularly against dark backgrounds –2 steps (–0.7 EV)
- Copying of printed text (white characters on black paper) –2 steps (–0.7 EV)
- Scenes with low reflectivity, such as shots of pine trees or dark foliage –2 steps (–0.7 EV)

- ! See P.112 for more information on EVs.

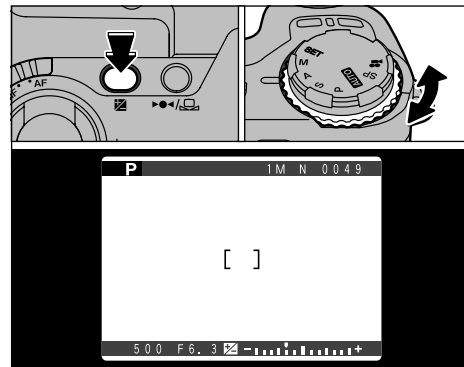

To select the Exposure Compensation setting, hold down the “” button and turn the Command dial. The symbol indicating the compensation direction (“–” or “+”) turns yellow. The “” symbol also turns yellow while exposure compensation is being set and then turns blue after setting is completed.

- **Compensation range:** –2 to +2 EV, in 1/3 EV steps

This setting is retained when the mode is switched or the camera is switched off (The “” icon is displayed). Set the exposure compensation to “0” unless compensation is required.

SETTING THE MANUAL FOCUS

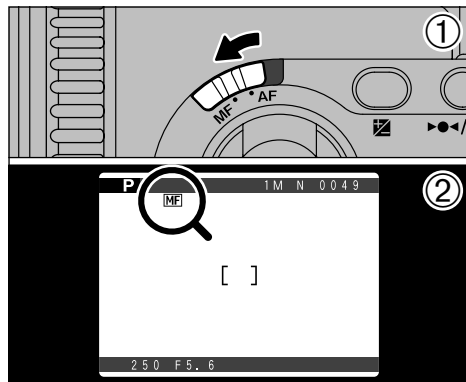

Manual focus can be used in all photography modes except “”. Use manual focus for subjects that are not suitable for Auto Focus or where you want the focus fixed for a shot.

- ① Slide the focus mode selector switch to “MF”.
- ② The “MF” icon appears on the screen.

◆ Mastering Manual Focusing ◆

Use a tripod to prevent the image becoming unfocused when the camera moves.

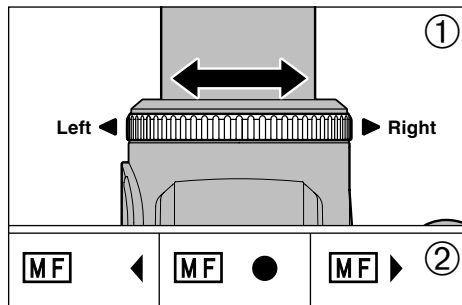

- ① Turn the focusing ring to focus on the subject in the AF frame.
- ② A focusing indicator mark appears on the screen. Adjust the focus until “●” appears.

■ Focusing Indicator Marks

The focusing mark appears when you move the focus a set amount (close to the focused position). Use the mark as a guide to focusing.

●	The shot is focused.
▶	The camera is focused too close. Turn the focusing ring to the right.
◀	The camera is focused too far away. Turn the focusing ring to the left.

One-touch AF Function

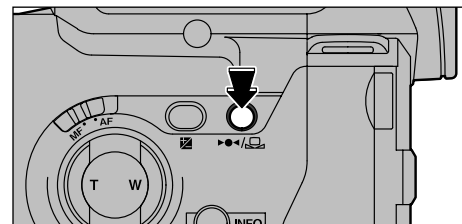

Use this function to focus your shot quickly. When you press the “/” button, the camera uses the autofocus function to focus on the subject.

! The focus indicator is not displayed in one-touch AF mode.

[Q] Focus Check Function

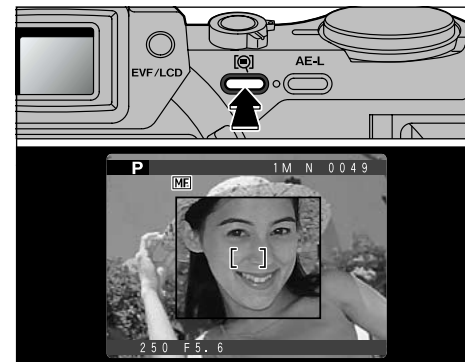

Use this function when it is difficult to see whether the image is focused. When you press the “[Q]” (Focus Check) button, the central portion of the image is shown enlarged and you can focus using the enlarged image. Pressing the “[Q]” button again returns you to the normal view.

! When the file size is “VGA” and you are using the digital zoom (telephoto zoom settings), the enlarged display does not appear.

DIGITAL ZOOM

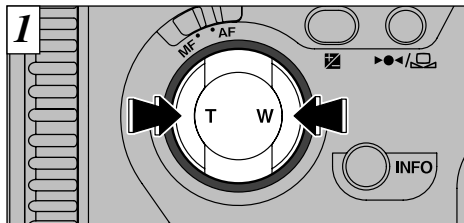

You can use the digital zoom function for all Resolution (File Size) settings other than “6M”.

● To use the digital zoom

Use the optical zoom to zoom in fully (telephoto) and then press the “T” button again.

● To revert to optical zoom

Use the digital zoom to zoom out fully (wide-angle) and then press the “W” button again.

- ⚠ You cannot use the digital zoom for resolutions of “6M”.
- ⚠ When you switch to digital zoom, the video image on the monitor no longer changes smoothly.
- ⚠ The optical zoom is equivalent to approximately 35 mm – 210 mm on a 35 mm camera.
- ⚠ See P.97 for information on changing the file size setting.

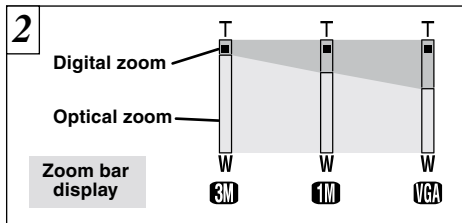

A “zoom bar” appears on the screen. If the image goes out of focus during zooming, press the shutter button down halfway to make it easier to check the shot.

● Digital zoom focal lengths

3M : Equivalent to approx. 210 mm – 294 mm (1.4×)

1M : Equivalent to approx. 210 mm – 462 mm (2.2×)

VGA : Equivalent to approx. 210 mm – 924 mm (4.4×)

Movie: Equivalent to approx. 35 mm – 70 mm (2×)

CONTINUOUS SHOOTING

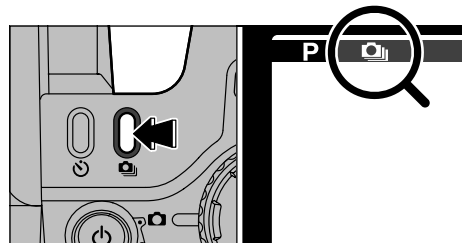

Continuous shooting can be specified in all photography modes except “P”.

Selecting continuous shooting allows you to shoot up to 5 frames continuously at intervals as short as 0.2 seconds.

When you press the “C” button, the “C” icon is displayed and continuous shooting is selected. Press the “C” button again to cancel continuous shooting.

- ⚠ You cannot use the flash in this mode.
- ⚠ The continuous photography speed is the same regardless of the quality and file size settings.

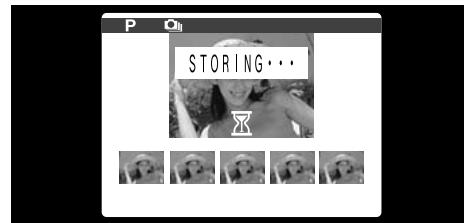

When you take a series of shots, the resulting shots are displayed (shown in order from left to right) and automatically saved.

- ⚠ The focus and exposure are determined for the first frame and cannot be changed during shooting.
- ⚠ The results of the shot are displayed even when the photographed image display is set to OFF (→P.98).
- ⚠ The time required to record a file is approximately 21 seconds in “6M NORMAL” mode (for 5-frame continuous shooting).

If you want to select the shots to be recorded, see P.98.

SELF-TIMER PHOTOGRAPHY

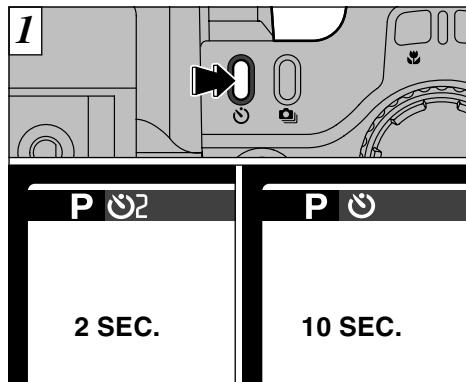

Manual focus can be used in all photography modes except “”. Each time you press the “” button, the setting moves one step in the sequence “2 SEC.” → “10 SEC.” → “OFF”.

◆ 2-second Photography ◆

This feature is useful when pressing the shutter button causes camera shake even with the camera on a tripod.

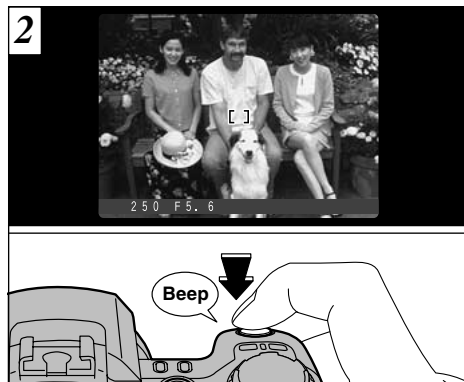

Position the AF frame over the subject and press the shutter button. The camera focuses on the subject in the frame and self-timer starts to run.

- ! You can also use the AF/AE lock (→P.30).
- ! Take care not to stand in front of the lens when you press the shutter button as this can prevent the correct focus or brightness (exposure) being obtained.

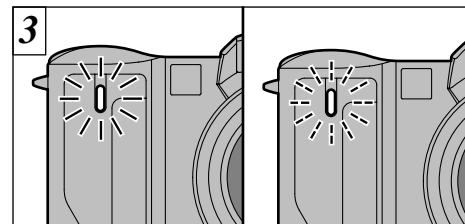

The self-timer lamp lights and then starts flashing until the picture is taken.

- ! To stop the self-timer, once it has started running, press the “BACK” button.

■ Self-timer Lamp Display

	Flashing for 2 seconds
	Lit for 5 seconds → Flashing for 5 seconds.

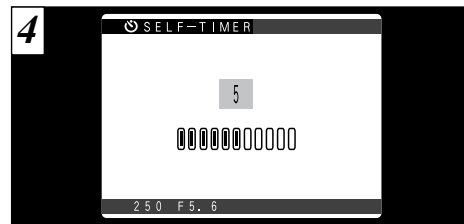

A countdown is displayed on the screen indicating the time remaining until the picture is taken. Self-timer mode is automatically cancelled after each shot.

PHOTOGRAPHY INFORMATION

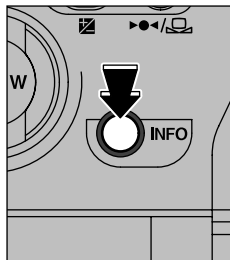

If you cannot recall the current photography settings, you can check them by holding down the “INFO” button.

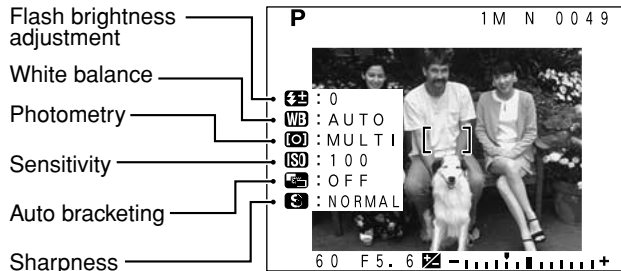

! The photography information is not displayed in “**AUTO** • **SP**” or “**Ⓜ**” mode.

! You can only use this function to check the settings, not to change them.

PHOTOGRAPHY MENU

PHOTOGRAPHY MENU OPERATION

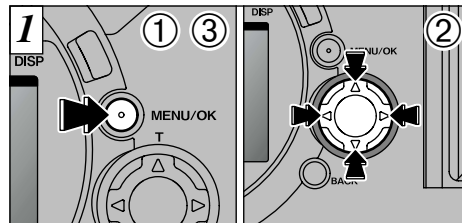

- ① Press the “MENU/OK” button to display the menu.
- ② Use “◀” and “▶” to select the menu item and “▲” and “▼” to change the setting.
- ③ Press the “MENU/OK” button to confirm the setting.

! You cannot access the menu settings in “**AUTO** • **SP**” or “**Ⓜ**” mode. See P.41 for details.

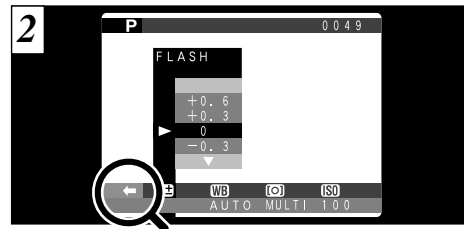

To move to another menu page, press “◀” or “▶” button for the arrows in the menu (“◀” or “▶”).

FLASH BRIGHTNESS ADJUSTMENT

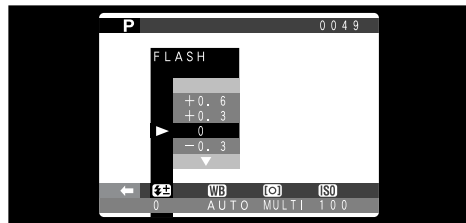

This mode can be selected in the “P·S·A·M” photography modes.

Use this setting when you cannot obtain the correct brightness, such as when the flash does not reach the subject (is too faint) or when you are using the flash for a close-up shot.

- The range for exposure compensation is ± 2 levels (-0.6 to $+0.6$ EV in 0.3 EV increments). Exposure compensation only functions with the built-in flash. See P.112 for more information on EVs.

WB SETTING THE WHITE BALANCE

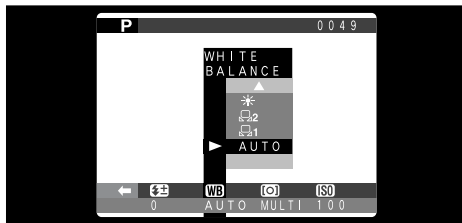

This mode can be selected in the “P·S·A·M” photography modes.

Change the white balance setting when you want to take a picture with the white balance fixed for the surroundings and lighting when the picture is taken.

In Auto mode, the correct white balance may not be obtained for subjects such as close-ups of people's faces and shots taken under a special light source. In such situations, select the correct white balance for the light source. See P.112 for more information on the white balance.

AUTO: Automatic adjustment
(Shooting to show the ambience of the light source)

- 1 : Custom white balance
- 2 : Custom white balance
- : Shooting outdoors in fine weather
- : Shooting in shade
- : Shooting under “Daylight” fluorescent lamps
- 2 : Shooting under “Warm White” fluorescent lamps
- 3 : Shooting under “Cool White” fluorescent lamps
- : Shooting in incandescent light

*The white balance setting (unless it is a Custom White Balance setting) is ignored when you use the flash. To achieve the desired effect in your shot, press the flash back down to suppress flash operation (➡P.54).

◆ Custom White Balance ◆

Use this function when you want to match the white balance accurately for a particular light source. You can also use this function to achieve special effects.

Custom White Balance Setting

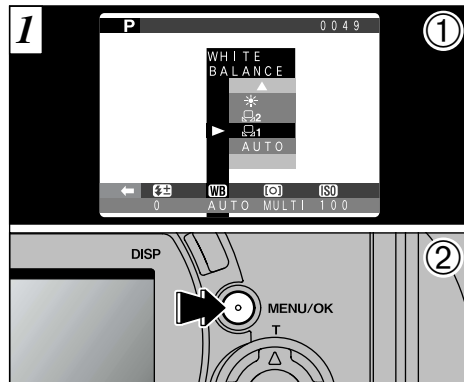

- ① Select custom white balance “1” or “2”.
- ② Press the “MENU/OK” button.

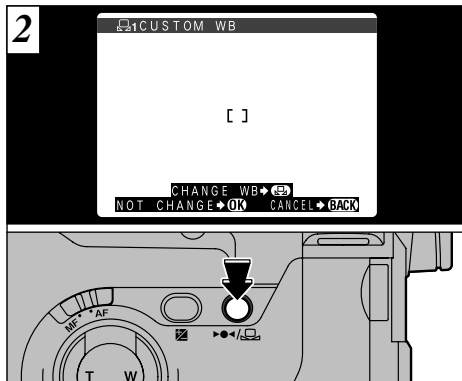

Using the light source for which you want to set the white balance, hold a sheet of white paper so that it fills the entire screen. When you press the “/” button, a measurement is taken and the white balance is set.

❗ The white balance setting does not affect the image shown on the screen.

To use the white balance set previously, press the “MENU/OK” button without pressing the “/” button.



If “OVER” or “UNDER” is displayed, the white balance was not measured at the correct exposure. Reset the white balance.

- ❗ After you take the picture, you should check the “Color (White Balance)” setting for the image.
 - Set “IMAGE DISPLAY” in the SET-UP menu to “PREVIEW” (➡P.98).
 - Set the Mode switch to “” (➡P.33).

◆ Example ◆

You can deliberately change the white balance for a photographed image by using colored paper instead of white paper.

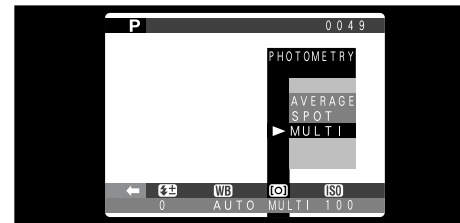

This mode can be selected in the “P • S • A • M” photography modes. Use this mode for scenes where the brightness of the subject and background differ markedly so that the Multi setting is unlikely to achieve the desired result.

- **AVERAGE:** Light metering where an average value for the entire image is used.
- **SPOT** : Light metering where the exposure is optimized for the center of the image.
- **MULTI** : Light metering where the camera automatically assesses the scene and selects the optimum exposure.

❗ The camera is fixed in Multi mode when “AUTO • SP” or “” is selected.

◆ The light metering modes are effective for the following subjects ◆

● AVERAGE

The advantage of this mode is that the exposure tends not to change for different compositions or subjects. This mode is particularly effective for shots of people wearing black or white clothing and shots of scenery.

● SPOT

This mode is useful for subjects with strongly contrasting light and dark areas where you want to achieve the correct exposure for a particular feature.

● MULTI

In this mode, the camera uses automatic scene recognition to analyze the subject and provide optimum exposure in a wide range of shooting conditions. This mode should be used for everyday photography.

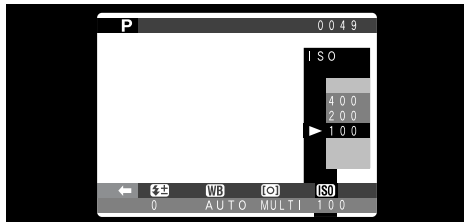
ISO SETTING THE SENSITIVITY

This mode can be selected in the “P·S·A·M” photography modes.

Use this setting when you want to take bright pictures indoors without using a flash or when you want to use a fast shutter speed. (to prevent camera shake, etc.)

● **Settings:** 100, 200, 400

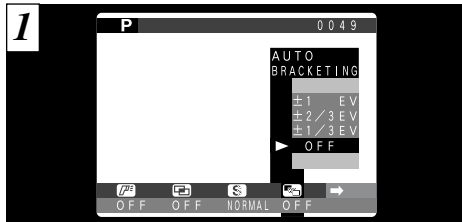
AUTO BRACKETING

This mode can be selected in the “P·S·A·M” photography modes.

Use this feature to photograph the same image with different exposure settings. Auto bracketing automatically shoots 3 consecutive frames, one of which is correctly exposed while the remaining two are underexposed and overexposed respectively by a set amount.

● The three available settings are $\pm 1/3$, $\pm 2/3$ and ± 1 EV. See P.112 for more information on EVs.

⚠ Flash photography cannot be used.

⚠ This feature always takes 3 shots. However, if there is insufficient space on the SmartMedia for 3 shots, no picture will be taken.

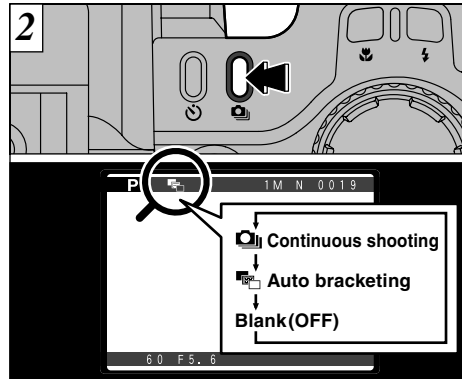

After selecting AUTO BRACKETING, press the “” button so that the “” icon appears on the screen. The mode switches (· · Blank) each time you press the “” button.

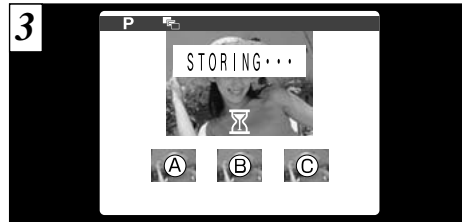

When you take a picture, the resulting shots are displayed (A)correct exposure, (B)overexposed, (C)underexposed) and then automatically saved.

- ⚠ The focus is determined for the first frame and cannot be changed during shooting.
- ⚠ The photographed images are displayed even when “OFF” is selected as the “IMAGE DISPLAY” setting” (➡ P.98).
- ⚠ It takes about 12 seconds to record the image data (NORMAL: **6M**).

If you want to select the shots to be recorded, see P.98.

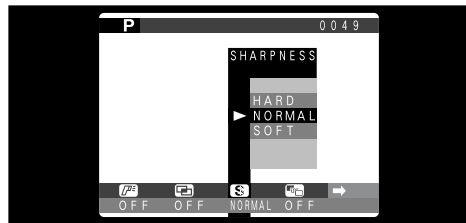

This mode can be selected in the “P·S·A·M” photography modes.
Use this setting to soften or emphasize outlines or to adjust the image quality.

- **HARD** : Emphasizes the outlines.
Best for shots of subjects such as buildings or text where you want sharp images.
- **NORMAL**: Best for ordinary photography.
Provides edge sharpness that is ideal for ordinary shots.
- **SOFT** : Softens the outlines.
Best for shots of subjects such as people, where a softer image is desirable.

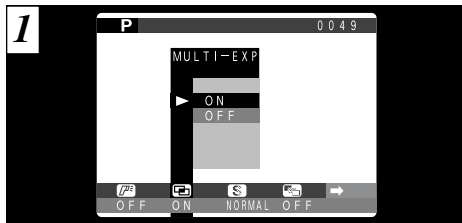

This mode can be selected in the “P·S·A·M” photography modes.
Multi-exposure provides a way of overlaying photographed images on top of each other to give a final image that cannot be obtained through normal photography.

- ⚠ If the photographed image is overexposed, use negative compensation in the Brightness (exposure compensation) setting to correct the exposure (⇒P.57).
- ⚠ Only the optical zoom can be used for multi-exposure shots. The digital zoom (⇒P.60) does not function.
- ⚠ This mode is automatically cancelled when you switch the camera off.

Continuous shooting (⇒P.61) and Auto bracketing (⇒P.70) are disabled when Multi-Exp is selected.

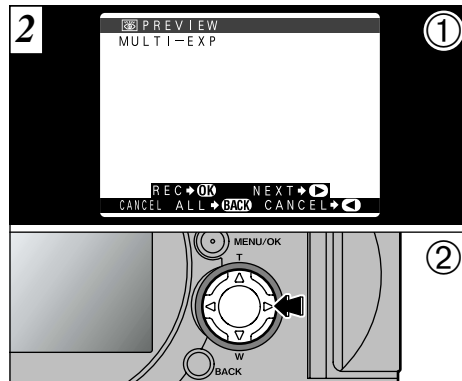

- ① A preview screen appears when you take a picture.
- ② Press “▶” to move to the next image frame.

- ⚠ Changing the photography mode exits multi-exposure mode without recording the images.

You cannot change the photography menu settings or the FILE SIZE/QUALITY setting during shooting.

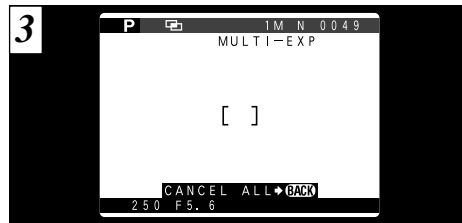

When you take the next (multi-exposure) shot, the images are overlaid and displayed in the preview screen.

- To overlay more images: Press “▶”.
- To record the current image: Press “MENU/OK”.
- To return to the previous image: Press “◀”.
- To stop without recording any images:
Press the “BACK” button.

- ⚠ A preview image is always shown, regardless of the IMAGE DISPLAY setting. However, note that the Preview Zoom function cannot be used (⇒P.98).

There is no limit on the number of multiple exposures.

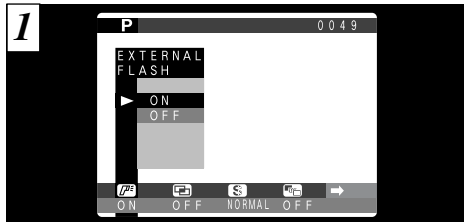

This mode can be selected in the “P • S • A • M” photography modes. Set this setting to “ON” when you are using an external flash.

● **Synchronization speed:** Up to 1/1000 sec.

! Set the white balance (➡P.66) to AUTO or Custom White Balance (➡P.76).

◆ Compatible Flash Units ◆

Flash units that can be used with this camera must meet the following 3 conditions :

- The aperture can be set.
- External flash synchronization can be used.
- The sensitivity can be set.

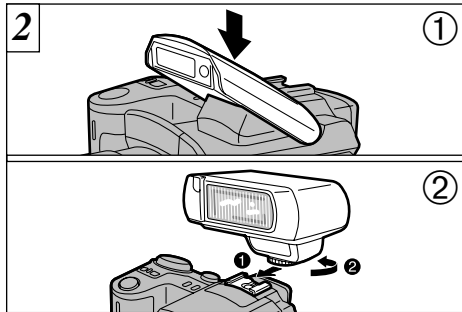

- ① Close the built-in flash.
- ② Mount the external flash on the camera's hot shoe.

! Built-in and external flash units cannot be used at the same time.

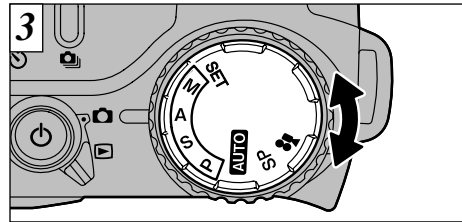

Select “P • S • A” (➡P.44) or “M” (➡P.46). However, the use of “A” or “M” mode is recommended.

! Flash photography cannot be used when continuous shooting (➡P.61) or auto bracketing (➡P.70) is selected.

When you are using an external flash, always specify a fixed aperture setting.

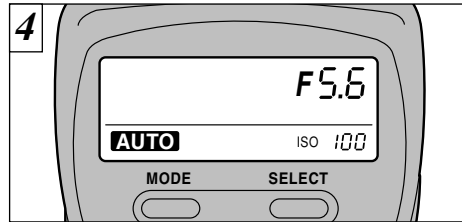

External Flash Settings

For external flash, refer to the user's manual for the flash and specify the settings as described below.

- Match the settings to the camera aperture setting. In “P” or “S” mode, match the settings to the aperture measured by the camera.
- Match the sensitivity setting (➡P.70) to the setting on the camera.
- Select External Flash mode (TTL mode cannot be used).

When the White Balance is Incorrect

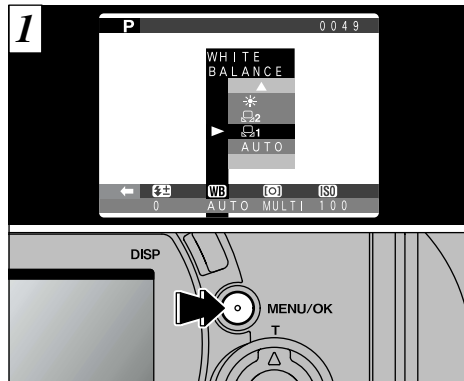

Match the white balance to the external flash settings.

In “WB” in the Photography menu (➡P.66), select “1 • 2” Custom White Balance. Press the “MENU/OK” button.

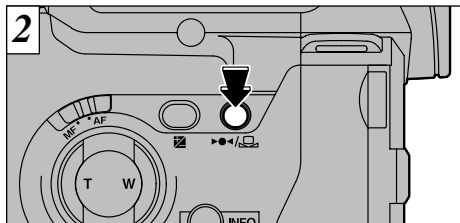

Hold a sheet of white paper so that it fills the entire screen. Then press the “1 • 2” button to fire the flash and set the white balance.

- ⚠ After you take the picture, you should check the “Color (White Balance)” setting for the image.
- In SET-UP, set IMAGE DISPLAY (➡P.98) to POSTVIEW.
 - Set the Mode switch to “” (➡P.33).

The Advanced Features Playback section introduces a range of playback functions that you can access by setting the Mode switch to “”.

■ Playback mode menu

Playback image	Menu options that can be set
STILL IMAGES (➡P.33)	ERASING (SINGLE/ALL FRAMES/FORMATTING) (➡P.38, 81) PLAYBACK (AUTOMATIC PLAYBACK) (➡P.83) PROTECTION (➡P.84) DPOF (Digital Print Order Format) (➡P.88)
MOVIE (➡P.79)	ERASING (SINGLE/ALL FRAMES/FORMATTING) (➡P.38, 81) PLAYBACK (AUTOMATIC PLAYBACK) (➡P.83) PROTECTION (➡P.84)

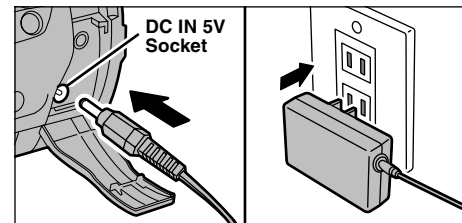

If you are close to a power outlet, you should use the AC Power Adapter AC-5VS/AC-5VH (sold separately) to avoid any loss of power during still image or movie playback (➡P.18).

PLAYBACK INFORMATION

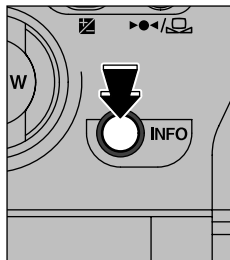

This function allows you to check the photography information. Hold down the “INFO” button to check the information.

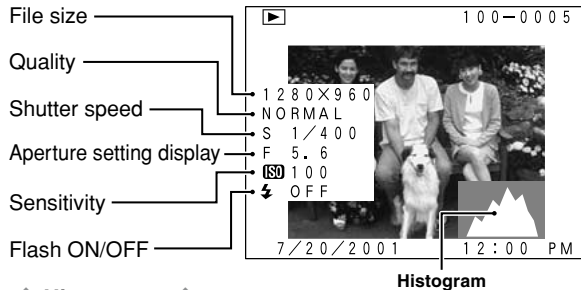

◆ Histograms ◆

A histogram is a chart showing the distribution of brightness in an image (horizontal axis: brightness; vertical axis: pixels).

- ① Optimal exposure: There is an ample distribution of pixels overall with a peak in the middle range.
- ② Underexposed : The number of shadow pixels is high with the distribution sloping down to the left.
- ③ Overexposed : The number of highlight pixels is high with the distribution sloping down to the right.

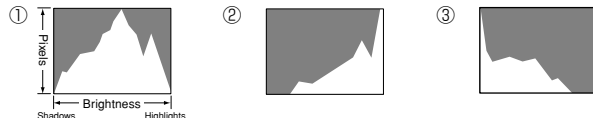

! The shape of the graph will vary depending on the subject.

! This function cannot be used during multi-frame playback (⇒P.37).

MOVIE PLAYBACK

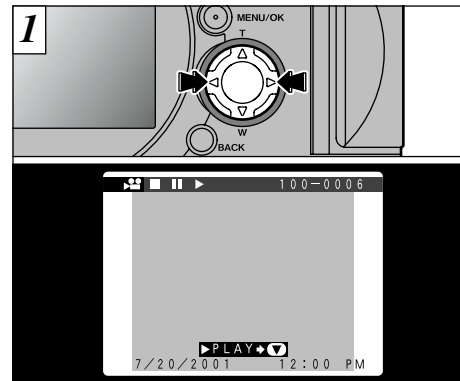

Use “◀” or “▶” to select the movie file.

! Movies cannot be played back using multi-frame playback. Use the “DISP” button to revert to normal playback.

Movies are displayed somewhat smaller than still images.

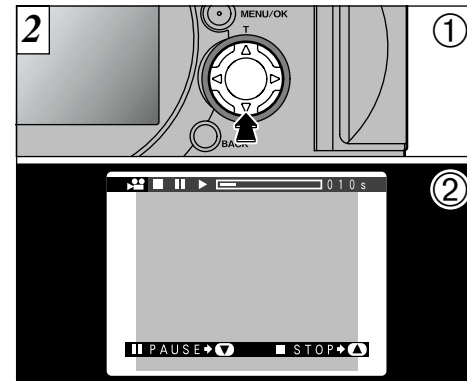





- ① Press “▼” to play the movie.
- ② The monitor shows the playback time and a playback progress bar.

! If the subject of the movie is very bright, white streaks may appear on the image during playback. This is normal and is not a fault.

See P.80 for more detailed information on playing back movies.

MOVIE PLAYBACK

■ Playing Back Movies

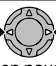
	Control	Description
Playback		The movie automatically stops when playback ends.
Pause/Resume		Pauses the movie during playback. Press this button again when the movie is paused to resume playback.
Stop		Stops playback.
Fast forward/Rewind	Rewind  Forward	Press these during playback to skip forwards or backwards through the movie.
Skip playback	 When paused	<ul style="list-style-type: none"> Each time you press “◀” or “▶” when the movie is paused, the movie advances or goes back one frame. Hold down the button to move through the frames quickly.

* See P.104 for information on playing back movies on your PC.

◆ Compatible Movie Files ◆

The FinePix6900 ZOOM can play back movie files up to 160 seconds in length recorded using a FinePix6900 ZOOM or recorded onto 3.3V SmartMedia using a FUJIFILM digital camera. If you attempt to play back a movie that is longer than 160 seconds, the “**! READ ERROR**” message appears and playback fails.

PLAYBACK MENU



ERASING SINGLE • ALL FRAMES/FORMATTING

FRAME

Erases only the selected file.

! Protected files (➡P.84, 86) are not erased.

ALL FRAMES

Erases all unprotected files.

FORMAT

Erases all the data and reformats (initializes) the SmartMedia for use with this camera.

! Formatting also erases protected files.

! If “**! CARD ERROR**”, “**! CARD NOT INITIALIZED**”, “**! READ ERROR**” or “**! WRITE ERROR**” is displayed, first wipe the contact surface on the SmartMedia (gold-colored area) thoroughly with a soft, dry cloth and then reload the SmartMedia. If this does not resolve the problem, format the card.

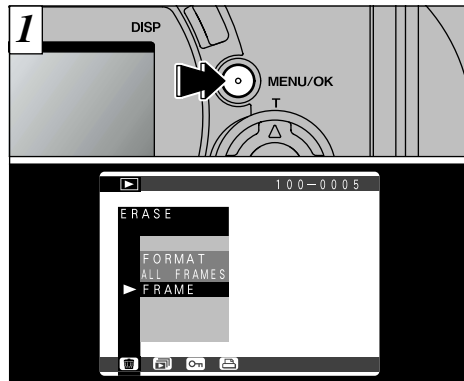

If you press the “MENU/OK” button, the menu screen will appear on the monitor.

! Press the “BACK” button to exit the menu.

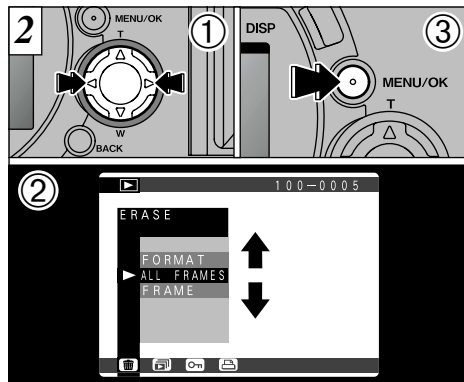

- ① Press “◀” or “▶” to select “ ERASE”.
- ② Use the “▲” and “▼” buttons to select “FRAME”, “ALL FRAMES” or “FORMAT”.
- ③ Press the “MENU/OK” button.

A confirmation screen appears.
If you are erasing all the frames, or formatting the card, press the “MENU/OK” button to proceed.
If you are erasing one frame, use the “◀” and “▶” buttons to select the frame and then press the “MENU/OK” button.

- ❗ To cancel “ ERASE”, press the “BACK” button.
- ❗ If the “ DPOF SPECIFIED. ERASE ALL OK?” message is displayed, DPOF is specified. When you press the “MENU/OK” button, the image is erased.

Formatting erases all the data on the SmartMedia, including protected files.

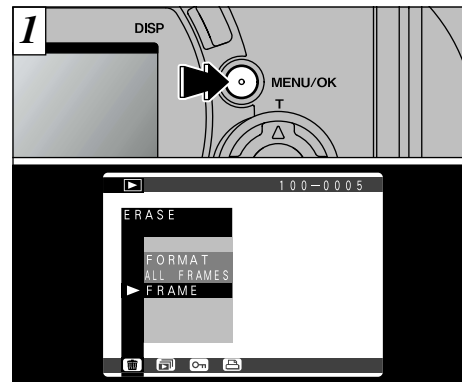

Press the “MENU/OK” button to display the menu on the monitor.

- ❗ The Auto Power Off function does not operate during playback.
- ❗ Movie playback begins automatically. When playback ends, the camera advances to the next frame.

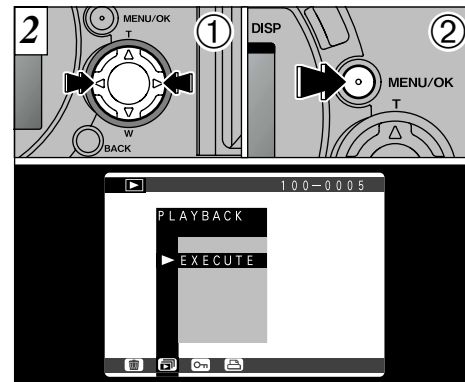

- ① Press “◀” or “▶” to select “ PLAYBACK”.
- ② Press the “MENU/OK” button. The image frames are automatically advanced and played back.

- ❗ If you press the “DISP” button once during playback, the playback frame number is displayed on the monitor.
- ❗ To interrupt “ PLAYBACK”, press the “BACK” button.

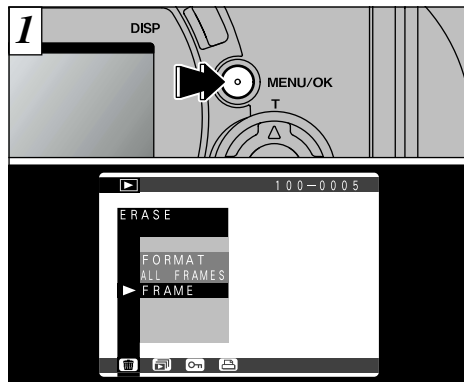

Press the “MENU/OK” button to display the menu on the monitor.

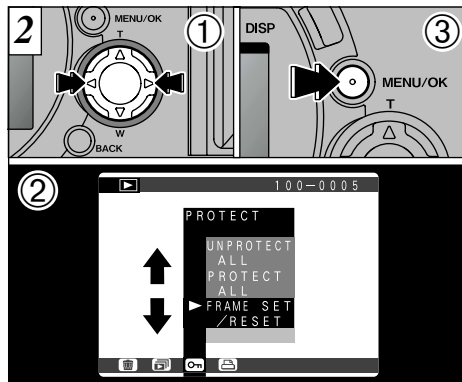

- ① Use “◀” or “▶” to select “ PROTECT”.
- ② Press “▲” or “▼” to select “FRAME SET/RESET”.
- ③ Press “MENU/OK”.

! Multi-frame playback is an easy way to select images to be protected (➡P.37).

Protection:

A setting that prevents images from being inadvertently erased (➡P.81).

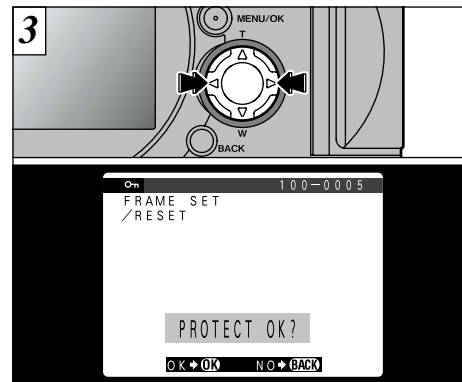

Use “◀” or “▶” to select the image to be protected.

! If you do not want to protect any images, press the “BACK” button to return to the menu. To exit the menu screen, press the “BACK” button again.

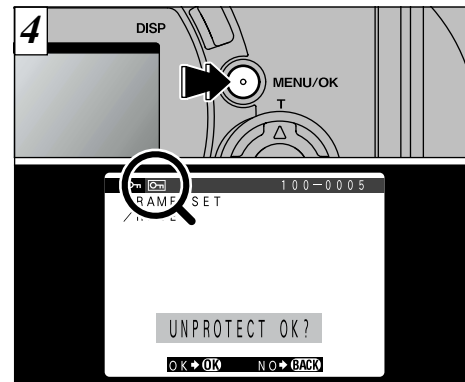

When you press the “MENU/OK” button, the image is protected and the “ ” icon appears on the screen. To remove the protection, press the “MENU/OK” button again.

To protect another image, repeat steps 3, 4.

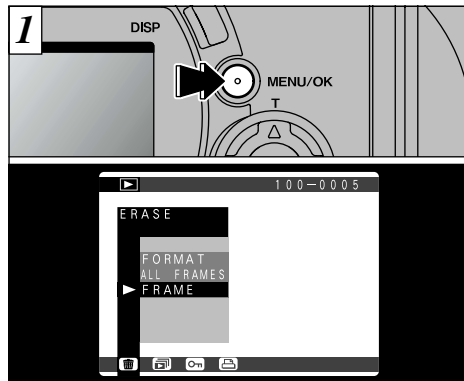

Press the “MENU/OK” button to display the menu on the monitor.

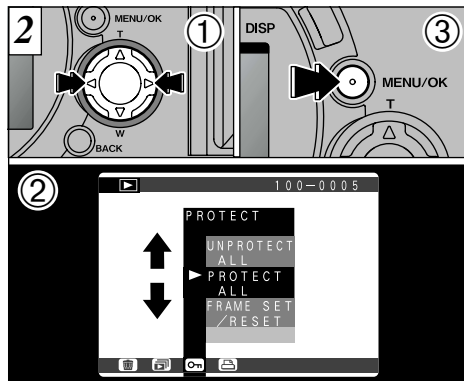

- ① Use “◀” or “▶” to select “”.
- ② Press “▲” or “▼” to select “PROTECT ALL” or “UNPROTECT ALL”.
- ③ Press “MENU/OK”.

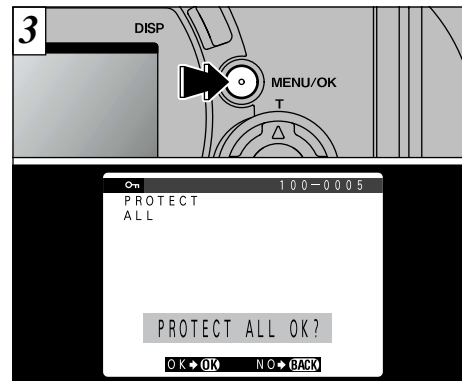

A confirmation screen will appear to proceed, press the “MENU/OK” button.

Formatting erases all images, including protected images (⇒P.81).

! If you do not want to protect any images, press the “BACK” button to return to the menu. To exit the menu screen, press the “BACK” button again.



DPOF stands for Digital Print Order Format and refers to a format that is used for recording printing specifications for images shot using a digital camera on media such as SmartMedia. The recorded specifications include information on which frames are to be printed and how many prints of each frame are required.

This section gives a detailed description of how to order your prints with the FinePix6900 ZOOM.

*Note that some printers do not support date and time imprinting or specification of the number of prints.

*Note that the warnings shown below may be displayed while you are specifying the prints.

! DPOF SPECIFIED. ERASE OK? (→P.120)

When you erase the image, the DPOF setting for that image is deleted at the same time.

! RESET UNMATCHED DPOF OK? (→P.121)

If you load a SmartMedia that contains frames specified for printing on another camera, those print specifications are all reset and replaced by the new print specifications.

! DPOF FILE ERROR (→P.121)

No more than 999 frames can be specified on the same SmartMedia.

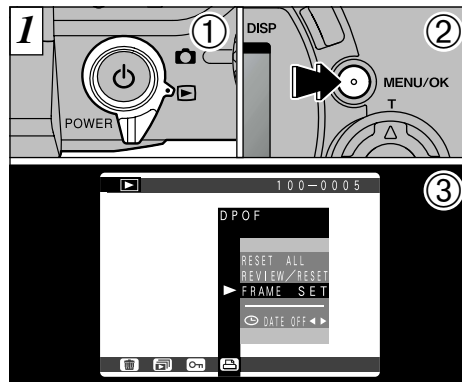

This function allows you to select whether or not the date of shooting is included on the print.

- ① Set the Mode switch to “”.
- ② Press the “MENU/OK” button to display the menu on the monitor.
- ③ Press “” to select “”.

! DPOF settings cannot be specified for movie file.

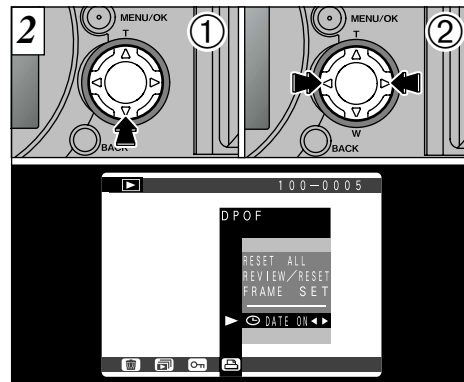

- ① Use “” to select “ DATE OFF”.
- ② Press “” or “” to select “DATE ON” or “DATE OFF”. This setting remains valid until you change the setting or switch the camera off.

! Before specifying any other settings, first specify whether date is to be shown or not.

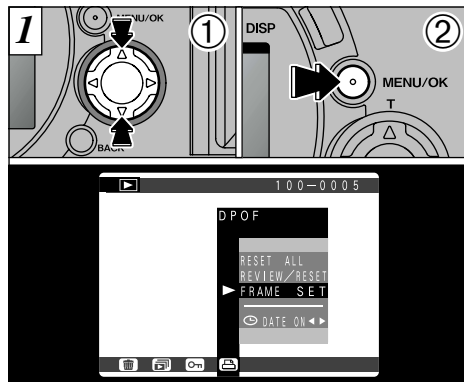

- ① Use the “▲” or “▼” to select “FRAME SET”.
- ② Press the “MENU/OK” button.

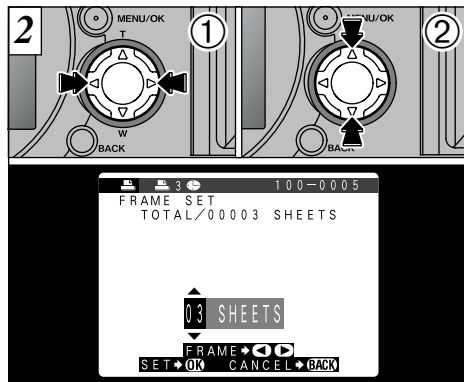

- ① Use “◀” or “▶” to display the frame to be specified.
- ② Use “▲” or “▼” to specify the number of prints. The “ ” icon and the number of prints is displayed for the frames for which settings have been confirmed. If the date has been set, the “ ” icon is also displayed.
- ! Using “◀” or “▶” to move forwards or backwards a frame automatically confirms the setting.

To continue using “FRAME SET”, repeat steps ① and ②.

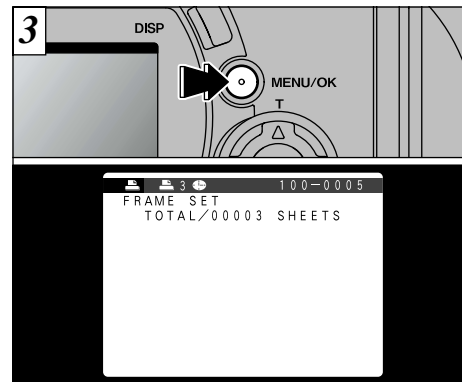

<To Apply the Settings>

When you have finished specifying the DPOF settings, always press the “MENU/OK” button to confirm the settings. The total number of prints appears on the monitor and the menu screen reappears.

- ! You can specify up to 99 prints for each frame. Also, the maximum number of frames that can be specified for printing on the same SmartMedia is 999.
- ! “TOTAL” shows the total number of prints specified.

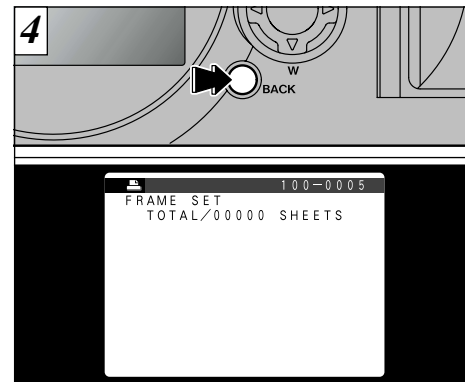

<To Cancel the Settings>

Pressing the “BACK” only cancels the setting for the currently selected frame. You cannot cancel settings for frames other than the currently selected frame.

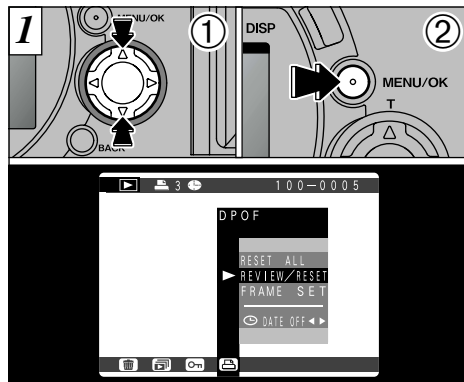

- ① Use “▲” or “▼” to select “REVIEW/RESET”.
- ② Press the “MENU/OK” button.

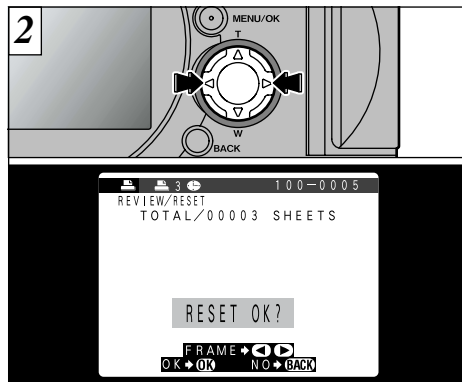

Pressing “◀” or “▶” plays back only the frames for which the number of prints has been specified, allowing you to check the settings for each frame.

- ! Multi-frame playback is an easy way to select images (⇒P.37).
- ! If you do not want to check or delete the DPOF settings, press the “BACK” button to return to the menu. To exit the menu screen, press the “BACK” button again.

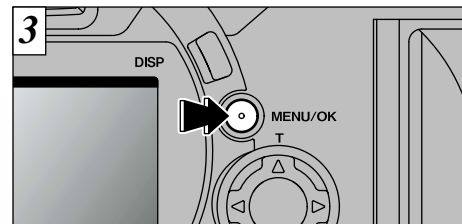

To delete the print setting, display the image for which the setting is to be deleted and then press the “MENU/OK” button. When the print setting has been deleted, the next image appears with the “RESET OK?” message displayed.

- ! If all the print settings are cancelled, the “TOTAL” reverts to “00000” and the monitor screen background turns blue.

To delete further print settings, repeat steps ②, ③.

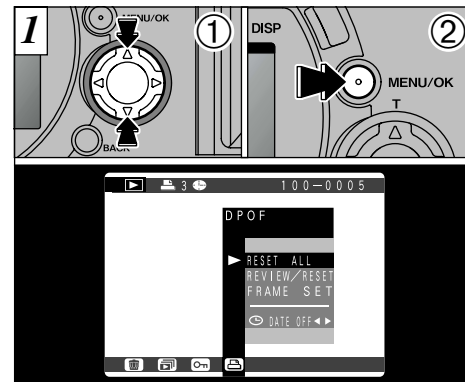

- ① Use “▲” or “▼” to select “RESET ALL”.
- ② Press the “MENU/OK” button.



2



A confirmation screen will appear to protect all images. Press the “MENU/OK” button.

3



A confirmation screen appears. To proceed, press the “MENU/OK” button.

5

Settings

SET SET-UP MODE

► The table below explains the camera setting

Settings	Display	Factory default	Explanation
FILE SIZE/ QUALITY	SET	NORMAL	Use this option to set the number of recorded pixels (file size) and quality (compression rate). See P.97 for details.
IMAGE DISPLAY	OFF/ POSTVIEW/ PREVIEW	OFF	Use this setting to specify whether a preview image (showing the photographed image) is displayed after a picture is taken. See P.98 for details.
AUTO POWER SAVE	2 MIN/5 MIN/OFF	2 MIN	Use this setting to specify whether the camera is switched to low power mode and then automatically switched off when the camera controls are not being used. See P.100, 112 for details.
DATE/TIME	SET	—	Sets the date and time. See P.22 for details.
FRAME NO.	RENEW/CONT.	RENEW	Specifies whether the Frame No. Memory function is used. See P.101 for details.
BEEP	LOW/HIGH/OFF	LOW	Sets the volume of the tone emitted when the camera is used.
LANGUAGE	ENGLISH/ FRANCAIS	ENGLISH	Select English or French as the language used for screen display.
RESET ALL	OK	—	Resets all settings other than the date/time, custom white balance measurement and EVF/LCD setting to the factory default values. When you press “►”, a confirmation screen appears. To proceed, press the “MENU/OK” button again.

* See the next page for information on procedures. 95

SET USING THE SET-UP SCREEN

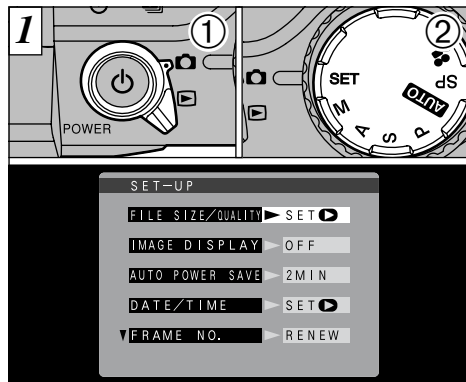

- ① Set the Mode switch to "CAMERA".
- ② Set the Mode dial to "SET" to display the SET-UP screen.

⚠ Always switch the camera off when you are replacing the batteries. If you open the battery cover or disconnect the AC power adapter without switching the camera off, all the camera settings may revert to the factory default values.

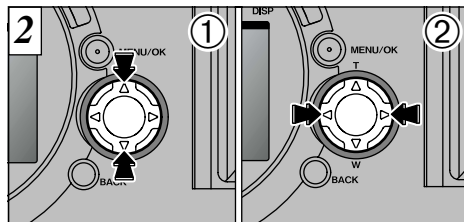

- ① Press "▲" or "▼" to select a setting.
- ② Use "◀" or "▶" to change the settings.

⚠ Press "▶" to select "FILE SIZE/QUALITY", "DATE/TIME" or "RESET ALL".

SET SETTING THE FILE SIZE AND QUALITY (COMPRESSION RATIO)

You can choose any combination of 4 file sizes and 4 image quality settings. Use the table below as a guide to the best settings for your shots.

File size	HI	FINE	NORMAL	BASIC
6M (2832 × 2128)	①	①	①	②
3M (2048 × 1536)	—	②	②	—
1M (1280 × 960)	—	③	③	—
VGA (640 × 480)	—	—	④	—

- ①: For printing the whole image at A4 size or printing a part of the image at A5 or A6 size
- ②: For printing the whole image at A5 size or printing a part of the image at A6 size
- ③: For printing at A6 size
- ④: For use via the Internet as an e-mail attachment, etc.

Quality (compression ratio)

Select "HI" or "FINE" for better image quality and "BASIC" to increase the number of available shots. In most cases, the "NORMAL" setting provides more than adequate image quality.

⚠ The recording time for the "HI" setting is longer than for other quality settings.

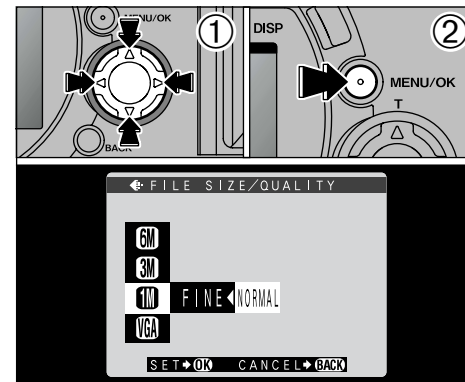

- ① Use "▲" or "▼" to change the file size setting and "◀" or "▶" to change the quality setting.
- ② Press the "MENU/OK" button to confirm the setting.

⚠ There are 9 combinations of file size and quality settings in total (→P.29).

When the mode switch is set to "CAMERA" (excluding "CAMERA"), holding down "SHIFT" and pressing "CAMERA" switches you to the settings screen.

SET IMAGE DISPLAY

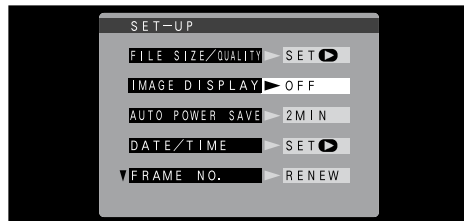

This setting allows you to specify whether the photographed image is displayed after you take a picture.

OFF : The photographed image is automatically recorded without being displayed.

POSTVIEW: The photographed image is displayed for about 2 seconds and is then automatically recorded.

PREVIEW: The photographed image is displayed and you can then select whether to record the image. You can also select preview zoom and recorded images.

- Press "MENU/OK" to record the image.
- Press "BACK" to discard the image.

⚠ In Continuous Shooting and Auto Bracketing modes, images are displayed for a set time and then automatically recorded even when "OFF" is selected as the "IMAGE DISPLAY" setting.

Preview Zoom

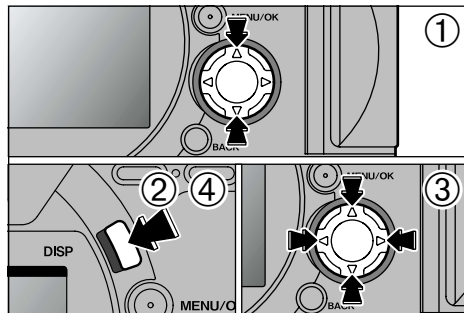

You can enlarge the preview to check the image details.

- ① Use "▲" or "▼" to zoom in or out.
- ② Press the "DISP" button.
- ③ Use the "▲▼" and "◀▶" buttons to zoom in on different parts of the image.
- ④ Press the "DISP" button again to revert to zoomed display.

⚠ Trimming in the preview image is not saved.

⚠ The operation procedure is the same as for playback zoom. (→P.35)

Selecting Recorded Images

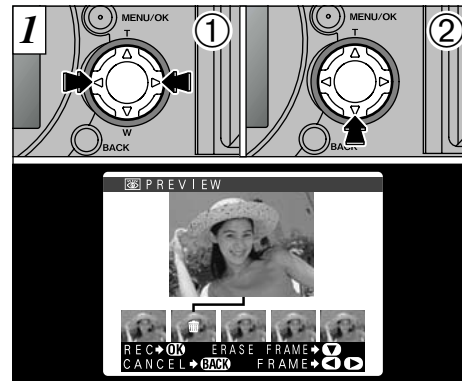

This function allows you to select and record images in the Continuous Shooting and Auto Bracketing modes. However, preview zoom cannot be used.

- ① Use "◀" and "▶" to select the images you do not want to record.
- ② Press "▼" to add or remove the "🗑" Mark.



Place an "🗑" mark under all the images you do not want to record and then press the "MENU/OK" button to record the remaining images.

SET AUTO POWER SAVE SETTING

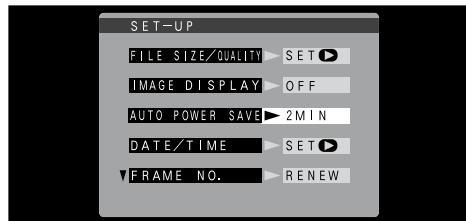

Once you enable this function, the monitor is temporarily switched off to reduce power consumption (Sleep mode) if the camera is not used for about 30 seconds. If the camera is then left unused for a further time (2 or 5 minutes), it is automatically switched off. Use this function when you want to get the maximum possible running time from the battery.

- ! Auto Power Save is disabled during automatic playback and when a USB connection is being used.

The Sleep function does not operate in Playback mode, but the camera is automatically switched off if it is left unused for some time (2 or 5 minutes).

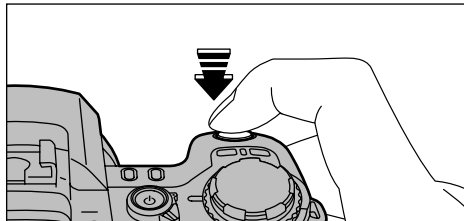

When the camera is in sleep mode, pressing the shutter button down halfway brings the camera back to full operational mode. This is a useful feature as it allows you to take pictures more quickly than switching the camera off and then on again.

- ! Camera operation can also be restored by pressing buttons other than the shutter button.

SET FRAME NO. MEMORY

	<RENEW>	<CONT.>
A	0001 ⋮ 0005	0001 ⋮ 0005
↓		
B	0001 ⋮ 0005	0006 ⋮ 0010

* Formatted SmartMedia used for both A and B.

Setting this function to “CONT.” makes file management easier as it ensures that file names are not duplicated when images are downloaded to a PC.

- RENEW:** Pictures are stored on each SmartMedia beginning with a file number “0001”.
- CONT. :** Pictures are stored beginning from the highest file number stored on the last SmartMedia used.

- ! If the SmartMedia already contains image files with file numbers higher than the highest file number on the last SmartMedia, images are stored beginning from the highest file number on the current SmartMedia.

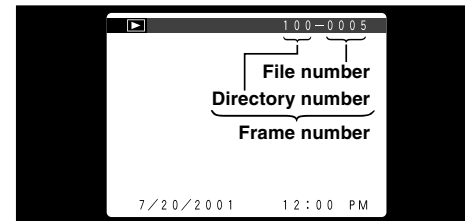

You can check the file number by viewing the image. The last 4 digits of the 7-digit number in the top right corner of the screen are the file numbers, while the first 3 digits show the directory number.

- ! When you change the SmartMedia, always switch the camera off before you open the SmartMedia slot cover. If you open the slot cover without switching the camera off, the frame number memory will not function.
- ! File numbers run from 0001 to 9999. Once 9999 is exceeded, the directory number changes from 100 to 101. The maximum number is 999-9999.
- ! If you switch the Frame No. Memory function off, the highest file number stored by the function is reset.
- ! The displayed frame number may differ for images photographed on other cameras.

ADJUSTING THE MONITOR BRIGHTNESS

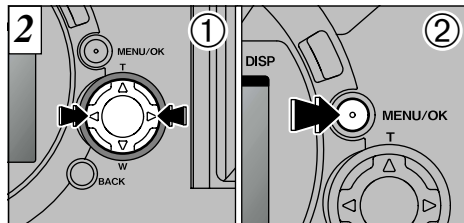
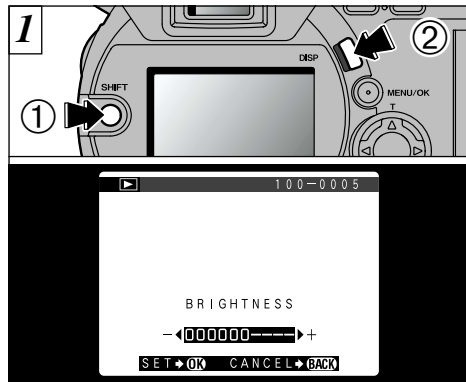

- ① Press “◀” or “▶” to adjust the brightness of the monitor.
- ② Press the “MENU/OK” button to confirm the setting.

① Hold down the “SHIFT” button ② and press the “DISP” button to display the adjustment bar.

● Adjusting the BRIGHTNESS

You can only adjust the brightness when the Mode switch is set to either “” or “”.

The brightness adjustment can be set independently for the LCD viewfinder and the LCD monitor.

! To exit this procedure without changing the settings, press the “BACK” button.

6 PC Connection

IN PC CONNECTION

PC Connection describes how to set up a USB connection and provides an overview of the functions available using a USB connection. Refer to the Software Quick Start Guide booklet for details.

Card Reader function (DSC)

This mode provides a simple way to read images from a SmartMedia and store images onto a SmartMedia. The USB interface connection allows files to be transferred at high speed so that large image files can be moved quickly (⇒P.104).

◆ Viewing Movies on Your Computer ◆

Use of the enclosed FinePixViewer software is recommended.

* If you do not use FinePixViewer, you will need QuickTime version 3.0 or later or DirectX8.0 Runtime (for Windows).

Refer to the Software Quick Start Guide booklet for information on installing the software.

Camera Customization

The following functions can be accessed by downloading and using the special software (⇒P.107).

- Adding Auto Play display methods (⇒P.83)
- Appending copyright information to the Exif information for photographed images.

You must be registered as a FinePix Viewer online user to download the special camera customization software. Refer to the Software Quick Start Guide booklet for details.

You must also have the hardware and software required for connecting to the Internet to register as an online user or download software.

The following functions in the enclosed software are not available on this camera:

- Videoconferencing using PictureHello
- Live image capture using VideoImpression

CONNECTING TO A PERSONAL COMPUTER

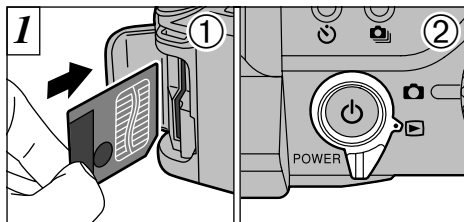

- ① Load a SmartMedia containing photographed images.
- ② Set the Mode dial to "📷".

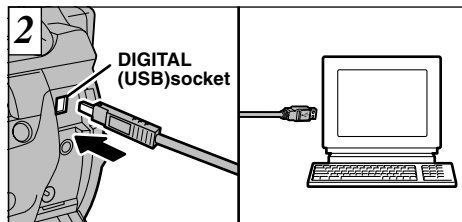

Plug one end of the special USB cable (supplied) into the digital (USB) socket on the camera and then plug the other end into your computer.

Install the software by referring to the Software Quick Start Guide booklet for the installation procedure.

⚠ The AC power adapter should be used for this operation (➡P.18).

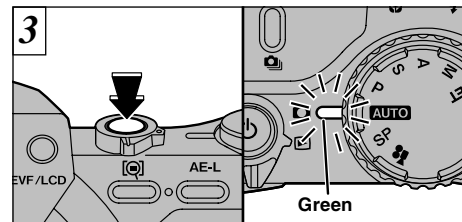

When you switch the camera on, your computer recognizes the camera as a removable disk and the indicator lamp on the camera lights green.

⚠ The Auto Power Save function does not operate when the camera is connected to a computer.

If Windows driver installation has started, refer to the Software Quick Start Guide booklet.

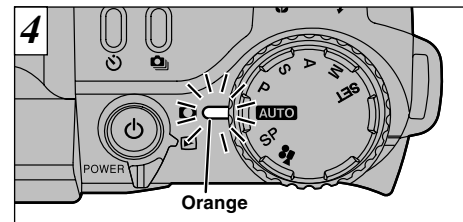

The indicator lamp glows orange when the camera is communicating with the computer. Do not open the SmartMedia slot cover or use any of the other camera controls while the camera is communicating with the computer.

⚠ See P.106 for the procedure for disconnecting the camera from your computer.

Files can be transferred in either direction between the camera and the computer. You can also customize the camera (➡P.107).

DISCONNECTING THE CAMERA FROM YOUR COMPUTER

Always take the following steps before disconnecting the camera from your computer:

- ① Check that the indicator lamp is green (the camera is not exchanging data with the computer).
- ② Select the correct procedure below for the operating system used on your computer. Then proceed to step ③ on the right side of this page.

● Windows 98

Check that the indicator lamp is green.

● Windows Me/2000 Professional

Exit "FinePixViewer". Then click the Eject icon in the taskbar and eject the media. Check that the "REMOVE OK" message is displayed.

● Macintosh

Quit "FinePixViewer". Drag the "Removable Drive" icon to the Trash and check that "REMOVE OK" is displayed on the camera's screen.

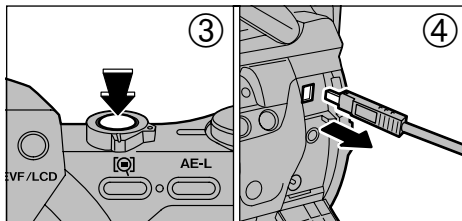

③ Switch the camera off.

④ Disconnect the special USB cable from the camera.

⚠ Do not remove the SmartMedia or disconnect the USB cable without following the removal/disconnection procedure described above.

CAMERA CUSTOMIZING

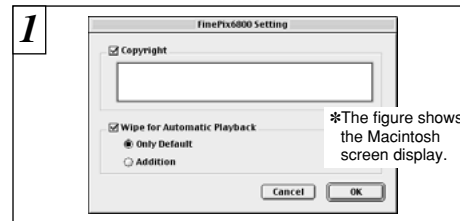

Load a SmartMedia that has available space and connect as a "CARD READER (DSC)". (→P.104)

- ① Use the downloaded "FinePix6900Customizer" software to specify the functions to be added.
- ② Click the "OK" button to write the data to the SmartMedia.

Do not switch the SmartMedia during the customization procedure.

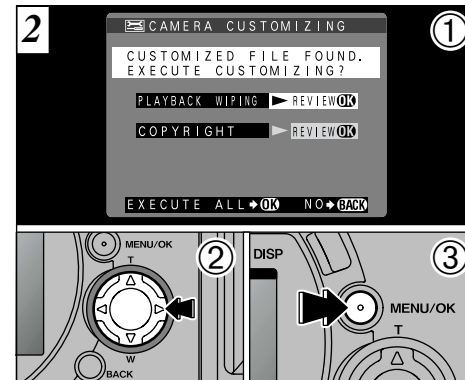

Disconnect the camera from the computer and unplug the special USB cable (→P.106).

- ① When you switch the camera on, the customized screen appears.
- ② Press "▶" to check the details.
- ③ Press the "MENU/OK" button to proceed.

⚠ If you selected "NO", the customized screen appears the next time you switch the camera on.

System Expansion Options

- By using the FinePix6900 ZOOM together with other optional FUJIFILM products, your system can be expanded to fill a wide range of uses.

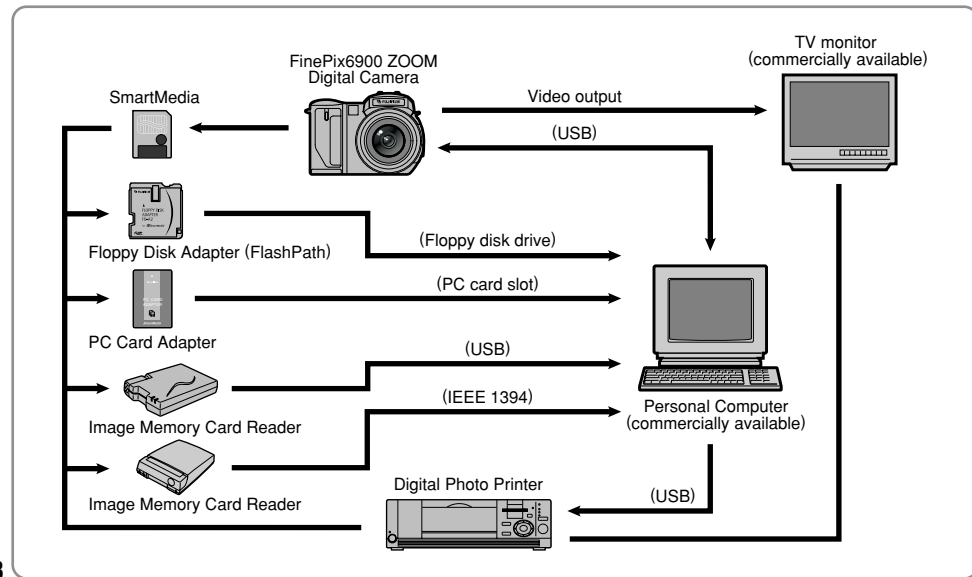

Overview of the Conversion Lens/Adapter Ring

Wide Conversion Lens WL-FX9

This is a set that includes a wide conversion lens and adapter ring and converts the camera's focal length by 0.79 \times (equivalent to a 28 mm wide-angle lens). This set also allows you to use commercially available filters.

•Wide conversion lens specifications

Magnification : 0.79 \times
Lens configuration: 3 lenses in 3 groups
Dimensions : 32 mm \times 70 mm dia.
Weight : Approx. 185 g
Accessories : Adapter Ring (see below for specifications) Lens caps (front and rear) Lens pouch

- ⚠ This lens should be used at the wide-angle zoom setting (equivalent to 28 mm – 46 mm). Using the lens at the telephoto setting increases the amount of distortion.
- ⚠ The wide conversion lens and built-in flash cannot be used together.

The adapter ring is required for using commercially available filters.

•Adapter ring specifications

Compatible filters: 55 mm – diameter commercial filters
Dimensions : 39 mm \times 58 mm dia.
Weight : Approx. 30 g

- ⚠ Do not use more than one filter at a time.

Teleconversion Lens TL-FX9

This accessory increases the focal length of your lens by 1.5 \times without changing its F-stop value.

•Teleconversion lens specifications

Magnification : 1.5 \times
Lens configuration: 3 lenses in 3 groups
Dimensions : 55 mm \times 65 mm dia.
Weight : Approx. 100 g
Accessories : Lens caps (front and back), lens bag

- ⚠ This teleconversion lens should be used with telephoto zoom settings. Using this lens at a wide-angle setting could result in image vignetting.
- ⚠ The built-in flash cannot be used with the teleconversion lens.

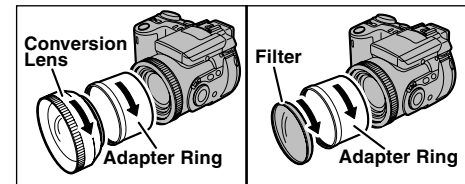

Mount the Adapter Ring, Conversion Lens and commercial filters by screwing them on in the direction of the arrow.

Accessories Guide

►The optional accessories (sold separately) can make taking pictures with the FinePix6900 ZOOM even easier. For information on how to attach and use the accessories, refer to the instructions provided with the accessory used.

● SmartMedia™

These are separately available SmartMedia cards.

Use the following SmartMedia:

- MG-4S: 4MB, 3.3V
 - MG-8S: 8MB, 3.3V
 - MG-16S/SW: 16MB, 3.3V
 - MG-32S/SW: 32MB, 3.3V
 - MG-64S/SW: 64MB, 3.3V
 - MG-128SW: 128MB, 3.3V
- * Some 3.3V SmartMedia are labelled as "3V" or "ID" cards.

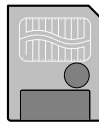

● BC-80 Battery Charger

Use the BC-80 to quickly charge the rechargeable battery.

Battery charging takes roughly 70 minutes (charging an NP-80).

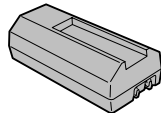

● NP-80 Rechargeable Battery

The NP-80 is a rechargeable lithium-ion battery.

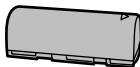

● PC-AD3 PC Card Adapter

The PC Card Adapter allows the SmartMedia to be used as a PC Card Standard ATA-compliant (PCMCIA 2.1) PC card (Type II).

- Compatible with SmartMedia of 5V/3.3V, 2MB to 128MB.



● Floppy Disk Adapter (FlashPath)

This adapter is the same size and shape as a 3.5-inch floppy disk. You can copy the images on a SmartMedia to your PC simply by loading the SmartMedia into the floppy disk adapter and then inserting the adapter into your floppy disk drive.

	Compatible OS	Compatible SmartMedia
FD-A2	Windows 95/98/98SE/Me/NT4.0, MacOS 7.6.1 to 9.1	5V/3.3V, 2MB to 128MB



● SM-R2 Image Memory Card Reader

The SM-R2 allows images to very easily be read to and written from an image memory card (SmartMedia) to a personal computer. Its USB interface provides high-speed data transmission.

- Windows 98/98SE, Windows Me, Windows 2000 Professional or iMac and models that support USB as standard.

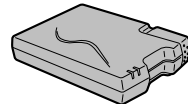

● DM-R1 Image Memory Card Reader

This device provides a simple way to transfer image data in either direction between your computer and an image memory card (SmartMedia or CompactFlash Type II (Microdrive-compatible)).

The IEEE 1394 interface provides high-speed data transfer.

- Windows 98 Second Edition, Windows 2000 Professional (read-only), iMacDV and Power Macintosh computers with FireWire as a standard feature. Mac OS 8.5.1 to 9.0

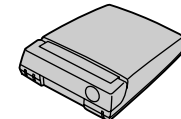

● SC-FX9

This is a special synthetic leather case that protects the camera against soiling, dust and minor impacts when it is being carried.

Explanation of Terms

AF/AE Lock :	On the FinePix6900 ZOOM, pressing the shutter button down half way locks the focus and exposure settings (AF and AE lock). If you want to focus on a subject that is not centered in the frame or change the picture composition after the exposure is set, you can obtain good results by changing the composition after the AF and AE settings are locked.
Auto Power Save Function :	If the camera is not used in any way for 30 seconds, this function switches features such as the LCD monitor off (Sleep mode) to prevent battery depletion and the waste of power when the AC power adapter is connected. If the camera is then left unused for a further period, the Auto Power Save function switches the camera off. This period can be set to 2 minutes or 5 minutes on this camera. <ul style="list-style-type: none">● The Auto Power Off function does not operate in PC mode, during automatic playback, or if it is disabled during setup.
DPOF :	Digital Print Order Format DPOF is a format used for recording information on a storage media (image memory card, etc.) that allows you to specify which of the frames shot using a digital camera are printed and how many prints are made of each image.
EV :	A number that denotes exposure. The EV is determined by the brightness of the subject and sensitivity (speed) of the film or CCD. The number is larger for bright subjects and smaller for dark subjects. As the brightness of the subject changes, a digital camera maintains the amount of light hitting the CCD at a constant level by adjusting the aperture and shutter speed. When the amount of light striking the CCD doubles, the EV increases by 1. Likewise, when the light is halved, the EV decreases by 1.
JPEG :	Joint Photographics Experts Group A file format used for compressing and saving color images. The compression ratio can be selected, but the higher the compression ratio, the poorer the quality of the expanded image.
Motion JPEG :	A type of AVI (Audio Video Interleave) file format that handles images and sound as a single file. Images in the file are recorded in JPEG format. Motion JPEG can be played back by QuickTime 3.0 or later.
PC Card :	A generic term for cards that meet the PC Card Standard.
PC Card Standard :	A standard for PC cards determined by the PCMCIA.
PCMCIA :	Personal Computer Memory Card International Association (US).
White Balance :	Whatever the kind of the light, the human eye adapts to it so that a white object still looks white. On the other hand, devices such as digital cameras see a white subject as white by first adjusting the color balance to suit the color of the ambient light around the subject. This adjustment is called matching the white balance. A function that automatically matches the white balance is called an Automatic White Balance function .

Notes on Using Your Camera Correctly

► Be sure to read this information in conjunction with before you use this product “Safety Notes” (⇒P.127) to ensure that you use your camera correctly.

■ Places to Avoid

Do not store or use the camera in the following types of locations :

- Very humid, dirty or dusty places.
- In direct sunlight or in places subject to extreme temperature rises, such as in a closed car in summer.
- Extremely cold places.
- Places subject to strong vibrations.
- Places affected by smoke or steam.
- Places subject to strong magnetic fields (such as places near motors, transformers or magnets).
- In contact with chemicals such as pesticides or next to rubber or vinyl products for long periods of time.

■ Do not expose the camera to sand

The FinePix6900 ZOOM is particularly and adversely affected by sand. In sandy locations such as beaches or deserts, or in locations where there is wind borne sand, ensure that the camera is not exposed to sand. This can cause faults that may be irreparable.

■ Notes on Condensation

If the camera is carried suddenly from a cold location into a warm place, water droplets (condensation) may form on the inside of the camera or on the lens. When this occurs, switch the camera off and wait an hour before using the camera. Condensation may also form on the SmartMedia card. In this event, remove the SmartMedia and wait a short time before using it again.

■ When the Camera is Unused for Long Periods

If you do not intend to use the camera for a long period of time, remove the batteries and the SmartMedia card before storing the camera.

■ Cleaning Your Camera

- Use a blower brush to remove dust from the lens and LCD surface and then wipe lightly with a soft, dry cloth. If any soiling remains, apply a small amount of lens cleaning liquid to a piece of FUJIFILM lens cleaning paper and wipe gently.
- Do not scratch hard objects against the lens, LCD monitor screen or viewfinder as these surfaces are easily damaged.
- Clean the body of the camera with a soft dry cloth. Do not use volatile substances such as thinners, benzine or insecticide, as these may react with camera body and cause deformation or remove the coating.

■ Using the Camera Overseas

When travelling overseas, do not place your camera in the check-in baggage. Baggage handling at airports may subject baggage to violent shocks, and the camera may be damaged internally even when no external damage is visible.

Notes on the Power Supply

Notes on Using the Battery

The FinePix6900 ZOOM camera uses a rechargeable lithium-ion battery. Note the points below when using the rechargeable battery. Take particular care to read the Safety Notes to ensure that you use the battery correctly.

- *When shipped, the NP-80 is not fully charged. Always charge the battery before using it.

- Always remove the battery cap when using the battery.
- When you are carrying the battery around, load it into the digital camera or attach the cap.
- When storing the battery, store it with the cap fitted.

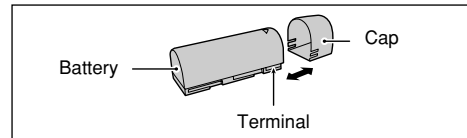

Battery Features

- The battery gradually loses its charge even when not used. Use a battery that has been charged recently (in the last day or two) to take pictures.
 - To maximize the battery life, switch the camera off as quickly as possible when it is not being used.
 - The number of available shots will be lower in cold locations or at low temperatures. Take along a spare fully charged battery.
- You can also increase the amount of power produced by putting the battery in your pocket or another warm

place to heat it and then loading it into the camera just before you take a picture.

If you are using a heating pad, take care not to place the battery directly against the pad. The camera may not operate if you use a depleted battery in cold conditions.

Charging the Battery

- The battery can be charged using the AC-5VS/AC-5VH (provided as an accessory or sold separately) AC Power Adapter supplied with the FinePix6900 ZOOM. The battery takes approximately 5 hours to charge. If you use the BC-80 Battery Charger (sold separately), the battery can be charged in approximately 70 minutes.
- This rechargeable battery does not need to be fully discharged or exhausted flat before being charged.
- The battery may feel warm after it has been charged or immediately after being used. This is perfectly normal.
- The battery can be charged at temperatures between 0°C and +40°C (+32°F and +104°F), but should be charged between +10°C and +30°C (+50°F and +86°F) to obtain maximum battery performance.
- Do not recharge a fully charged battery.

Battery Life

At normal temperatures, this battery can be used at least 300 times.

If the time for which the battery provides power shortens markedly, this indicates that the battery has reached the end of its effective life and should be replaced.

Notes on storage

Lithium ion batteries are both compact and capable of storing large quantities of power. However, if they are stored for long periods while charged, the performance of the battery can be impaired.

- If the battery will not be used for some time, run the battery flat before storing it.
- If the battery is kept in storage for a long period, charge the battery and then run it flat again at least once a year.
- Always remove the battery from the digital camera or battery charger when it is not being used. Left installed, minute amounts of current flow even when unused, and the battery may become excessively drained and no longer function.

- Attach the cap and store in a cool place.

*The battery should be stored in a dry location with an ambient temperature between +15°C and +25°C (+59°F and +77°F).

*Do not leave the battery in hot or extremely cold places.

Handling the Battery

To avoid injury or damage, observe the following:

- Do not allow the metal portions of the battery to touch other metal objects.
- Do not bring the battery close to a flame or throw it into a fire.
- Do not attempt to disassemble or modify the battery.

To avoid damaging the battery or shortening its life, observe the following:

- Do not drop the battery or otherwise subject it to strong impacts.
- Do not immerse the battery in water.

To ensure that you obtain optimum battery performance, observe the following:

- Always keep the battery terminals clean.
- Store the battery in a cool, dry place. Storing the battery for long periods in a hot location can shorten the battery life.

If you use the battery for a long period, the camera body and the battery itself will become warm. This is normal and is not a malfunction. Use the AC power adapter supplied with the camera if you are taking pictures or viewing images for a long period of time.

Specifications (NP-80)

Nominal voltage	DC 3.7V
Maximum voltage	DC 4.2V
Nominal capacity	1300mAh
Operating temperature	0°C to +40°C (+32°F to +104°F)
Dimensions	19.8 mm × 20.4 mm × 55.5 mm (0.78 in. × 0.8 in. × 2.19 in.) (W × H × D)
Mass (Weight)	Approx. 40g (1.4 oz.)

* These specifications are subject to change without notice. 115

Notes on the Power Supply

AC Power Adapter

Always use the AC-5VS/AC-5VH AC Power Adapter with the FinePix6900 ZOOM Camera.

The use of an AC power adapter other than the AC-5VS/AC-5VH could result in damage to your FinePix6900 ZOOM Digital Camera.

- This AC power adapter is designed exclusively for indoor use.
- Plug the connection cord plug securely into the DC input terminal of the FUJIFILM Digital camera.
- Turn off the power switch of the FUJIFILM Digital camera before disconnecting the connection cord from the FUJIFILM Digital camera's DC input terminal. To disconnect, take hold of the plug and pull it out (do not disconnect it by pulling on the cord).
- Do not use this AC power adapter with any device except the specified device.
- During use, this AC power adapter will become hot to touch, but this is normal.
- Do not disassemble the AC power adapter. Doing so could be dangerous.
- Do not use this device in a place with high temperature and high humidity.
- Do not drop or subject this device to strong shocks.
- This device may emit a humming noise, but this is normal.
- If used near a radio, this device may cause static, so play the radio in a distant place.

*Very occasionally, DC output will be prevented by the operation of the internal protection circuit. In this event, unplug the AC-5VS/AC-5VH from the power socket for a few moments and then plug it in again. This will restore DC output.

■ Specifications (AC-5VS/AC-5VH)

Power Supply	AC 100V to 240V, 50/60Hz
Rated Input Capacity	12W (U.S.A. and Canada) 0.15A to 0.24A (other countries)
Rated Output	DC 5.0V 1.5A (U.S.A. and Canada) DC 5.0V 2.0A (other countries)
Temperature During Use	0°C to +40°C (+32°F to +104°F) (U.S.A. and Canada) 0°C to +45°C (other countries)
Storage Temperature	-10°C to +70°C (+14°F to +158°F)
Dimensions (MAX.)	47 mm × 20 mm × 72 mm (1.9 in. × 0.8 in. × 2.8 in.) (W × H × D) (U.S.A. and Canada) 49 mm × 40 mm × 65 mm (W × H × D) (U.K.) 49 mm × 31 mm × 65 mm (W × H × D) (other countries)
Mass (Weight)	Approx. 120 g (4.2 oz.) (U.S.A. and Canada) Approx. 200 g (U.K.) Approx. 180 g (other countries)
Connection Cord Length	Approx. 2 m (6.6 ft.)

*Please note that specifications and characteristics are subject to change without notice.

Notes on the SmartMedia™

■ SmartMedia

The SmartMedia card supplied with your FinePix6900 ZOOM camera is a new image recording medium developed especially for use in digital cameras. Each SmartMedia card contains a built-in semiconductor memory chip (NAND flash memory) which is used for storing digital image data.

Because the data is stored electronically, the stored image data can be erased from the card and new data recorded.

■ SmartMedia with IDs

The SmartMedia ID is a SmartMedia that has an individually assigned identification number. SmartMedia ID cards can be used with devices that use ID numbers for copyright protection or other purposes. This camera accepts SmartMedia ID cards in the same way as conventional SmartMedia cards.

■ Storing Data

In the situations listed below, recorded data may be erased (destroyed). Please note that Fuji Photo Film Co., Ltd. accepts no responsibility whatsoever for the loss (destruction) of recorded data.

- *When the SmartMedia is used incorrectly by the owner or a third party
- *When the SmartMedia is exposed to static electricity or electrical noise

*When the SmartMedia cover is opened or the SmartMedia removed, or when the camera is switched off during data recording, during data erasing (SmartMedia formatting) or during frame advance when images are being played back.

**Back up important data onto another medium.
(MO disk, floppy disk, hard disk, etc.)**

■ Notes on Handling SmartMedia

- When inserting the card into the camera, hold the SmartMedia straight as you push it in.
- Never remove the SmartMedia or switch the camera off during data recording, during data erasing (SmartMedia formatting) or during frame advance when images are being played back. These actions could result in damage to the SmartMedia.
- Use only the SmartMedia specified for use with the FinePix6900 ZOOM. The use of other SmartMedia could damage the camera.
- SmartMedia are precision electronic devices. Do not bend, drop, or subject SmartMedia to excessive shocks.
- Do not use or store SmartMedia in environments likely to be affected by strong static electricity or electrical noise.

- Do not use or store SmartMedia in very hot, humid or corrosive environments.
- Take care not to touch the SmartMedia's contact area or allow the area to become soiled. Use a dry lint-free cloth to wipe away any soiling that does occur.
- To avoid damage caused by static electricity, always use the special static-free case provided during transportation or storage, or keep the SmartMedia in a storage case if available.
- Do not carry SmartMedia in locations such as a trouser pocket. This could subject the SmartMedia to excessive force when you sit down, thereby damaging the SmartMedia.
- The SmartMedia may feel warm when it is removed from the camera after extended periods of picture taking or image viewing. This is normal and does not indicate a fault.
- Inserting a SmartMedia that is charged with static electricity into your camera may result in a camera malfunction. If this occurs, switch the camera off and then on again.
- Affix the label onto the designated area of the card. Do not use third-party labels as this can lead to problems when the card is inserted or removed.
- When you attach the label, take care that it does not cover any of the write-protect area.







■ Notes on Using SmartMedia with a PC

- If you intend to take photos using a SmartMedia that has been used on a PC, format the SmartMedia on your camera.
- When you format a SmartMedia in the camera and then shoot and record images, a directory (folder) is automatically created. Image data is then recorded in this directory.
- Do not change or delete the directory (folder) names or file names on the SmartMedia from your PC as this will make it impossible to use the SmartMedia in your camera.
- Always use the camera to erase image data on a SmartMedia.
- To edit image data, copy the image data to the computer's hard disk and then edit the copied data.

■ Specifications

Type	Image memory card for digital cameras (SmartMedia)
Operating voltage	3.3V
Operating conditions	Temperature : 0°C to +40°C (+32°F to +104°F) Humidity : 80% or less (condensation free)
Dimensions	37 mm × 45 mm × 0.76 mm (1.45 in. × 1.77 in. × 0.03 in.) (W × H × D)

► The table below lists the warnings that are displayed on the LCD monitor

Warning Displayed	Explanation	Remedy
 (Lit red)	The camera battery is low on charge.	Replace or recharge the battery.
	No SmartMedia is loaded, or it is loaded incorrectly.	Load the SmartMedia (3.3V) in the correct direction.
	<ul style="list-style-type: none">• The SmartMedia is not formatted.• The SmartMedia terminals are soiled.	<ul style="list-style-type: none">• Format the SmartMedia.• Wipe the contact area on the SmartMedia with a soft dry cloth.
	<ul style="list-style-type: none">• The SmartMedia terminals are soiled.• The SmartMedia is damaged.• The SmartMedia format is incorrect.	Wipe the contact area on the SmartMedia with a soft dry cloth. It may be necessary to format the SmartMedia. If the error message is still displayed, replace the SmartMedia.
	The SmartMedia is fully recorded.	Erase some images or use a SmartMedia that has ample free space.
	The SmartMedia is write-protected.	Use a SmartMedia that is not write-protected.
	<ul style="list-style-type: none">• An attempt was made to playback a frame not recorded on this camera.• The SmartMedia terminals are soiled.	<ul style="list-style-type: none">• Images cannot be played back.• Wipe the contact area on the SmartMedia with a soft dry cloth. In some cases, you may have to format the SmartMedia.

Warning Displays

Warning Displayed	Explanation	Remedy
! WRITE ERROR	<ul style="list-style-type: none"> The data could not be recorded due to a SmartMedia error or a connection error between the SmartMedia and camera. The photographed image cannot be recorded as it is too large to fit in the available space on the SmartMedia. 	<ul style="list-style-type: none"> Re-insert the SmartMedia or switch the camera off and then on again. Use a new SmartMedia.
! FILE NO. FULL	The frame number has reached 999-9999.	Switch the Frame NO. Memory function off and use a formatted SmartMedia to take the picture.
	There is a strong likelihood of camera shake because the shutter speed is slow.	Use flash photography. However, a tripod should be used for some scenes and modes.
! PROTECTED FRAME	A protected frame was erased.	Remove the protection.
! AF	The AF (auto focus) cannot work effectively.	<ul style="list-style-type: none"> If the image is too dark, take the picture at a distance of around 2 m (6.6 ft.) from the subject. Use AF lock to take the picture.
Aperture/Shutter speed display (Lit red)	Outside the AE continuous range.	The shot can be taken, but the exposure will not be correct.
! DPOF SPECIFIED. ERASE OK? ! DPOF SPECIFIED. ERASE ALL OK?	There is a print order specified for image you attempted to erase.	When you erase the image, the DPOF settings for that image are deleted at the same time.

Warning Displayed	Explanation	Remedy
! RESET UNMATCHED DPOF OK?	The DPOF file contains an error. Alternatively, the DPOF file was set up on a different device.	Press the MENU/OK button to create a new DPOF file and specify all the DPOF settings again.
! DPOF FILE ERROR	Prints were specified for more than 1000 frames in the DPOF frame settings.	The maximum number of frames for which prints can be specified on the same SmartMedia is 999. Print specifications can be set for a maximum of 999 frames on the same SmartMedia.
! ZOOM ERROR ! FOCUS ERROR	Camera malfunction or fault.	<ul style="list-style-type: none"> Switch the camera on again, taking care not to touch the lens. Turn the camera off and on again a few times. If this does not resolve the problem, contact an authorized FUJIFILM service center.

Troubleshooting

► If you think the camera is faulty, check the following once more.

Problem	Cause	Remedy
No power.	<ul style="list-style-type: none"> The battery is exhausted. The AC power adapter plug has come out of the power outlet. 	<ul style="list-style-type: none"> Load a new fully charged battery. Plug the adapter back in.
Power cuts out during operation.	<ul style="list-style-type: none"> The battery is exhausted. 	<ul style="list-style-type: none"> Load a new fully charged battery.
Battery runs out quickly.	<ul style="list-style-type: none"> Camera is being used in extremely cold conditions. The terminals are soiled. The battery is flat. 	<ul style="list-style-type: none"> Put the battery in your pocket or another warm place to heat it and then load it into the camera just before you take a picture. Wipe the battery terminals with a clean, dry cloth. Load a new battery.
No photograph is taken when the shutter button is pressed.	<ul style="list-style-type: none"> No SmartMedia is loaded. The SmartMedia is fully recorded. The SmartMedia is write-protected. The SmartMedia is not formatted. The SmartMedia contact area is soiled. The SmartMedia is damaged. The Auto Power Save function has switched the camera off. The battery is exhausted. 	<ul style="list-style-type: none"> Load a SmartMedia. Load a new SmartMedia or erase a frame. Remove the write-protection. Format the SmartMedia. Wipe the SmartMedia contact area with a clean dry cloth. Load a new SmartMedia. Switch the camera on. Load a new fully charged battery.

Problem	Cause	Remedy
Can't use the flash to take pictures.	<ul style="list-style-type: none"> The flash is set to Suppressed Flash mode (The flash is closed). The shutter button was pressed while the flash was charging. 	<ul style="list-style-type: none"> Pop the flash up. (The flash cannot be used in some modes (⇒P.41). Select a mode in which the flash can be used.) Wait until charging is completed before pressing the shutter button.
The flash will not charge.	<ul style="list-style-type: none"> No compatible SmartMedia is loaded. The camera is set to Suppressed Flash mode. The battery is exhausted. 	<ul style="list-style-type: none"> Load a new SmartMedia, erase a frame, or remove the write-protection. Set the flash to Auto, Red-Eye Reduction or Forced Flash mode. Load a new fully charged battery.
The playback image is too dark even though I used the flash.	<ul style="list-style-type: none"> The subject is too far away. The flash was covered by your finger. 	<ul style="list-style-type: none"> Move closer to the subject. Hold the camera correctly.
The image is blurred.	<ul style="list-style-type: none"> The lens is dirty The lens is zoomed to telephoto in Macro mode. The photographed subject was too dark. 	<ul style="list-style-type: none"> Clean the lens. Cancel Macro mode. Try standing about 2 m (6.6 ft.) from your subject to take the picture.
There are dot-shaped aberrations on the image.	<ul style="list-style-type: none"> The shot was taken with a shutter speed slower than 1/4 second. 	<ul style="list-style-type: none"> This is characteristic of CCDs and does not indicate a fault.
Can't format the SmartMedia.	<ul style="list-style-type: none"> The SmartMedia is write-protected. 	<ul style="list-style-type: none"> Remove the write-protection. (Peel off the write-protect sticker.)

Troubleshooting

Problem	Cause	Remedy
The ERASE ALL function does not erase all the frames.	• The frame is protected.	• Remove the frame protection.
Nothing happens when I use the camera switches and dial.	• Camera malfunction. • The Mode switch and Mode dial has been moved to another setting. • The battery is exhausted.	• Remove the battery, re-insert and try again. • Set the Mode switch and Mode dial to the correct setting. • Load a new fully charged battery.
There is no picture on the TV.	• The camera and TV are connected incorrectly. • The TV input is set to “TV”.	• Connect the TV and camera correctly. • Set the TV input to “Video”.

Specifications

System

- **Model:** Digital camera FinePix6900 ZOOM
- **CCD sensor**
1/1.7-inch Super CCD (with primary color filter)
The total number of pixels: 3.3 million in an interwoven pattern. The number of effective pixels: 3.015 million.
- **Image file Size**
2832 × 2128 pixels / 2048 × 1536 pixels / 1280 × 960 pixels / 640 × 480 pixels
- **File format**
Still image: JPEG (DCF-compliant) or TIFF-RGB, DPOF-compatible
Movie : AVI format, Motion JPEG
- **Storage media:** SmartMedia (3.3V)
- **Viewfinder**
0.55-inch 110,000 pixel electronic viewfinder
- **Lens:** Super EBC Fujinon optical 6× zoom lens
Aperture: F2.8 to F11, 13 levels in 1/3 EV steps
Focus : TTL contrast-type, Auto or Manual

Number of frames recorded

File Size	6M 2832 × 2128				3M 2048 × 1536		1M 1280 × 960		VGA 640 × 480	Movie
Quality Mode	HI	FINE	NORMAL	BASIC	FINE	NORMAL	FINE	NORMAL	NORMAL	—
Image Data Size	Approx. 17720KB	Approx. 2400KB	Approx. 1200KB	Approx. 460KB	Approx. 1300KB	Approx. 590KB	Approx. 620KB	Approx. 320KB	Approx. 90KB	—
MG-4S (4MB)	0	1	3	8	2	6	6	12	44	Approx. 23 sec.
MG-8S (8MB)	0	3	6	17	6	13	12	25	89	Approx. 47 sec.
MG-16S/SW (16MB)	0	6	13	33	12	26	25	49	163	Approx. 94 sec.
MG-32S/SW (32MB)	1	13	28	68	25	53	50	99	330	Approx. 191 sec.
MG-64S/SW (64MB)	3	26	56	137	50	107	101	198	663	Approx. 385 sec.
MG-128SW (128MB)	7	53	113	275	102	215	204	398	1330	Approx. 774 sec.

- **Focus distance**
Normal: f = 7.8 mm – 46.8 mm (equivalent to 35 mm – 210 mm on a 35 mm camera)
Macro : f = 7.8 mm – 17.8 mm (equivalent to 35 mm – 80 mm on a 35 mm camera)
- **Exposure control:** 64 zones TTL metering, Program AE (AUTO • SP • P • S • A), Manual
- **Sensitivity:** Equivalent to ISO 100/200/400
- **White balance**
AUTO, SP: Fully automatic
P, S, A, M: 8 positions selectable.
Custom white balance selectable (2 positions)
- **Focal range**
Normal-Wide: Approx. 50 cm (1.6 ft.) to infinity
Normal-Tele : Approx. 90 cm (3.0 ft.) to infinity
Macro : Approx. 10 cm (0.3 ft.) to 80 cm (2.6 ft.)
- **Shutter**
AUTO • SP: Variable-speed, 3 to 1/2000 sec. (using AE)
P • S • A • M: Variable-speed, 3 to 1/1000 sec. (using AE)

Specifications

- **Flash:** Auto flash using flash control sensor
Effective range: Wide Approx. 0.3 m – 3.6 m (1 ft. – 11.8 ft.)
Tele Approx. 0.9 m – 3.2 m (3 ft. – 10.5 ft.)
Flash modes : Auto, Red-Eye Reduction,
Forced Flash, Slow Synchro,
Red-Eye Reduction + Slow Synchro

- **LCD monitor**
2-inch, low-temperature polysilicon TFT 130,000 pixels
- **Video output**
NTSC (US/Canada model) / PAL (Europe model)
- **Self-Timer:** 2 sec. / 10 sec. timer clock

Input/Output Terminals

- **Video Output:** Stereo mini- jack (1)
- **Digital (USB) terminal**
For file transfer with a personal computer
- **DC Input:** Socket for specified AC power adapter
- **Accessory shoe:** Hot shoe

Power Supply and Others

- **Power supply**
Use one of the following
 - Rechargeable Battery NP-80 or AC Power Adapter AC-5VS/AC-5VH
- **Number of available shots using the battery (when fully charged)**

Battery Type		No. of Shots	Auto Play
NP-80	Using LCD monitor	Approx. 100	Approx. 1h
	Using LCD viewfinder	Approx. 120	Approx. 1h

The number of shots shown here is an approximate guide to the number of consecutive shots that can be taken based on 50% flash usage at normal temperatures. However, the actual number of available shots will vary depending on the ambient temperature when the camera is used and the amount of charge in the battery. The number of available shots or available shooting time will be lower in cold conditions.

- **Conditions for use**
Temperature: 0°C to +40°C (+32°F to +104°F)
80% humidity or less (no condensation)
- **Camera dimensions (W/H/D)**
110 mm × 78.5 mm × 93.5 mm / 4.3 in. × 3.1 in. × 3.7 in.
(not including accessories and attachments)
- **Camera mass (weight):** Approx. 410g / 14.5oz.
(not including accessories, batteries or SmartMedia)
- **Weight for photography:** Approx. 450g / 18.9oz.
(including batteries and SmartMedia)
- **Accessories:** See P.7
- **Optional Accessories:** See P.108 – 111

- * These specifications are subject to change without notice. FUJIFILM shall not be held liable for damages resulting from errors in this Owner's Manual.
- * The LCD monitor on your digital camera is manufactured using advanced high-precision technology. Even so, small bright points and anomalous colors (particularly around text) may appear on the monitor. These are normal display characteristics and do not indicate a fault with the monitor. This phenomenon will not appear on the recorded image.
- * The operation error may be caused in a digital camera by the strong radio interference (i. e. electric fields, static electricity, line noise, etc.).

Safety Notes

- To ensure that you use your FinePix6900 ZOOM camera correctly, read these Safety Notes and your Owner's Manual carefully beforehand.
- After reading these Safety Notes, store them in a safe place.

About the Icons

The icons shown below are used in this document to indicate the severity of the injury or damage that can result if the information indicated by the icon is ignored and the product is used incorrectly as a result.



WARNING

This icon indicates that death or serious injury can result if the information is ignored.



CAUTION

This icon indicates that personal injury or material damage can result if the information is ignored.

The icons shown below are used to indicate the nature of the information which is to be observed.



Triangular icons notify the user of information requiring attention ("Important").



Circular icons with a diagonal bar notify the user that the action indicated is prohibited ("Prohibited").



Filled circles with an exclamation mark notify the user of an action that must be performed ("Required").



WARNING

If a problem arises, switch the camera off, remove the battery, disconnect and unplug the AC power adapter.

Continued use of the camera when it is emitting smoke, is emitting any unusual odor, or is in any other abnormal state can cause a fire or electric shock.

- Contact your FUJIFILM dealer.



Unplug from power socket.

Do not allow water or foreign objects to enter the camera.

If water or foreign objects get inside the camera, switch the camera off, remove the battery and disconnect and unplug the AC power adapter.

Continued use of the camera can cause a fire or electric shock.

- Contact your FUJIFILM dealer.



Do not place the camera on an unstable surface.

This can cause the camera to fall or tip over and cause injury.



Safety Notes

WARNING

Never attempt to modify or disassemble the camera. (Never open the casing.)

Do not use the camera when it has been dropped or the casing is damaged.

This can cause a fire or electric shock.

● Contact your FUJIFILM dealer.



Do not disassemble.

Do not use the camera in the bathroom or shower.

This can cause a fire or electric shock.



Do not use in the bathroom or shower.

Never attempt to take pictures while in motion.

Do not use the camera while you are walking or operating a moving car or other vehicle.

This can result in you falling down or being involved in a traffic accident.



Do not touch any metal parts of the camera during a thunderstorm.

This can cause an electric shock due to induced current from the lightning discharge.



WARNING

Do not modify, heat or unduly twist or pull the connection cord and do not place heavy objects on the connection cord.

These actions could damage the cord and cause a fire or electric shock.

● If the cord is damaged, contact your FUJIFILM dealer.



Do not use the batteries except as specified.

Load the batteries with the poles positioned as indicated by the ⊕ and ⊖ marks.



Do not heat, modify or attempt to disassemble the batteries.

Do not drop or subject the batteries to impacts.

Do not attempt to recharge lithium or alkaline batteries.

Do not store the batteries with metallic products.

Do not use chargers other than the specified model to charge the battery.

Any of these actions can cause the batteries to burst or leak and cause fire or injury as a result.



WARNING

Use only the batteries or AC power adapter specified for use with this camera.

Do not use voltages other than the power supply voltage shown.

The use of other power sources can cause a fire.



CAUTION

Do not use this camera in locations severely affected by oil fumes, steam, humidity or dust.

This can cause a fire or electric shock.



Do not leave this camera in places subject to extremely high temperatures.

Do not leave the camera in locations such as a sealed vehicle or in direct sunlight.

This can cause a fire.



Keep out of the reach of small children.

This product could cause injury in the hands of a child.











Do not place heavy objects on the camera.

This can cause the heavy object to tip over or fall and cause injury.



Safety Notes

 CAUTION	
Do not move the camera while the AC power adapter is still connected. Do not pull on the connection cord to disconnect the AC power adapter.	
This can damage the power cord or cables and cause a fire or electric shock.	
Do not cover or wrap the camera or the AC power adapter in a cloth or quilt.	
This can cause heat to build up and distort the casing or cause a fire.	
When you are cleaning the camera or you do not plan to use the camera for an extended period, remove the battery and disconnect and unplug the AC power adapter.	
Failure to do so can cause a fire or electric shock.	
Using a flash too close to a person's eyes may temporarily affect the eyesight.	
Take particular care when photographing infants and young children.	

 CAUTION	
Do not use the AC power adapter when the plug is damaged or the plug socket connection is loose.	
This could cause a fire or electric shock.	
Request regular internal testing and cleaning for your camera.	
Build-ups of dust in your camera can cause a fire or electric shock. ● Contact your FUJIFILM dealer to request internal cleaning every 2 years.	

EC Declaration of Conformity

We

Name :

Fuji Photo Film (Europe) G.m.b.H.

Address :

Heesenstrasse 31
40549 Dusseldorf, Germany

declare that the product

Product Name :

FUJIFILM DIGITAL CAMERA FinePix6900 ZOOM

Manufacture's Name :

Fuji Photo Film Co., Ltd.

Manufacture's Address :

26-30, Nishiazabu 2-chome, Minato-ku,
Tokyo 106-8620, Japan

is in conformity with the following Standards

Safety : EN60065

EMC : EN55022 : 1998 Classe B

EN55024 : 1998

EN61000-3-2 : 1995 + A1:1998 + A2:1998

following the provision of the EMC Directive (89/336/EEC, 92/31/EEC and 93/68/EEC) and Low Voltage Directive (73/23/EEC).

CE

Dusseldorf, Germany

Place

May 1, 2001

Date



Signature/Managing Director



Bij dit produkt zijn batterijen geleverd. Wanneer deze leeg zijn, moet u ze niet weggooien maar inleveren als KCA



FUJI PHOTO FILM CO., LTD.

26-30, Nishiazabu 2-chome, Minato-ku, Tokyo 106-8620, Japan

Printed in Japan

Printed on recycled paper.

FGS-103104-FG